



Knightsbridge, SW1X

£3,400 Per week

Dexters



Knightsbridge, SW1X

This first floor apartment is presented to a high standard throughout and is located within a prestigious building with porter services, overlooking Hyde Park.

In addition to its central location, this recently refurbished apartment offers generous reception space suitable for both everyday living and entertaining. The property enjoys views across Hyde Park and benefits from 24-hour porter and concierge services. Finished to a high standard throughout, it features a bright, neutral interior, wooden flooring, air conditioning, a newly fitted kitchen with quality appliances, and flexible three or four bedroom accommodation combining comfort and practicality.

The apartment is located in the heart of Knightsbridge, one of London's most highly regarded areas, within walking distance of Harrods, Harvey Nichols, and a wide selection of restaurants, cafés, and museums. It is also well connected by public transport, with convenient access to London's main airports and railway stations.

Features

- Four Double Bedrooms
- 24-hour Porter
- Private Balcony
- Newly Refurbished
- Overlooking Hyde Park
- Air Conditioning







Knightsbridge, London, SW1X

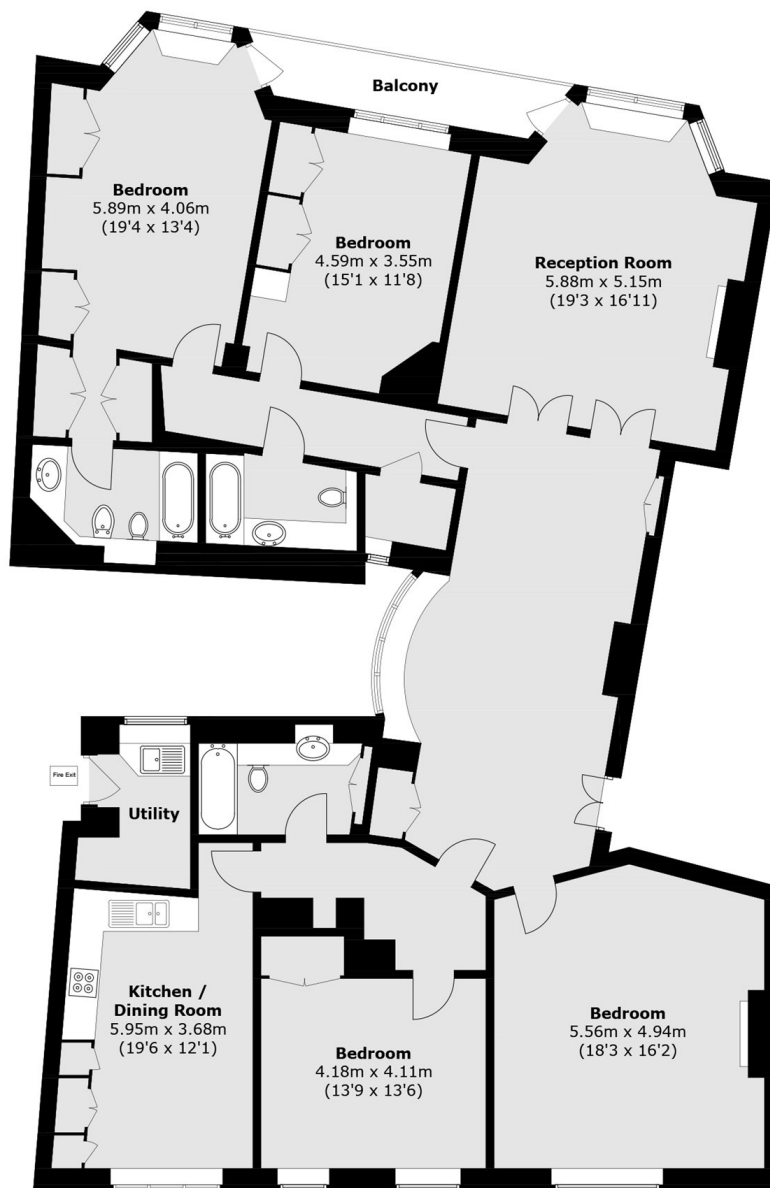

Total area (approx.): 202.5 sq. m (2,179.7 sq. ft)
Balcony area : 5.8 sq. m (62.4 sq. ft)