

abbotFox



Briggs Mead, Wymondham  
*£1,250 PCM*

“

We are a team of genuine individuals who hold a deep passion for both property and marketing. Collectively, we bring over 70 years of experience in the property market of Norfolk and Suffolk. Our affection for both counties runs deep, and we are enthusiastic about sharing our passion with you.

Colin McKenzie | **Branch Partner**







## THE DETAIL \_\_\_\_\_

abbotFox presents this stylish new build property located on the south side of Norwich. Having been built to a very high standard, this home offers three double bedrooms, two off-road parking spaces and spacious living accommodation. Situated within the desirable residential area of Wymondham, this home is an ideal opportunity for any family. Occupying a generous plot, with a high degree of privacy to the rear, this home also benefits from an enclosed rear garden and would be perfect for a family. Presented to an exceptional standard throughout, this home demands an internal viewing to be appreciated.







## THE HIGHLIGHTS \_\_\_\_\_

- Available June
- Three bedrooms
- Three storey
- Open plan kitchen/living area
- Off road parking
- Enclosed rear garden

GROUND FLOOR  
25.0 sq.m. (269 sq.ft.) approx.

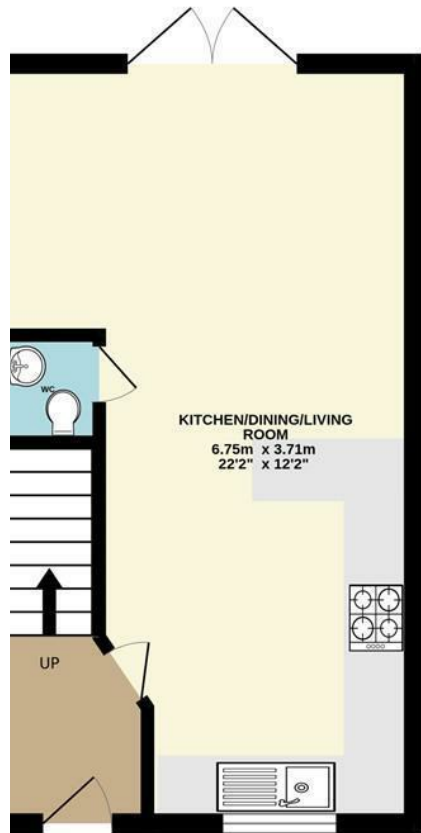

1ST FLOOR  
24.5 sq.m. (263 sq.ft.) approx.

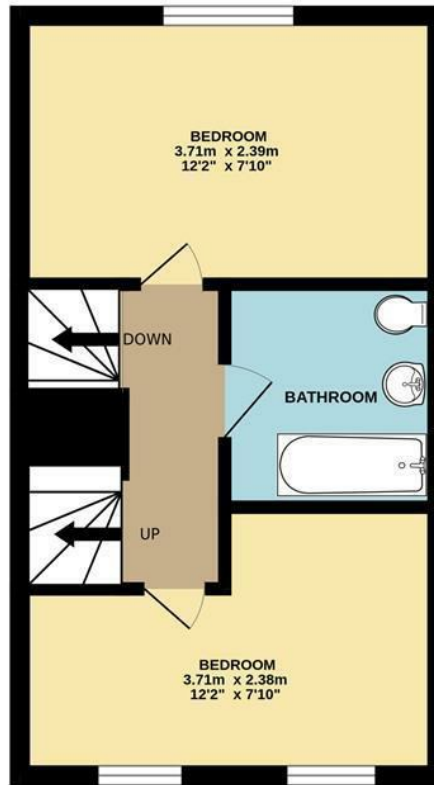

2ND FLOOR  
25.0 sq.m. (269 sq.ft.) approx.

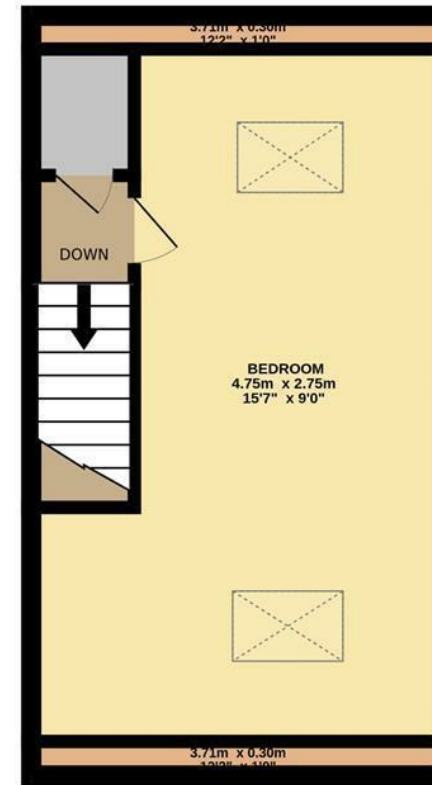

TOTAL FLOOR AREA : 74.5 sq.m. (802 sq.ft.) approx.

Whilst every attempt has been made to ensure the accuracy of the floorplan contained here, measurements of doors, windows, rooms and any other items are approximate and no responsibility is taken for any error, omission or mis-statement. This plan is for illustrative purposes only and should be used as such by any prospective purchaser. The services, systems and appliances shown have not been tested and no guarantee as to their operability or efficiency can be given.  
Made with Metropix ©2022

Let's talk

01603 660000

sales@abbotfox.co.uk

@abbotfox

EPC RATING -

Disclaimer – In accordance with the Property Misdescriptions Act, the company abbotFox gives notice that all descriptions, references to condition, necessary permissions for use and other details are given in good faith and believed to be correct, but any purchaser should not rely on them as statements of fact, and must satisfy themselves by inspection or other means, as to their accuracy.