







Bloomsbury Way
Camberley, GU17 9JG
£300,000

Property Details

-  2 bedrooms
-  1 bathroom and a cloakroom
-  EPC Rating TBC
-  619 square foot
-  Blackwater Station 0.8 miles
- NO CHAIN
- Kitchen and bathroom needing updating
- Spacious living room
- Nicely tucked away on the popular Hawley Hill development
- Convenient for Blackwater and local shops, amenities and railway station
- Council tax band C
- Excellent road links close by
- Beautiful countryside nearby at Hawley

Brought to the market with no onward chain complications this two bedroom end terrace back to back home with a front garden located on the sought after Hawley hill development, is ideally positioned for Hawley Woods and convenient for Blackwater local shops, amenities and railway station. It is also within easy reach of Camberley town centre and also excellent road links to the M3 motorway. The property would suit someone looking to put their own stamp on it as some modernisation is required. Properties like this with scope for improvement on Hawley Hill are seldom available so an early viewing is highly recommended.



Property Details

Bloomsbury Way

Approximate Gross Internal Area = 57.5 sq m / 619 sq ft

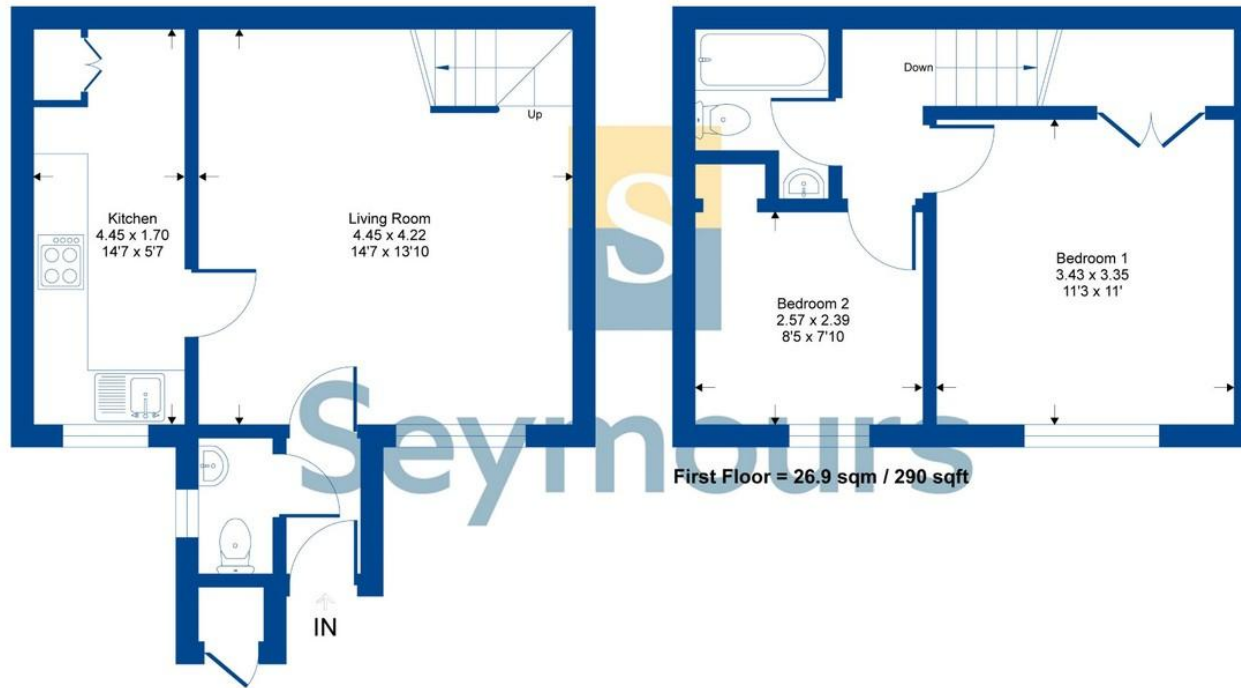

Whilst every attempt has been made to ensure the accuracy of the floor plan contained here, measurements of doors, windows, rooms and any other items are approximate and no responsibility is taken for any error, omission or mis-statement. This plan is for illustrative purposes only and should be used as such by any prospective purchaser.

Seymours Blackwater Office 6 Kings Parade, 34 London Road, Blackwater, Camberley, Surrey, GU17 9AA
01276 534100 / james@seymours-blackwater.co.uk / seymours-estates.co.uk

The information contained in these Sales Particulars does not form part of any contract neither is any warranty given or implied by Seymours or their clients as to the accuracy of measurements of details stated. Every effort is made to ensure that our Sales Particulars are correct and reliable. We do not test service, systems and appliances and we are unable to verify they are in working order.