





22 Pound Lane, Shaftesbury, Dorset, SP7 8RZ

What 3 Words: ///printers.others.bulldozer



Key Features

- No Forward Chain
- Two Double Bedrooms
- Sitting/Dining Room Opening Onto The Rear Garden
- Allocated Parking
- Close To Amenities
- EPC: D

Tenure: Freehold | EPC Rating: D | Council Tax Band: B |

Services: All mains services are connected

Location

Shaftesbury is famed for the iconic cobbled street of Gold Hill and rich history going back to the times of King Alfred. Shaftesbury is a delightful community orientated town with an attractive and bustling High Street that provides most everyday requirements including a farmer's market, cafés, charity shops, various retail shops and a cottage hospital.

Families are drawn to this area by the quality of life and excellent choice of state and independent schools including Port Regis, Clayesmore, Sandroyd, Bryanston, and St Mary's amongst many others.

Inside the Home

The accommodation comprises a kitchen with three sides of useful work surface and storage cupboards before leading through to the sitting/dining room. Here, there is ample space for all typical living furniture whilst the double doors lead onto the garden allowing for plentiful natural light.

Upstairs boasts two double bedrooms, including the principal bedrooms with built-in wardrobes, as well as the family bathroom that offers a shower over bath unit.

Outside Space

Front: Adjacent to the property is a private driveway for multiple vehicles, as well as a storage shed.

Rear: The rear garden is a pleasant, blank canvas that comprises a patio and lawn.

Shall We Book You in For a Viewing?

Strictly by appointment only via Boatwrights Estate Agents.

12 High Street, Shaftesbury, Dorset, SP7 8JG | 01747 213106

High Street, Tisbury, Wiltshire, SP3 6LD | 01747 859359

sales@boatwrights.co.uk | www.boatwrights.co.uk

Scan to
read more
on the
property

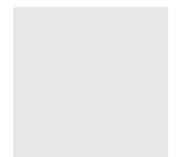

GROUND FLOOR

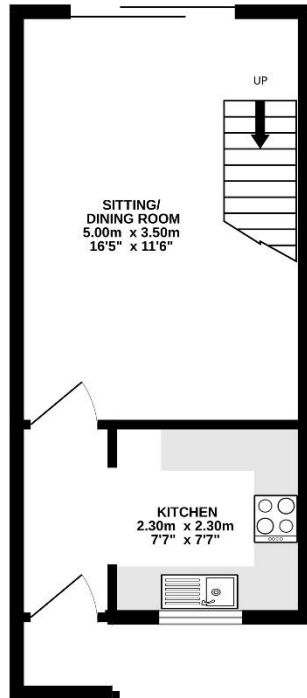

1ST FLOOR

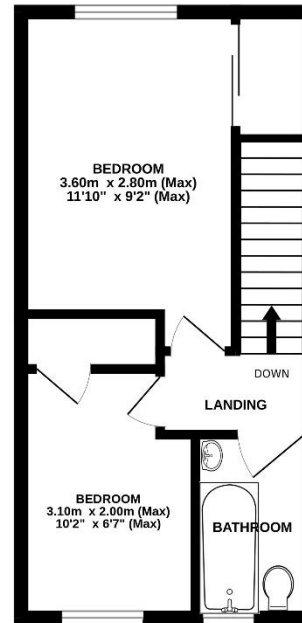

Looking to buy or sell in North Dorset?

At Boatwrights Estate Agents, selling your home starts with trust. As your local, independent experts, we understand the value of your property and your time. Our dedicated team offers tailored marketing, expert guidance, and a personal touch to help you achieve the best possible result.

Scan here to Learn more On Boatwrights?



Whilst every attempt has been made to ensure the accuracy of the floorplans contained herein, measurements of doors, windows, rooms and any other items are approximate and no responsibility is taken for any error, omission or mis-statement. This plan is for illustrative purposes only and should be used as such by any prospective purchaser. The services, systems and appliances shown have not been tested and no guarantee as to their operability or efficiency can be given.
Made with Metropix (2020)

Important Notice

These particulars do not constitute or form part of an offer or contract, nor may they be regarded as representations. All interested parties must themselves verify their accuracy. All measurements and the proportions of the floor plans provided are approximate.

27 April 2026