



Millington House, Dale Street, Manchester
Offers In Excess Of £165,000

Ascend
Built on higher standards

Millington House, Dale Street, Manchester

Open For Buy To Let Investors & Residential Buyers

Welcome to Millington House, the apartment that proves good things don't just come in small packages... they come in stylish, city-centre ones too.

Perfect for first-time buyers, couples, or savvy investors looking for a spot in Manchester that's got more buzz than a café on Monday morning.

Step inside and you'll find a cosy reception room that's ideal for everything from Netflix marathons to pretending you host dinner parties. The bedroom is your new sleepy-time sanctuary, peaceful, comfy, and ready to make alarm clocks irrelevant.

And the location? Oh, it's a good one. Dale Street puts you right in the mix, shops, bars, cafés, restaurants... if Manchester were a chocolate box, this apartment would be right in the soft caramel centre. The city centre is just a stroll away, so you can ditch the commute and embrace the urban lifestyle in full force.

Tenure: LEASEHOLD
Service Charge: £3525.28
Ground Rent: £100 pa



Please note that we have not tested any apparatus, equipment, fixtures, fittings or services, and so cannot verify they are in working order or fit for their purpose. Furthermore solicitors should confirm moveable items described in the sales particulars are, in fact, included in the sale since circumstances do change during marketing or negotiations. A final inspection prior to exchange of contracts is also recommended. Although we try to ensure accuracy, measurements used in this brochure may be approximate. Therefore if intending purchasers need accurate measurements to order carpeting or to ensure existing furniture will fit, they should take such measurements themselves.

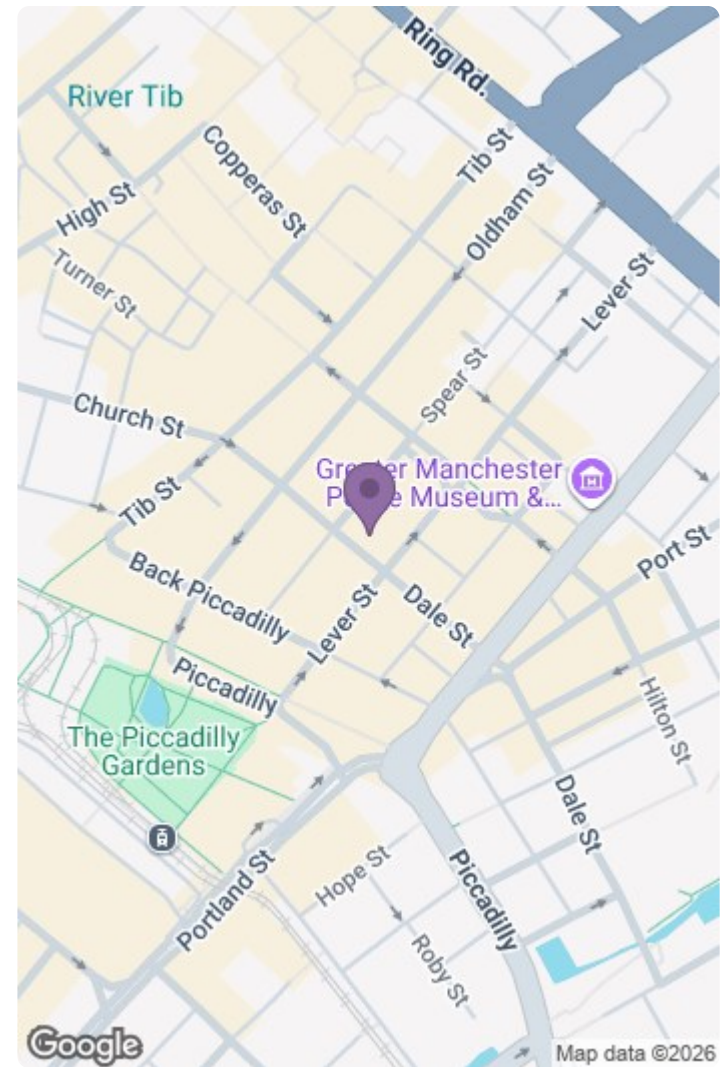
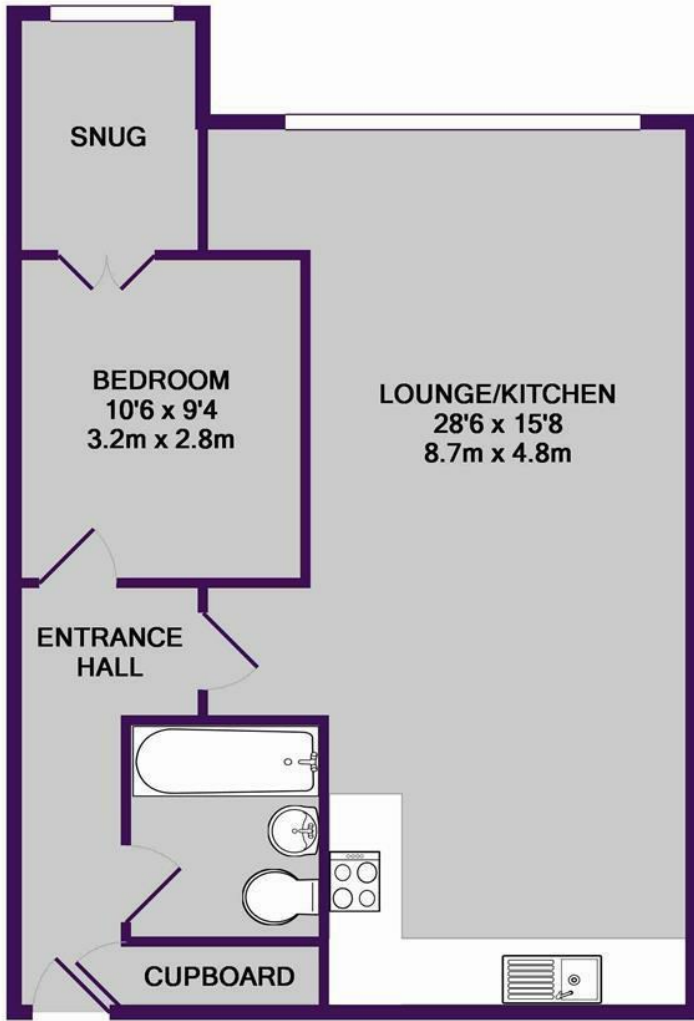

TOTAL APPROX. FLOOR AREA 640 SQ.FT. (59.5 SQ.M.)

Whilst every attempt has been made to ensure the accuracy of the floor plan contained here, measurements of doors, windows, rooms and any other items are approximate and no responsibility is taken for any error, omission, or mis-statement. This plan is for illustrative purposes only and should be used as such by any prospective purchaser. The services, systems and appliances shown have not been tested and no guarantee as to their operability or efficiency can be given.

Made with Metropix ©2015

