

7 The Old Mill, Bexley High Street, Bexley DA5 1JX
£1,150 PCM



Park Estates are delighted to present this charming one-bedroom top-floor apartment, enviably positioned in the heart of Bexley Village and just moments from the station and local amenities. Set within the beautifully refurbished Old Mill, the property offers a stylish contemporary interior and enjoys attractive views to both the front and rear. The accommodation comprises an open-plan lounge and kitchen, a well-proportioned double bedroom, and a modern bathroom. Additional benefits include a secure allocated parking space and an entry-phone system for added convenience. Available from the end of March, and with properties in this location rarely staying on the market for long, early viewing is strongly advised.

Council Tax: Band C

Score	Energy rating	Current	Potential
92+	A		
81-91	B	81 B	81 B
69-80	C		
55-68	D		
39-54	E		
21-38	F		
1-20	G		



Bexley High Street

Approximate Gross Internal Area = 42.9 sq m / 462 sq ft

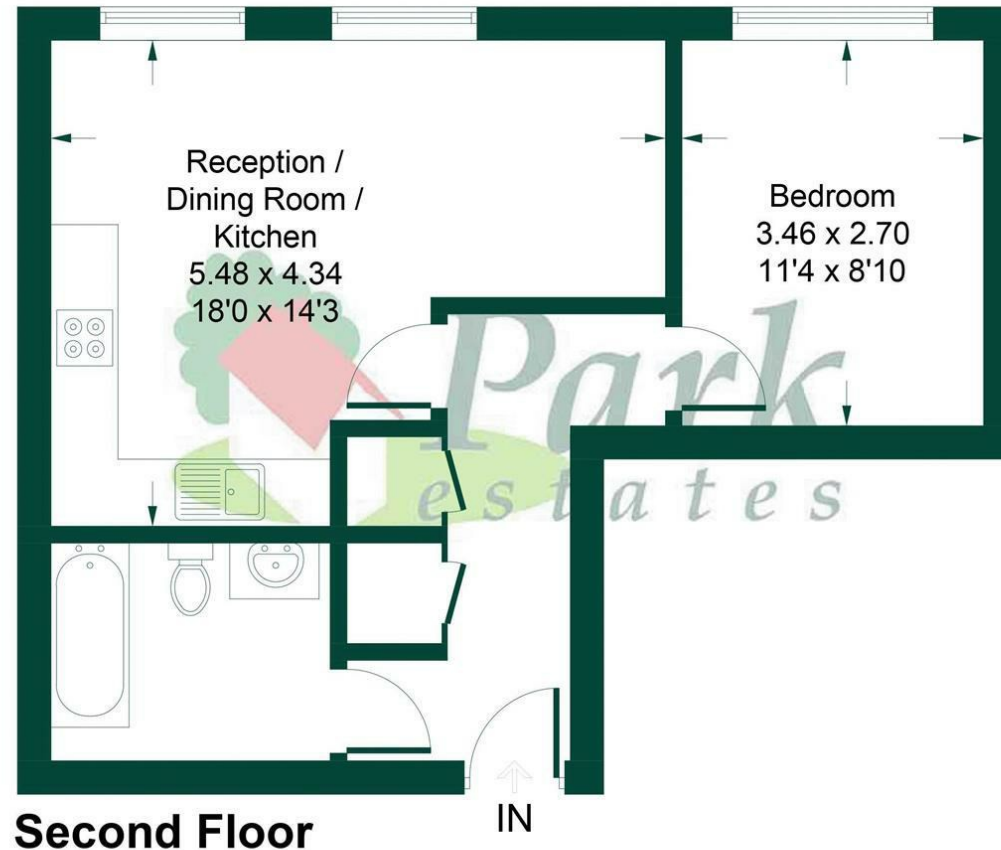

This plan is for layout guidance only. Not drawn to scale unless stated. Windows and door openings are approximate. Whilst every care is taken in the preparation of this plan, please check all dimensions, shapes and compass bearings before making any decisions reliant upon them. Produced by Planpix on behalf of Park Estates (ID864901)

01322 553322

Park Estates 60-62 High Street, Bexley, Kent, DA5 1AA

bexley@parkestates.co.uk
www.parkestates.co.uk

Every care has been taken with the preparation of details, but accuracy is in no way guaranteed. These particulars do not constitute a contract and are issued and accepted on the express understanding that all negotiations will be conducted through Park Estates. The seller does not make or give, nor do we or our employees have any authority to give a representation or warranty in relation to the property. Please contact this office before viewing the property. If there is any point which is of particular importance to you, we will be pleased to check the information for you and confirm that the property remains available. This is particularly important if you are contemplating travelling some distance to view the property. We would strongly recommend that all the information that we provide about the property is verified by yourself on inspection and also by your conveyancer, especially where statements have been made by us to the effect that the information provided by us has not been verified.