



Birmingham Road, Lickey End Bromsgrove B61 0EZ

welcome to

Birmingham Road, Lickey End Bromsgrove

*** BEAUTIFULLY PRESENTED TWO BEDROOM COTTAGE *** WONDERFULLY UNIQUE *** DRIVEWAY *** DECEIVINGLY SPACIOUS ***
KITCHEN/DINER *** SNUG *** LIVING ROOM *** UTILITY ROOM *** FAMILY BATHROOM *** SIZEABLE REAR GARDEN *** GREAT LOCATION ***



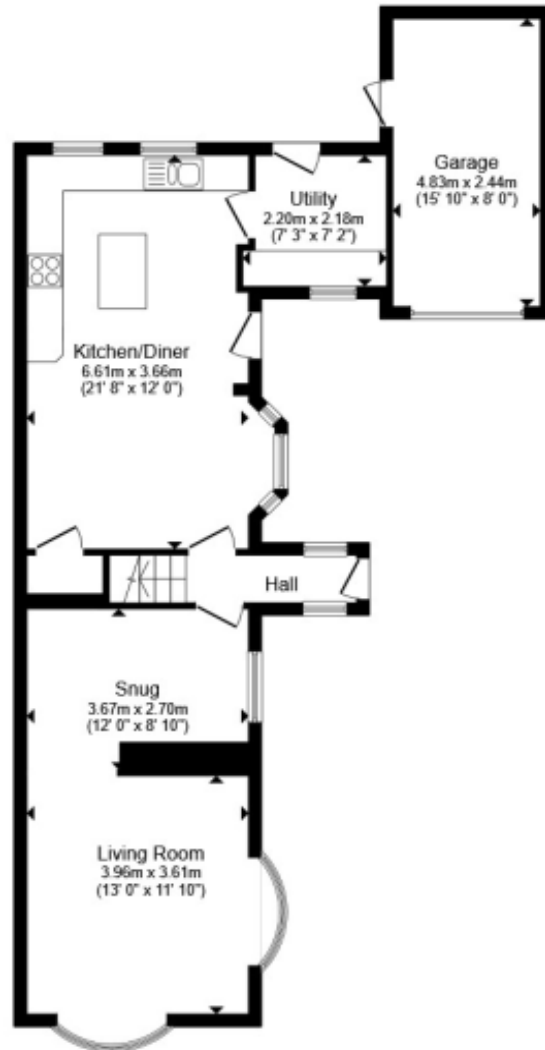

Ground Floor



First Floor

Total floor area 114.5 m² (1,233 sq.ft.) approx

This floor plan is for illustrative purposes only. It is not drawn to scale. Any measurements, floor areas (including any total floor area), openings and orientation are approximate. No details are guaranteed, they cannot be relied upon for any purpose and they do not form part of any agreement. No liability is taken for any error, omission or misstatement. A party must rely upon its own inspection(s). Powered by www.propertybox.io

Driveway

On approach to the property

15' 10" x 8' (4.83m x 2.44m)

Entrance Hall

Living Room

13' x 11' 10" (3.96m x 3.61m)

With double glazed windows to the front and side aspects, a gas fire and a central heating radiator

Kitchen/Diner

21' 8" x 12' (6.60m x 3.66m)

With a range of wall and base units, a sink/drain, dishwasher, a gas hob/oven, a fridge and double-glazed windows to the front and side aspects

Snug

12' x 8' 10" (3.66m x 2.69m)

With double glazed windows to the front and a central heating radiator

Utility Room

7' 3" x 7' 2" (2.21m x 2.18m)

With double glazed windows to the front and plumbing for a washing machine

Landing

Bedroom One

15' 1" x 9' 6" (4.60m x 2.90m)

With double glazed windows to the front, a central heating radiator and built-in wardrobes

Bedroom Two

12' 2" x 11' 10" (3.71m x 3.61m)

With double glazed windows to the front and a central heating radiator

Bathroom

With a w/c, hand wash basin, a bath with shower over, double glazed windows to the rear and a central heating radiator

Garden

Spacious garden with patio and lawn areas

Garage



view this property online shipways.co.uk/Property/RDC110455



welcome to

Birmingham Road, Lickey End Bromsgrove

- Beautifully presented Cottage
- Two great sized bedrooms
- Spacious kitchen/diner
- Snug & Living Room
- Driveway & Garage

Tenure: Freehold EPC Rating: D
Council Tax Band: D

offers over

£340,000



Please note the marker reflects the postcode not the actual property

view this property online shipways.co.uk/Property/RDC110455



Property Ref:
RDC110455 - 0003

1. MONEY LAUNDERING REGULATIONS Intending purchasers will be asked to produce identification documentation at a later stage and we would ask for your co-operation in order that there is no delay in agreeing the sale. 2. These particulars do not constitute part or all of an offer or contract. 3. The measurements indicated are supplied for guidance only and as such must be considered incorrect. Potential buyers are advised to recheck measurements before committing to any expense. 4. We have not tested any apparatus, equipment, fixtures or services and it is in the buyers interest to check the working condition of any appliances. 5. Where an EPC, or a Home Report (Scotland only) is held for this property, it is available for inspection at the branch by appointment. If you require a printed version of a Home Report, you will need to pay a reasonable production charge reflecting printing and other costs. 6. We are not able to offer an opinion either written or verbal on the content of these reports and this must be obtained from your legal representative. 7. Whilst we take care in preparing these reports, a buyer should ensure that his/her legal representative confirms as soon as possible all matters relating to title including the extent and boundaries of the property and other important matters before exchange of contracts.

Shipways is a trading name of Sequence (UK) Limited which is registered in England and Wales under company number 4268443, Registered Office is Cumbria House, 16-20 Hockliffe Street, Leighton Buzzard, Bedfordshire, LU7 1GN. VAT Registration Number is 500 2481 05.

shipways



01527 65155



Redditch@shipways.co.uk



3 Alcester Street, REDDITCH, Worcestershire,
B98 8AE



shipways.co.uk