

PARSONS  
— COMPANY —



138 Plantation Road, Hellesdon, Norwich, NR6 5RH  
£1,400 Per Calendar Month



## 138 Plantation Road, Hellesdon, Norwich, NR6 5RH

**£1,400 Per Calendar Month**

Located in the popular area of Hellesdon, this semi detached house boasts spacious accommodation of lounge, 16'11 kitchen/breakfast room, 2 double bedrooms, 1 single bedroom and modern fitted bathroom. Outside, the property benefits from a large private rear garden mainly laid to lawn and ample off road parking to the front of the property. This property is available to move in during October 2026 and would be a great family home.

**\*Application Process\***

Before viewing the property, you will be required to complete a basic application form. All applications will then be reviewed, and viewings arranged for those suitable for the property. All adults over the age of 18 need to be names on the tenancy agreement and 'right to rent' checks will need to be conducted.

For room measurements please click on the floor plan option.

Available: October 2026  
Furnishing: Unfurnished  
Council tax: Band B

## Description



## Situation



Unfurnished

Council Tax Band: B

Available: 19th October 2024

## Floor Plans

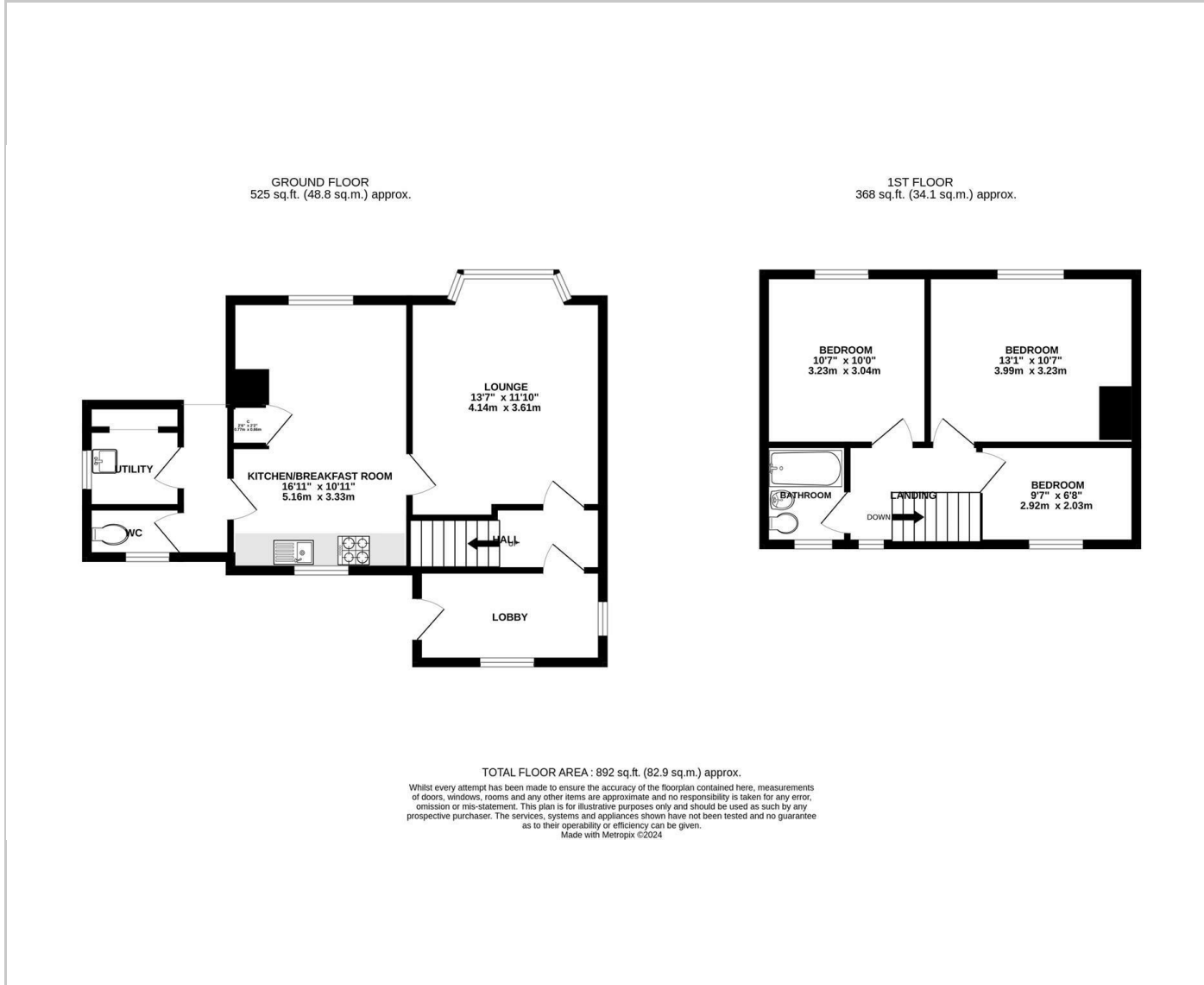

## Area Map

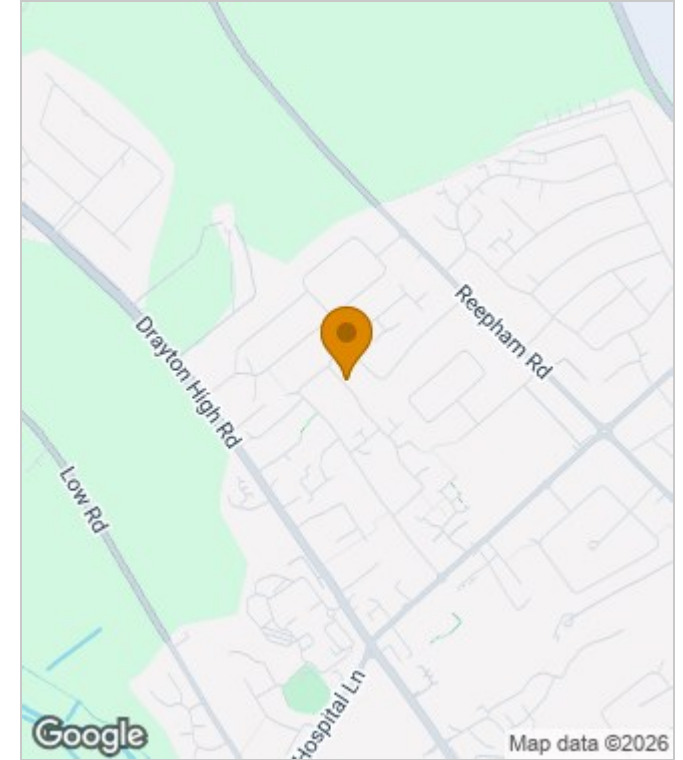

## Energy Performance Graph

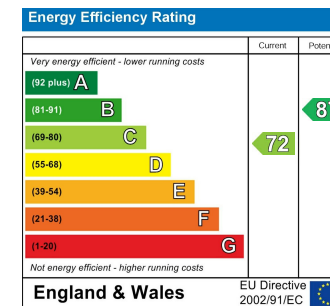

These particulars, whilst believed to be accurate are set out as a general outline only for guidance and do not constitute any part of an offer or contract. Intending purchasers should not rely on them as statements of representation of fact, but must satisfy themselves by inspection or otherwise as to their accuracy. No person in this firm's employment has the authority to make or give any representation or warranty in respect of the property.