

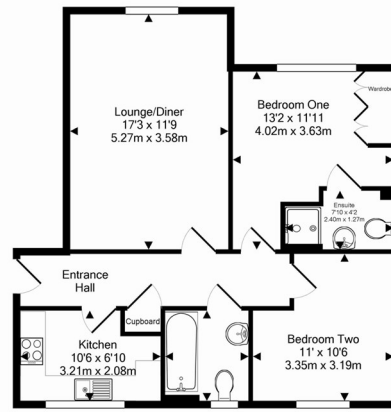

Coppice Court | Rowan Close | Whiteley | PO15 7GR

£1,200 PCM





Total Approx. Floor Area 656 Sq.Ft. (60.9 Sq.M.)
 Whilst every attempt has been made to ensure the accuracy of the floor plan contained here, measurements of doors, windows, rooms and any other items are approximate and no responsibility is taken for any error, omission, or mis-statement. This plan is for illustrative purposes only and should be used as such by any prospective purchaser. The services, systems and appliances shown have not been tested and no guarantee as to their operability or efficiency can be given.
 Made with Metropix ©2015

Energy Efficiency Rating		Current	Potential
Very energy efficient - lower running costs			
(92 plus) A			
(81-91) B			
(69-80) C			
(55-68) D			
(39-54) E			
(21-38) F			
(1-20) G			
Not energy efficient - higher running costs			
England & Wales		EU Directive 2002/91/EC	



Description

*Walking Distance to Whiteley Shopping Centre *Well Presented Two Double Bedroom Top Floor Apartment
 *Kitchen Re fitted in 2025 *Lounge/Dining Room *En-Suite To Master Bedroom & Family Bathroom *Allocated Parking
 *Historical Images have been used and the property is currently occupied

Key features

- Top Floor Apartment
- Main bathroom plus En Suite
- Kitchen
- Walking Distance to Whiteley Shopping Centre
- Two Double Bedrooms
- Lounge Diner
- Allocated Parking



H3 Whiteley Shopping Centre
 Whiteley Way
 Whiteley
 Hants
 PO15 7PD
 01489 580800
 pm@walkerwaterer.co.uk
 www.walkerwaterer.co.uk