



George Street, W1H

£3,596 Per calendar month

A modern one bedroom apartment on the first floor of an attractive Georgian building on George Street, moments from Hyde Park.

George Street is moments from the open spaces of Hyde Park and a short walk from the vibrant shops, bars and restaurants of Portman Village and Marylebone Village. Edgware Road, Marble Arch and Bond Street stations are all close by.

Features

- One Bedroom
- Unfurnished
- Built-In Wardrobe
- Open-Plan Reception
- Wooden Floors
- The Portman Estate

George Street, London, W1H

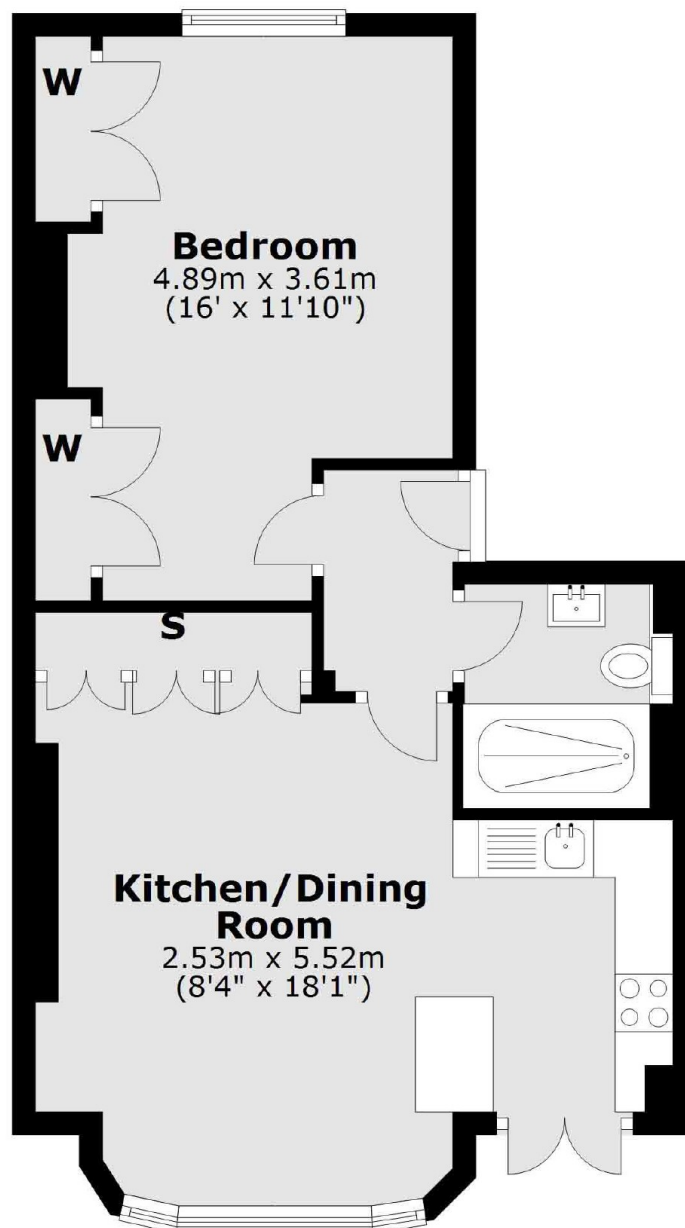

First Floor

Total area: approx. 44.7 sq. metres (481.4 sq. feet)