



Ely Street, Stratford-Upon-Avon, CV37 6LN

**SHELDON
BOSLEY
KNIGHT**

LAND AND
PROPERTY
PROFESSIONALS

Property Description

*** DEPOSIT ALTERNATIVE AVAILABLE ***

Situated in a highly sought-after location adjacent to Bell Court, this charming two-bedroom terrace home offers an excellent combination of comfort and convenience. With an array of popular cafés, restaurants, and shops on your doorstep, and Stratford-upon-Avon town centre, the Royal Shakespeare Theatre, and other local attractions just a short walk away, this property is perfectly positioned to enjoy everything the town has to offer. Upon entering, you are welcomed into a cosy and inviting living room, complete with a feature fireplace that creates a warm and homely atmosphere. To the rear of the property is a bright and spacious kitchen, offering direct access to an exceptionally generous rear garden—a valuable feature for such a central location. The garden also benefits from useful external storage. Upstairs, the property comprises two well-proportioned bedrooms and bathroom. Freshly decorated throughout and offered unfurnished, the home provides a blank canvas for tenants to make it their own. Ideal for professionals, couples, or small families seeking a central yet peaceful location, this delightful home is not to be missed. Permit parking is available on-street via the local council. Council Tax Band D. Energy Performance Rating: C.





Key Features

- DEPOSIT ALTERNATIVE AVAILABLE
- Stratford Upon Avon
- 2 Bedrooms
- Mid-Terrace
- Unfurnished
- Private Garden
- On street parking via permit
- Council Tax Band D
- Energy Rating C
- Available Now



Approximate total area⁽¹⁾
671 ft²
62.3 m²

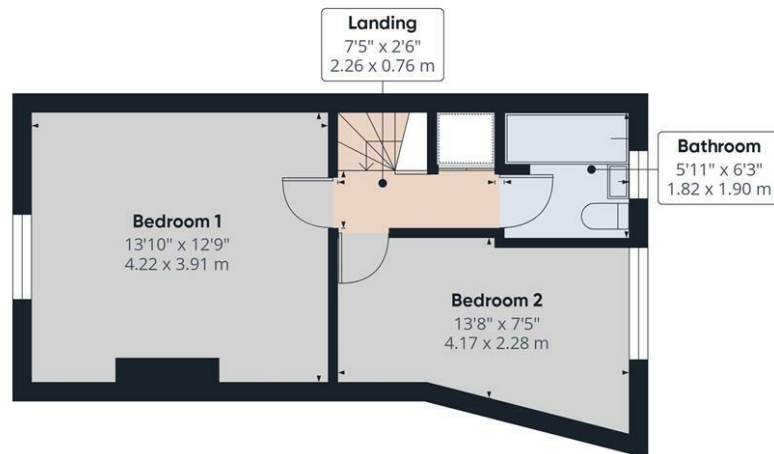

(1) Excluding balconies and terraces

Calculations reference the RICS IPMS 3C standard. Measurements are approximate and not to scale. This floor plan is intended for illustration only.

GIRAFFE360

£950 PCM