



## ARUNDEL TERRACE, SW13

£735,000

Mansion flat  
Two bedrooms  
Communal garden  
Share of freehold  
Moments from Hammersmith Bridge  
Barnes

@marshandparsons  
marshandparsons.co.uk

MARSH &  
PARSONS



# ABOUT THE PROPERTY

Marsh & Parsons are delighted to present this beautiful raised ground floor two-bedroom mansion flat, quietly set at the end of a residential cul-de-sac moments from Hammersmith Bridge.

The property features a front reception room with a wood burner, built-in alcove bookcases, and a private balcony overlooking Castelnau Mansions and Harrods Village. There are two bedrooms, including a spacious principal double, while the second is currently used as a study but can accommodate a double bed.



# STEP INSIDE ARUNDEL TERRACE

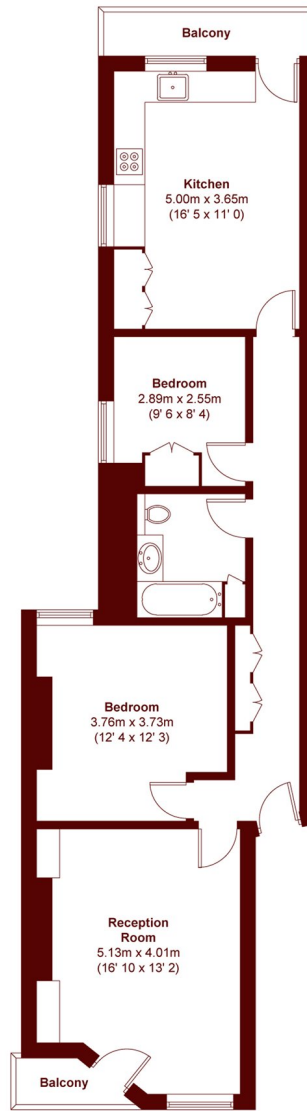

APPROX. GROSS INTERNAL FLOOR AREA 837 SQFT / 77.8 SQM  
APPROX. GROSS EXTERNAL BALCONY AREA 50 SQFT / 4.7 SQM

**Barnes & East Sheen**  
020 8563 8333

Energy Rating: C We aim to make our particulars both accurate and reliable. However, they are not guaranteed; nor do they form part of an offer or contract. If you require clarification on any points then please contact us, especially if you're traveling some distance to view. Please note that appliances and heating systems have not been tested and therefore no warranties can be given as to their good working order

**MARSH &  
PARSONS**