



Fulham Palace Road, SW6

£399,999

A bright and well-presented one bedroom flat situated on the third floor, featuring a spacious open plan kitchen, dining, and reception area. The property also benefits from a modern, well-maintained bathroom, with Sonos speakers installed throughout the main living areas.

Fulham Palace Road offers excellent access to a wide range of local amenities, including riverside walks, cafés, and shops. The property is also well-served by transport links, with Barons Court Underground station just a short walk away and Hammersmith station approximately 10 minutes away.

Features

- One Bedroom
- Open Plan Living Space
- Fully Renovated
- Natural Light
- Lift Access
- Hammersmith Broadway

Fulham Palace Road, London, SW6

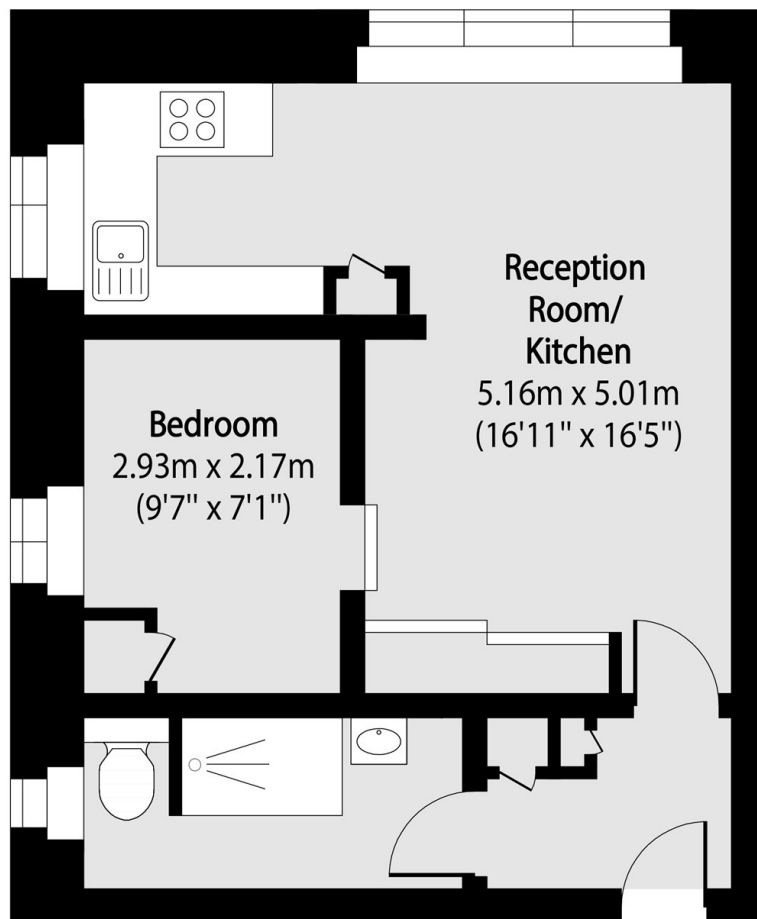

Total area (approx): 34.98 sq m (377 sq. ft)