

Kingston Road Wimbledon, SW19 1JW

£1,850 Per Month



Fantastic modern, high spec one bedroom apartment with private balcony. Located just 0.2 miles from South Wimbledon tube (Northern line) and close to local shops, cafes and restaurants, as well as 0.8 miles to Wimbledon town centre and train station. The property features a good size open plan kitchen/reception room with integrated appliances including dishwasher, and good size double bedroom with large built in wardrobes.

** Car free development, parking permits not available.

Great EPC rating, band B. Council tax band C.

Kingston Road, SW19

Approximate Gross Internal Area = 40 sq m / 430 sq ft

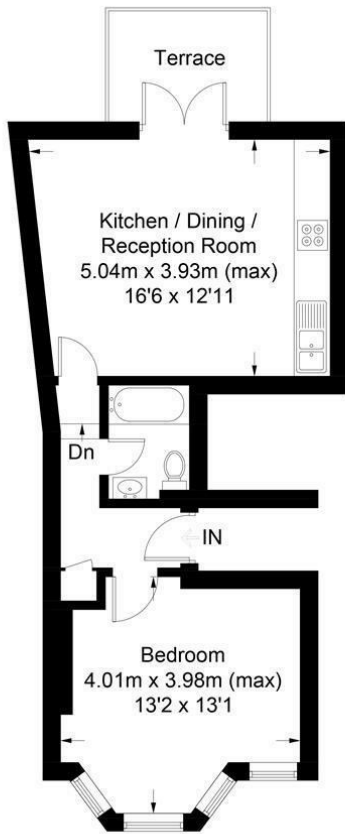

First Floor

This floor plan is for representation purposes only and is not drawn to scale.
 The Gross Internal Area includes outbuildings shown on the plan.
 Whilst every attempt has been made to ensure the accuracy of the plan measurements of doors, windows and rooms are approximate only and should be checked before making any decisions reliant upon them.
 Copyright Bespokeplans.co.uk (ID522784)



- Modern one bedroom apartment
- Private balcony
- Open plan kitchen with dishwasher
- 0.2 miles to South Wimbledon tube
- Large fitted wardrobes
- First months rent in advance
- Five weeks security deposit
- Holding deposit = one weeks rent
- EPC band B
- Council tax band C

Energy Efficiency Rating		Current	Potential
Very energy efficient - lower running costs			
(92 plus)	A		
(81-91)	B		
(69-80)	C		
(55-68)	D		
(39-54)	E		
(21-38)	F		
(1-20)	G		
Not energy efficient - higher running costs			
England & Wales		EU Directive 2002/91/EC	



Although these particulars are believed to be correct, their accuracy is not guaranteed and they do not form part of any contract.

Celebrating 30 years of successful Sales and Lettings in Merton

