



**POOLE  
TOWNSEND**

# Helmside Road, Oxenholme, Kendal, LA9 7ET

£225,000

🛏️ 2 🚿 1 🚗 1



- Terraced House
- High Ceilings and Plenty of Natural Light
- Solid Oak Flooring
- Secure Garden Store
- Tenure: Freehold
- 2 Bedrooms
- Spacious Lounge/Diner
- Views of The Helm
- Courtyard Garden
- Council tax band: B



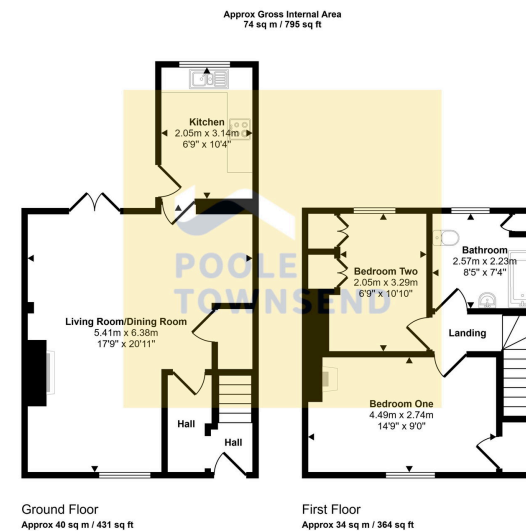

This floorplan is only for illustrative purposes and is not to scale. Measurements of rooms, doors, windows, and any items are approximate and no responsibility is taken for any error, omission or mis-statement. Icons of items such as bathroom suites are representations only and may not look like the real items. Made with Made Snappy 360.

Situated in the sought-after village of Oxenholme, this charming traditional red-brick railway cottage enjoys lovely views towards The Helm and offers stylish, generously proportioned accommodation throughout. Beautifully presented with high ceilings and plenty of natural light, the property blends character and comfort perfectly. The spacious lounge/diner features solid oak flooring, an exposed brick fireplace with multi-fuel stove and glazed doors opening onto the south-facing courtyard garden, creating excellent indoor-outdoor flow. The modern kitchen provides a practical and attractive space for cooking, with direct access outside. Upstairs are two generous double bedrooms and a well-appointed three-piece bathroom. Externally, the enclosed courtyard garden offers a peaceful space to relax, complete with potted planting and a secure garden store.

Visit us at  
[www.pooletownsend.co.uk](http://www.pooletownsend.co.uk)  
[enquiries@pooletownsend.co.uk](mailto:enquiries@pooletownsend.co.uk)

We are open  
 Monday – Friday 9.00 – 5.00  
 Saturday 9.00 – 1.00

Barrow 01229 811811  
 Ulverston 01229 588111  
 Grange 015395 33316  
 Kendal 01539 734455  
 Milnthorpe 015395 62044