



Swallows Court
Bristol BS34 8TH

Price:
£1,350 PCM

Property Features

- Semi-Detached House
- 2 Bedroom
- Close to Parkway, Axa, MOD etc.
- Excellent Decorative order
- Garden & Parking
- Available April 2026
- No Sharers
- Pets Considered

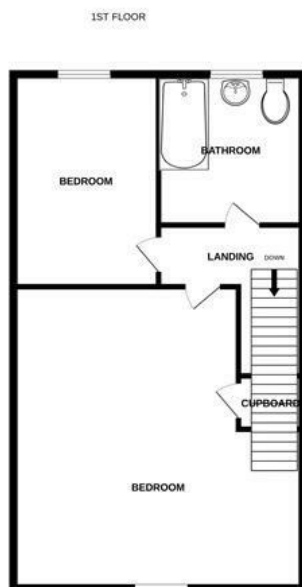
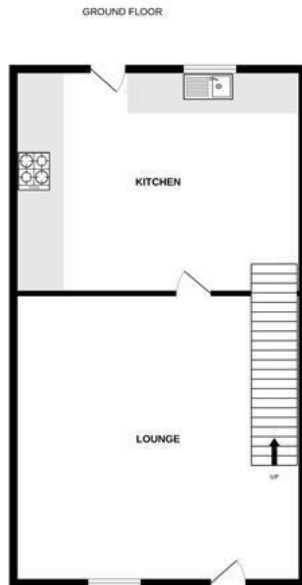

Full Description

LOUNGE
15'9" x 11'8"

KITCHEN
11'8" x 6'0"
Including built in electric oven and microwave, gas hob with extractor over.

BEDROOM 1
11'8" x 11'1"

BEDROOM 2
10'11" x 5'7"

BATHROOM
5'9" x 5'6"

GARDEN

PARKING

Measurements are approximate. Not to scale. Illustrative purposes only
Made with Metropix ©2026

4 Flaxpits Lane
Winterbourne
Bristol
BS36 1JX

www.aj-homes.co.uk
info@aj-homes.co.uk
01454 252140

Agents Note: Whilst every care has been taken to prepare these sales particulars, they are for guidance purposes only. All measurements are approximate are for general guidance purposes only and whilst every care has been taken to ensure their accuracy, they should not be relied upon and potential buyers are advised to recheck the measurements