



www.knights.uk.com

CARDIFF

VALE

CAERPHILLY

BRISTOL

Fomilly Road

WEST END



This well presented semi detached home offers excellent space and flexibility, featuring three good sized bedrooms, two reception rooms and a generous garden, a real advantage for the area. Situated in the highly sought after West End of Barry, the property benefits from easy access to local schools, shops and transport links, as well as nearby beaches and attractive views across Barry towards the sea and Barry Island.

Comments by Mrs Samantha Draisey



Property Specialist

Mrs Samantha Draisey

Branch manager

samantha@jeffreycrossandknights.co.uk

Romilly Road

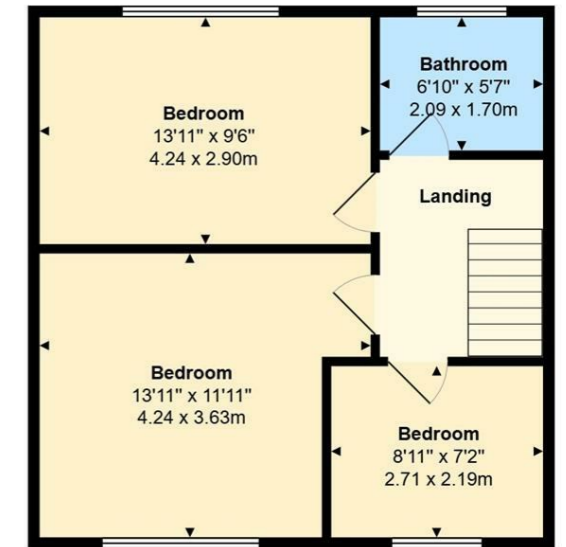
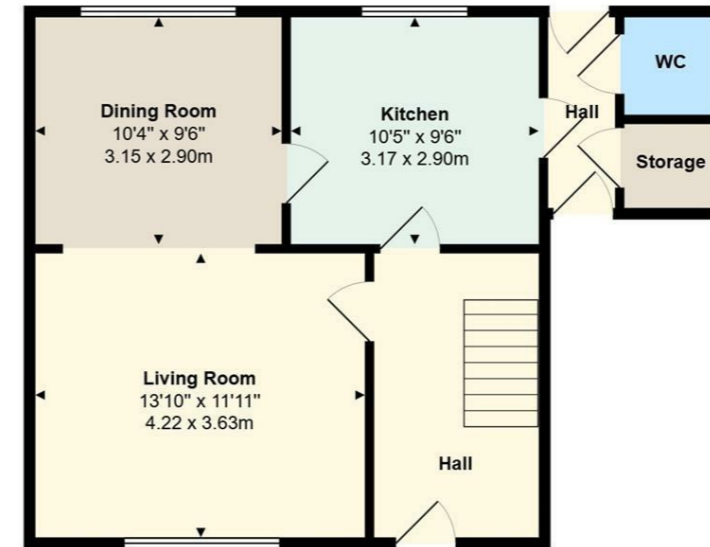

Total Area: 983 ft² ... 91.4 m²

All measurements are approximate and for display purposes only

What I've loved most about this home is the space and versatility, with three good sized bedrooms, two reception rooms and a generous garden that's been perfect for everyday living. The West End location has been ideal, with schools, shops and transport links all within walking distance, along with easy access to the beaches and lovely views across Barry towards the sea and Barry Island. It's been a comfortable home in a fantastic area.

Comments by the Homeowner





Romilly Road

West End, Barry, CF62 6BA

Offers Invited

£240,000



3 Bedroom(s)



1 Bathroom(s)



983.00 sq ft

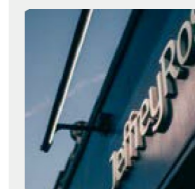

Contact our
Knights Barry Branch

01446 700222

PROCEEDABLE BUYERS ONLY

Located in the popular West End of Barry, this semi detached house on Romilly Road offers a practical and well presented home for families or individuals. The property includes three good sized bedrooms, providing plenty of space for everyday living.

There are two reception rooms that can be used for relaxing, dining, or working from home. The large garden is a real advantage for this area, offering plenty of outdoor space for children, pets, or those who enjoy gardening.

The property is conveniently positioned within walking distance of local schools, shops, and public transport, making daily routines simple and efficient. The nearby beaches are easy to reach and ideal for walks or days out, and there are attractive views across Barry towards the sea and Barry Island.

The house also sits within the catchment area for several well regarded schools, which will appeal to families. With its practical layout, great location, and spacious garden, this Romilly Road property is a solid choice for anyone looking for a home or investment in one of Barry's most sought after areas.



HALLWAY 6'11" x 11'11" (2.11m x 3.63m)

W/C 3'10" x 3'11" (1.17m x 1.19m)

BATHROOM 5'07" x 6'11" (1.70m x 2.11m)

LIVING ROOM 13'10" x 11'10" (4.22m x 3.61m)

STORAGE 3'11" (1.19m)

DINING ROOM 9'06" x 10'04" (2.90m x 3.15m)

BEDROOM ONE 9'06" x 13'11" (2.90m x 4.24m)

KITCHEN 9'06" x 10'04" (2.90m x 3.15m)

BEDROOM TWO 13'11" x 11'10" (4.24m x 3.61m)

OUTER HALLWAY 2'10" x 7'10" (0.86m x 2.39m)

BEDROOM THREE 8'11" x 7'02" (2.72m x 2.18m)

CARDIFF

VALE

CAERPHILLY

BRISTOL





Energy Efficiency Rating		Current	Potential
Very energy efficient - lower running costs			
(92 plus) A			85
(81-91) B			
(69-80) C			
(55-68) D		56	
(39-54) E			
(21-38) F			
(1-20) G			
Not energy efficient - higher running costs			
England & Wales		EU Directive 2002/91/EC 