

33 Appleford Drive, Minster On Sea

£325,000

 3  1  2



Set within the sought after location of Minster-on-Sea, this impressive three bedroom detached home offers the perfect balance of comfort, space and lifestyle. Imagine arriving home along the long private driveway, stepping inside and instantly feeling the sense of calm that a well designed layout provides. The property features a comfortable lounge ideal for unwinding, alongside a sociable kitchen/diner where everyday moments naturally become the heart of the home. A convenient downstairs WC adds practicality, while internal access from the garden leads directly into the garage, making daily life effortless. Outside, the southerly facing garden invites you to enjoy sunshine filled afternoons and relaxed evenings. With the village green, local shops, local park for both children and pets, Sheerness golf course and the beautiful coastline at Minster Leas all nearby, this is a home ready to move straight into and start enjoying from day one.

Quote PA1009 when calling in.



07778 703 438



phil.abrahart@exp.uk.com



philabrahart.exp.uk.com



Phil Abrahart is an approved agent of eXp World UK Limited, trading as eXp UK, registered at 5 Churchill Place, 10th Floor, London, United Kingdom, E14 5HU. Company number 12016573. VAT no 327 4120 29. If you have instructed another agent to sell your house and instruct eXp World Ltd to sell your property at the same time, then you could be liable to pay both agents. It is recommended that you check the contract you have with your current agent.

PHIL ABRAHART

POWERED BY
exp UK

- Three bedroom detached family home
- Spacious kitchen/diner great for entertaining/mealtimes
- Separate cosy lounge for relaxing evenings
- Detached garage be ideal for either a car or as a Gym
- Useful downstairs wc in the entrance hall
- Southerly facing rear garden for all you sun worshippers out there
- Local park for walking the dog or for the children to play, aswell as Sheerness Gold club not far away
- Long private driveway and garage
- Southerly facing sun filled garden
- QUOTE PA1009

Appleford Drive, Minster on Sea ME12 2TB

Approximate Gross Internal Floor Area = 73.2 sq m / 788 sq ft

Approximate Garage Floor Area = 13.4 sq m / 145 sq ft

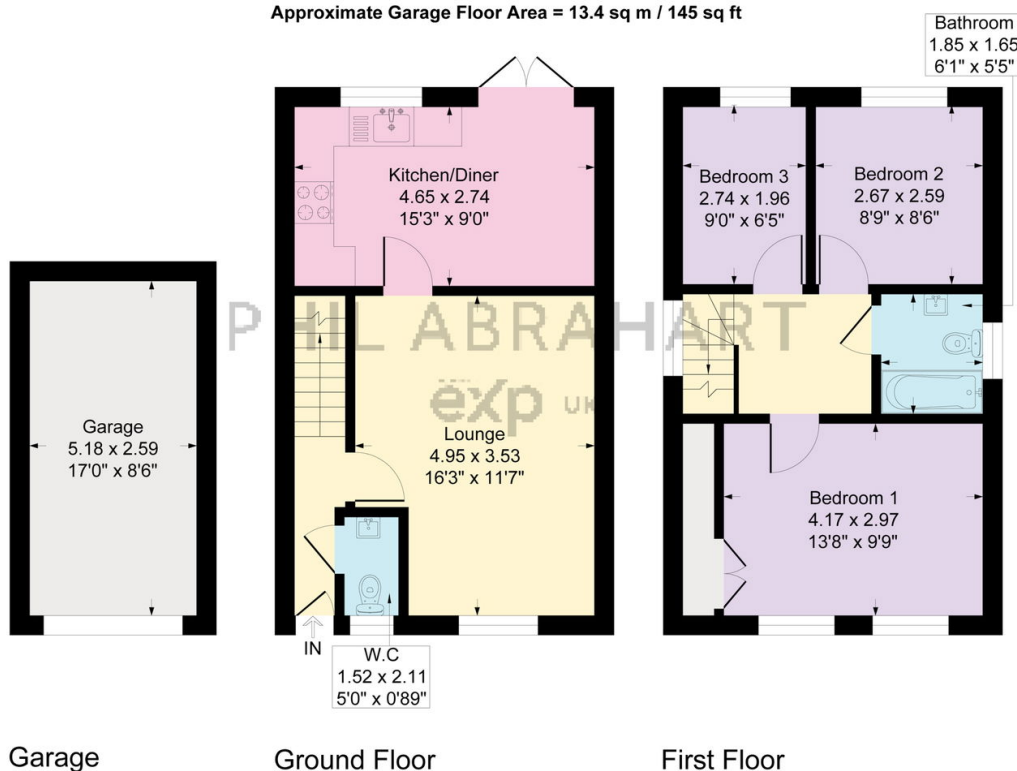

Illustration for identification purposes only, measurements are approximate, not to scale.