





No Onward Chain! This unique and stylish detached home is located on Matfen Place in this desirable pocket of Fenham. Matfen Place, a no through road, is situated close to Newcastle City Centre and is also perfectly placed to give access to surrounding greenery, the Newcastle hospitals and is also only a short walk from one of the region's finest independent schools.

With Parquet flooring throughout most of the ground floor, the accommodation briefly comprises: entrance hall with storage cupboard and stairs to first floor; sitting room with feature wood burning stove; kitchen diner, measuring almost 18ft with a range of fitted units, Belfast sink, hardwood work surfaces, spot and hanging lighting, under-stairs storage and bi-fold doors dual leading out to the rear garden. The first floor landing gives access to three bedrooms, bedrooms one and three both with storage cupboards and a super stylish bathroom complete with Velux window and three piece suite including a free standing bath and spot lighting. Externally, a front town garden with mature planting and to the rear, an enclosed block paved with fenced boundaries. Early viewings are advised to avoid disappointment!

Unique & Stylish Detached House | Three Bedrooms | 973 Sq ft (90.4m2) | Sitting Room | 17ft Kitchen Diner | Super Stylish Bathroom | Front Town Garden | Rear Yard | GCH | Freehold | No Onward Chain | Council Tax Band B | Freehold | EPC: D

**Offers Over £285,000**

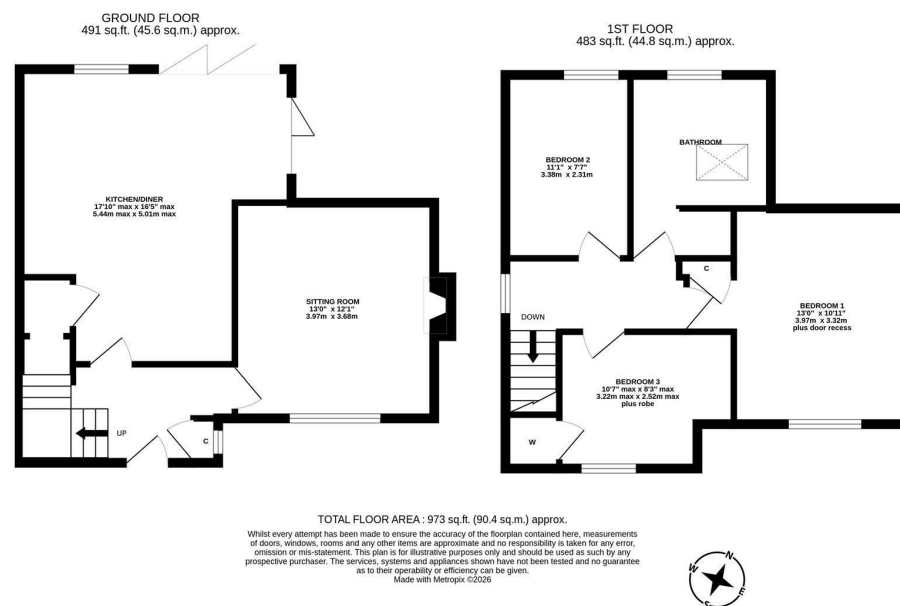

**IMPORTANT NOTE:** These particulars and the descriptions and measurements herein do not constitute representation and whilst every effort has been made to ensure accuracy, this cannot be guaranteed.

