

# Cowley Mill Road

Uxbridge • Middlesex • UB8 2QE

PCM: £2,650 PCM



coopers  
est 1986







A stunning and beautifully presented four bedroom semi detached house offering fantastic accommodation over three floors. The property has a stylish interior, a landscaped rear garden and contemporary block paved driveway for four cars. The property is situated within easy reach of Uxbridge town centre, well-regarded schools and country parks.

Available unfurnished.

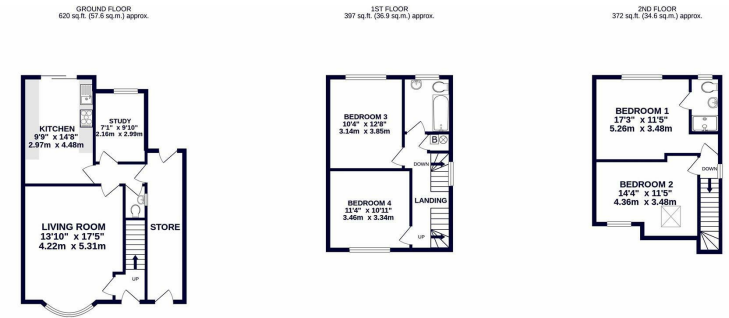

TOTAL FLOOR AREA: 1389 sq.ft. (129.1 sq.m.) approx.

While every attempt has been made to ensure the accuracy of the floorplan contained here, measurements of doors, windows, rooms and any other details are approximate and no responsibility is taken for any errors, omissions or mis-statements. This plan is for illustrative purposes only and should not be used as a basis for any prospective purchase. The services, systems and appliances shown have not been tested and no guarantee as to their operability or efficiency can be given.

Made with Autoplan 2020



## Available Date

26th March 2026

**coopers**  
est 1986

01895 257 566

1 Vine Street, Uxbridge,  
Middlesex, UB8 1QE

propertymanagement@coopersresidential.co.uk

CoopersResidential.co.uk

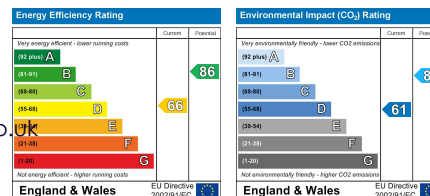

Important Notice: These particulars, whilst believed to be accurate are set out as a general outline only for guidance and do not constitute any part of an offer or contract. Intending purchasers should not rely on them as statements or representation of fact, but must satisfy themselves by inspection or otherwise has the authority to make or give any representation or warranty in respect of the property.