



## 11 Midford Road

Combe Down, Bath, BA2 5RQ

£1,350 Per Month



PLEASE DO NOT CALL AGENT AND IF YOU WOULD LIKE TO APPLY, PLEASE EMAIL AGENT THROUGH THE PORTAL REQUESTING AN APPLICATION FORM

Nestled in the charming area of Combe Down, Bath, this spacious two-bedroom flat at St Martins Court offers a delightful blend of modern living and comfort. As you step inside, you will be greeted by a bright and airy atmosphere, enhanced by large windows that allow natural light to flood the space.

The flat features a well-appointed reception room, perfect for relaxing or entertaining guests. The newly fitted kitchen is a standout feature, equipped with contemporary appliances and ample storage, making it a joy for any home cook. The bathroom has also been recently updated, providing a fresh and stylish space for your daily routines.

Both bedrooms are generously sized, offering plenty of room for furnishings and personal touches. This property is ideal for professionals, couples, or small families seeking a comfortable home in a desirable location.

Additionally, the flat comes with an allocated parking space, a valuable asset in this sought-after area. With its convenient access to local amenities and the picturesque surroundings of Bath.

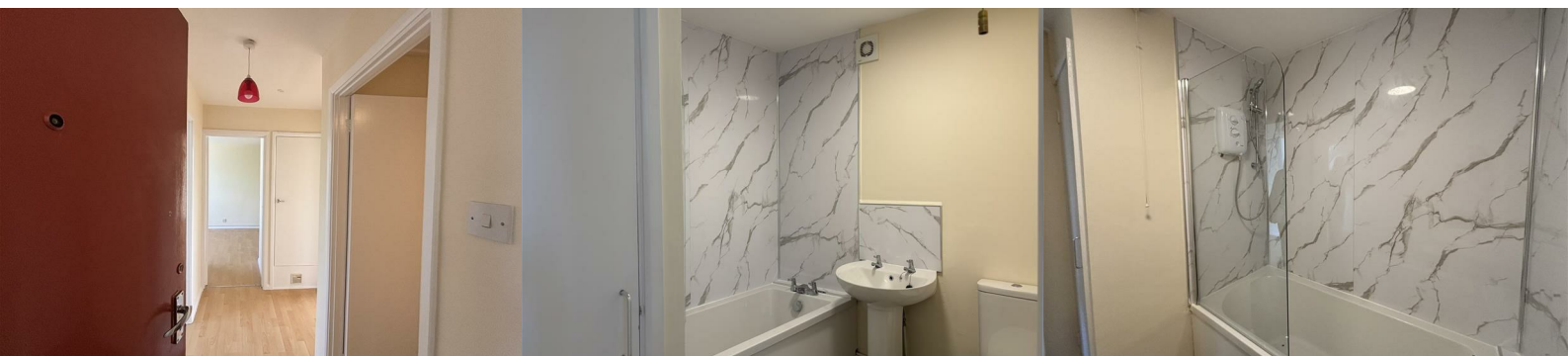

## Area Map



## Floor Plans

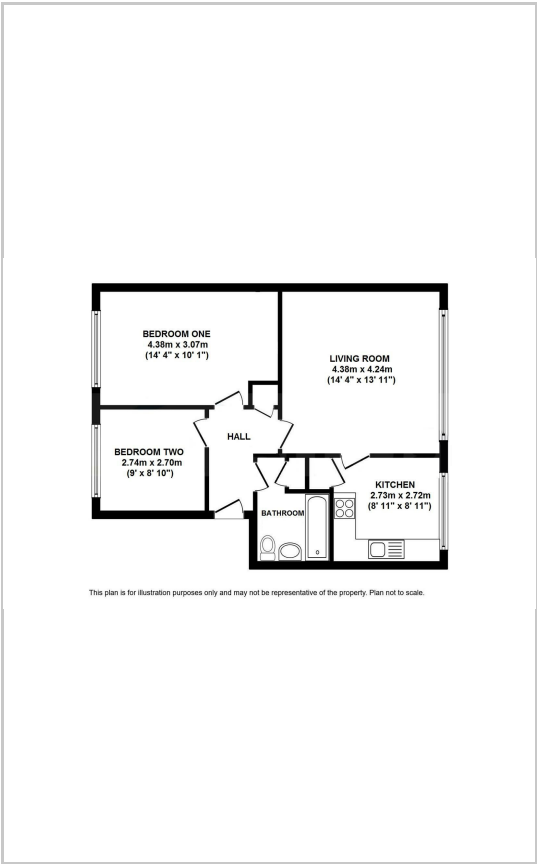

## Energy Efficiency Graph

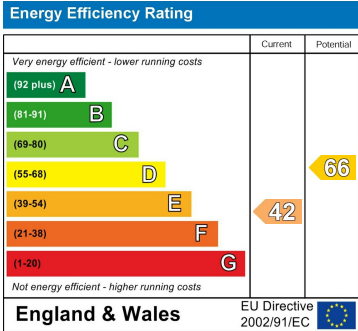

These particulars, whilst believed to be accurate are set out as a general outline only for guidance and do not constitute any part of an offer or contract. Intending purchasers should not rely on them as statements of representation of fact, but must satisfy themselves by inspection or otherwise as to their accuracy. No person in this firm's employment has the authority to make or give any representation or warranty in respect of the property.