



**45 MOUNT ROAD
CHESSINGTON
KT9 1JQ
£435,000**

EXTENDED END TERRACE HOUSE

TWO BEDROOMS

TWO RECEPTION ROOMS

13'9 X 9'10 MODERN KITCHEN BREAKFAST ROOM

MODERN WHITE BATHROOM SUITE

DOUBLE GLAZED WINDOWS

GAS CENTRAL HEATING

175' REAR GARDEN

GARAGE TO THE REAR

WELL PRESENTED

AN IDEAL FIRST TIME BUY

Ground Floor
51.3 sq.m. (553 sq.ft.) approx.

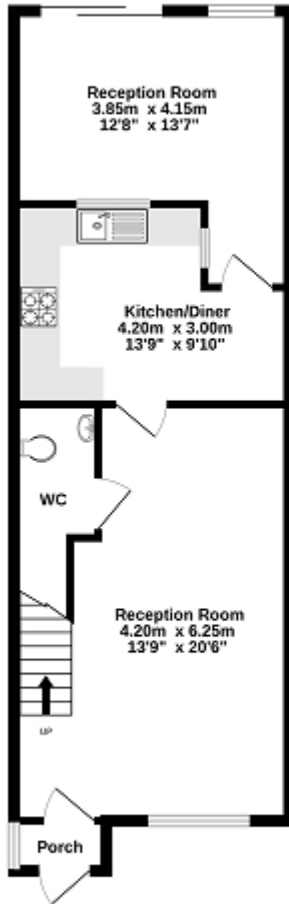

1st Floor
26.3 sq.m. (283 sq.ft.) approx.

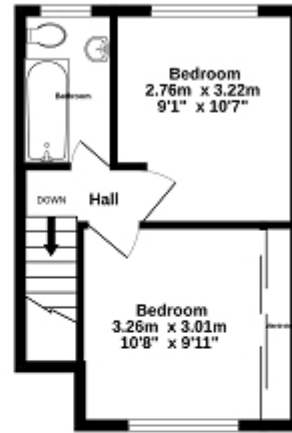

TOTAL FLOOR AREA : 77.6 sq.m. (836 sq.ft.) approx.

While every attempt has been made to ensure the accuracy of the floorplan contained here, measurements of doors, windows, rooms and any other items are approximate and no responsibility is taken for any error, omission or mis-statement. This plan is for illustrative purposes only and should be used as such by any prospective purchaser. The services, systems and appliances shown have not been tested and no guarantee as to their operability or efficiency can be given.
Made with Metropix 03028

