



4 JASMINE COURT HORSHAM

£190,000
LEASEHOLD

- ATTRACTIVE ONE BEDROOM GROUND FLOOR RETIREMENT APARTMENT FOR OVER 55'S EXCLUSIVELY
- CONVENIENT TOWN CENTRE LOCATION
- VERY WELL MAINTAINED
- MODERN KITCHEN
- PREMIUM LOCATION WITHIN THE BUILDING WITH STUNNING GARDEN AND PARK VIEWS
- GUIDE PRICE £190,000 - £200,000
- GOOD SIZED BEDROOM WITH BUILT IN WARDROBES AND VIEWS OF THE BEAUTIFUL GREEN SPACE OUTSIDE
- SPACIOUS LOUNGE WITH DOUBLE DOORS OUT TO THE COMMUNAL SOUTH EAST FACING GARDENS AND PATIO
- BATHROOM WITH WALK IN SHOWER



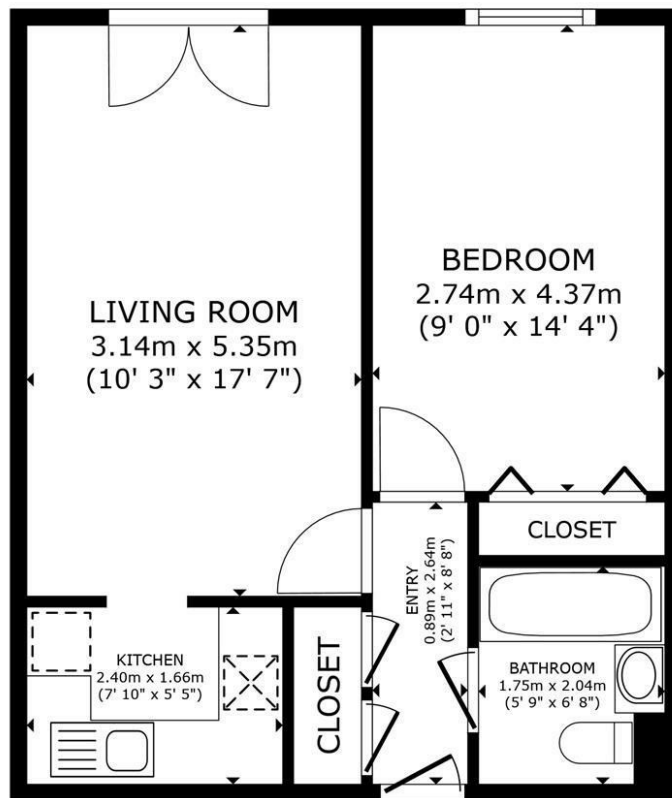

FLOOR PLAN

ELTONS

Estate Agents

GROSS INTERNAL AREA
FLOOR PLAN 42.5 m² (458 sq.ft.)
TOTAL : 42.5 m² (458 sq.ft.)
SIZES AND DIMENSIONS ARE APPROXIMATE, ACTUAL MAY VARY.



Energy Efficiency Rating		
	Current	Potential
Very energy efficient - lower running costs		
(92+)	78	80
A		
(81-91)		
B		
(69-80)		
C		
(55-68)	78	80
D		
(39-54)		
E		
(21-38)	78	80
F		
(1-20)	78	80
G		
Not energy efficient - higher running costs		
England & Wales		EU Directive 2002/91/EC

Agents Note: Whilst every care has been taken to prepare these particulars, they are for guidance purposes only. All measurements are approximate and are for general guidance purposes only and whilst every care has been taken to ensure their accuracy, they should not be relied upon and potential buyers/tenants are advised to recheck the measurements

Eltons Estate Agents Horsham 01403 299 771
13 - 15 Queen Street sales@eltons.co.uk
Horsham eltons.co.uk
West Sussex
RH13 5AA

ELTONS
Estate Agents