



MILLBANK COURT , JOHN ISLIP STREET, 1 BED APARTMENT

£2,350 PCM

Spacious one bedroom 1st floor flat (Roof Terrace) located in a portered building in Westminster. This apartment has been refurbished to a high standard offering ample living space.

This modern one bedroom flat is in excellent condition and of a purpose built portered building with open plan kitchen that offers all modern appliances. The double bedroom is fitted with large wardrobes and the bathroom is well-finished.

Hemmingfords

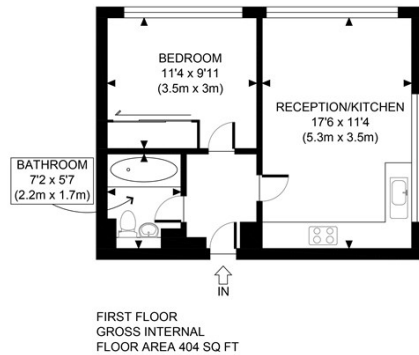

APPROX. GROSS INTERNAL FLOOR AREA 404 SQ FT / 38 SQM	Millbank Court SW1P
Disclaimer: Floor plan measurements are approximate and are for illustrative purposes only. While we do not doubt the floor plan accuracy and completeness, you or your advisors should conduct a careful, independent investigation of the property in respect of monetary valuation	date: 12/12/20 photoplan



Energy Efficiency Rating		Current	Potential
Very energy efficient - lower running costs			
(92 plus) A			
(81-91) B			
(69-80) C		72	78
(55-68) D			
(39-54) E			
(21-38) F			
(1-20) G			
Not energy efficient - higher running costs			
England & Wales		EU Directive 2002/91/EC	

Agents Note: Whilst every care has been taken to prepare these particulars, they are for guidance purposes only. All measurements are approximate and are for general guidance purposes only and whilst every care has been taken to ensure their accuracy, they should not be relied upon and potential buyers/tenants are advised to recheck the measurements

Hemmingfords Lettings
34 Upper Street
London
N1 0PN

020 3890 7470
info@hemmingfords.co.uk
www.hemmingfords.co.uk

Hemmingfords