



The Knoll, W13

£525,000

Situated on the eighth floor of this popular block is this two double bedroom apartment with incredible triple aspect views to the North, South and East. Requiring some updating, the property has lift access, share of freehold and a residents swimming pool.

Set back in a secluded spot amongst tranquil residents gardens and lake. The property is also excellently located for access to the shops, restaurants and amenities of Ealing Broadway, as well as the award winning Pitshanger Lane high street.

Features

- Two Bedrooms
- Residents Parking
- Share Of Freehold
- Private Balcony
- Garage
- No Onward Chain

The Knoll, London, W13

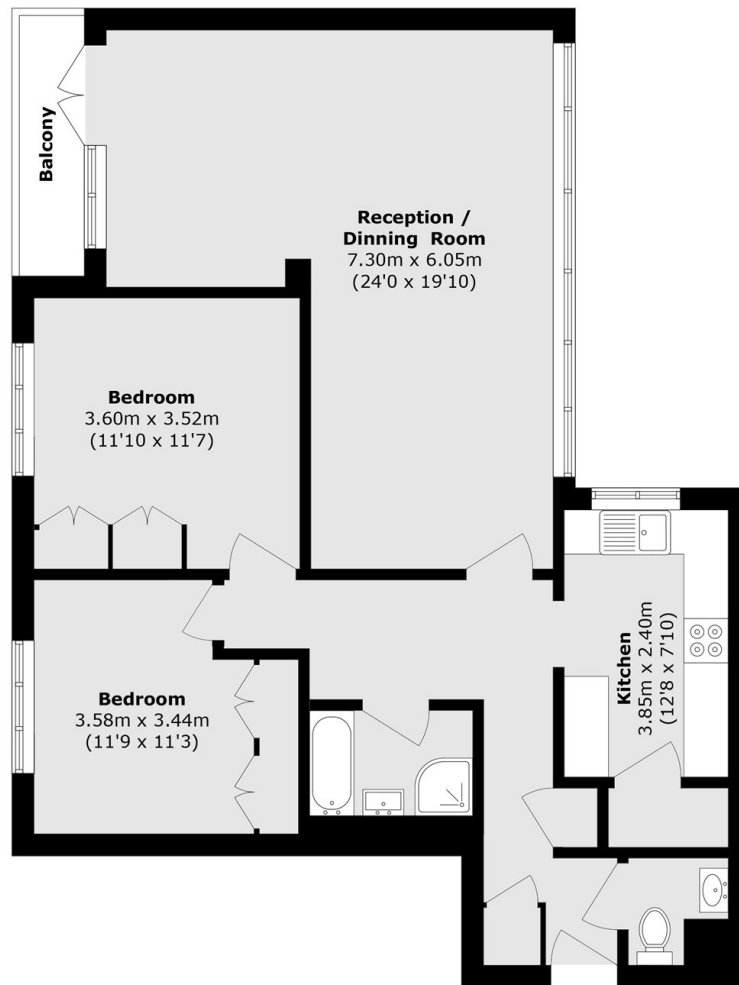

Total area (approx.): 89.3 sq. m (961.2 sq. ft)

Balcony area (approx.): 3.4 sq. m (36.6 sq. ft)