



Windsor Street

, Brighton BN1 1RJ

- Available NOW!
- Students Welcome
- Recently decorated
- Appliances Included
- One Double Bedroom
- Brand new wooden flooring
- Fantastic City Centre Location
- Company Lets Welcome!

£1,350 PCM



Local Authority Brighton &
Hove City Council
Council Tax Band B
EPC Rating D

SECOND FLOOR
366 sq.ft. (34.0 sq.m.) approx.

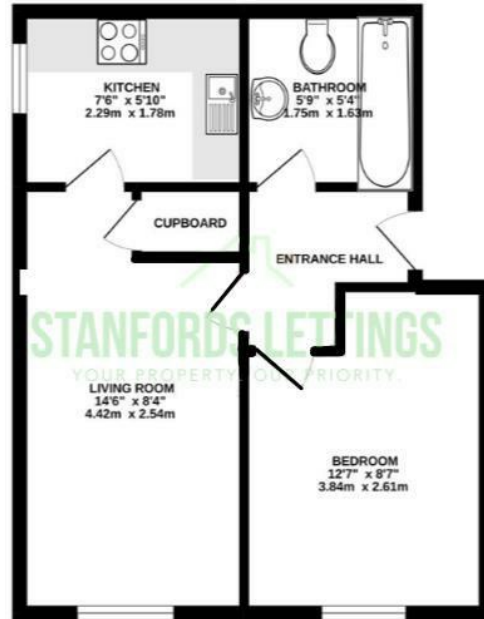

TOTAL FLOOR AREA - 366sq ft. (34.0 sq.m.) approx.

Whilst every attempt has been made to ensure the accuracy of the floorplan contained here, measurements of walls, windows, doors and any other details are approximate and no responsibility is taken for any error, omission or misstatement. This plan is for illustrative purposes only and should be used as such by any prospective purchaser. The services, systems and appliances shown have not been tested and no guarantee as to their operability or efficiency can be given.
Made with Roomplan 12/22

Stanfords Lettings Office
30-31 North Street, Brighton,
East Sussex, BN1 1EB

Contact
01273 733334
lettings@stanfords-
estates.com
www.stanfords-estates.com

Agents Note: Whilst every care has been taken to prepare these particulars, they are for guidance purposes only. All measurements are approximate and for general guidance purposes only and whilst every care has been taken to ensure accuracy, they should not be relied upon and potential buyers/tenants are advised to recheck the measurements.