



WHERE STANDARDS MATTER

Spencer Munson
41 High Road
South Woodford E18 2QP

Tel: 020 8989 3331

swoodford@spencermunson.co.uk
Website: spencermunson.co.uk



Diana Road, Walthamstow, E17

**** INTERNAL PHOTOS COMING SOON**** Spencer Munson are pleased to offer you this Newly Refurbished Two bedroom ground floor Warner style maisonette, Located next to Lloyds Park. The property features two generous double bedrooms, a good sized living room and a brand new kitchen and bathroom with ample storage. To the rear of the property is a own garden. Lloyds Park is just around the corner offering great green space, tennis courts, the William Morris Gallery and the famous Saturday market! Walthamstow Central and Walthamstow High Street is just a short walk away. Available now, EPC Rating C Council Tax band B

Rent: £1,995 - Monthly



Diana Road, Walthamstow, E17

Reception

Kitchen

Bedroom

Bedroom 2

Bathroom

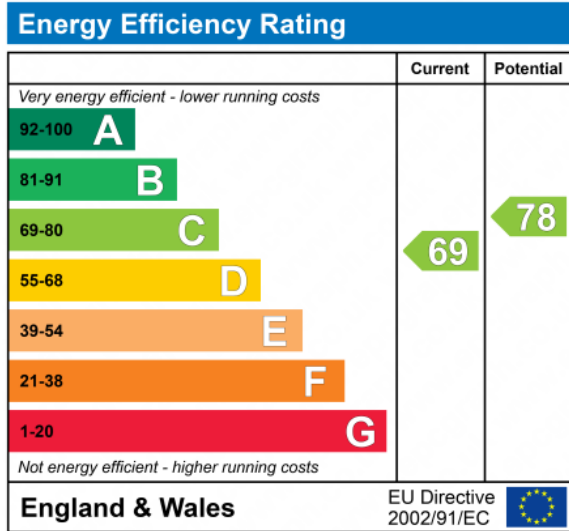

**** INTERNAL PHOTOS COMING SOON**** Spencer Munson are pleased to offer you this Newly Refurbished Two bedroom ground floor Warner style maisonette, Located next to Lloyds Park. The property features two generous double bedrooms, a good sized living room and a brand new kitchen and bathroom with ample storage. To the rear of the property is a own garden. Lloyds Park is just around the corner offering great green space, tennis courts, the William Morris Gallery and the famous Saturday market! Walthamstow Central and Walthamstow High Street is just a short walk away. Available now, EPC Rating C Council Tax band B

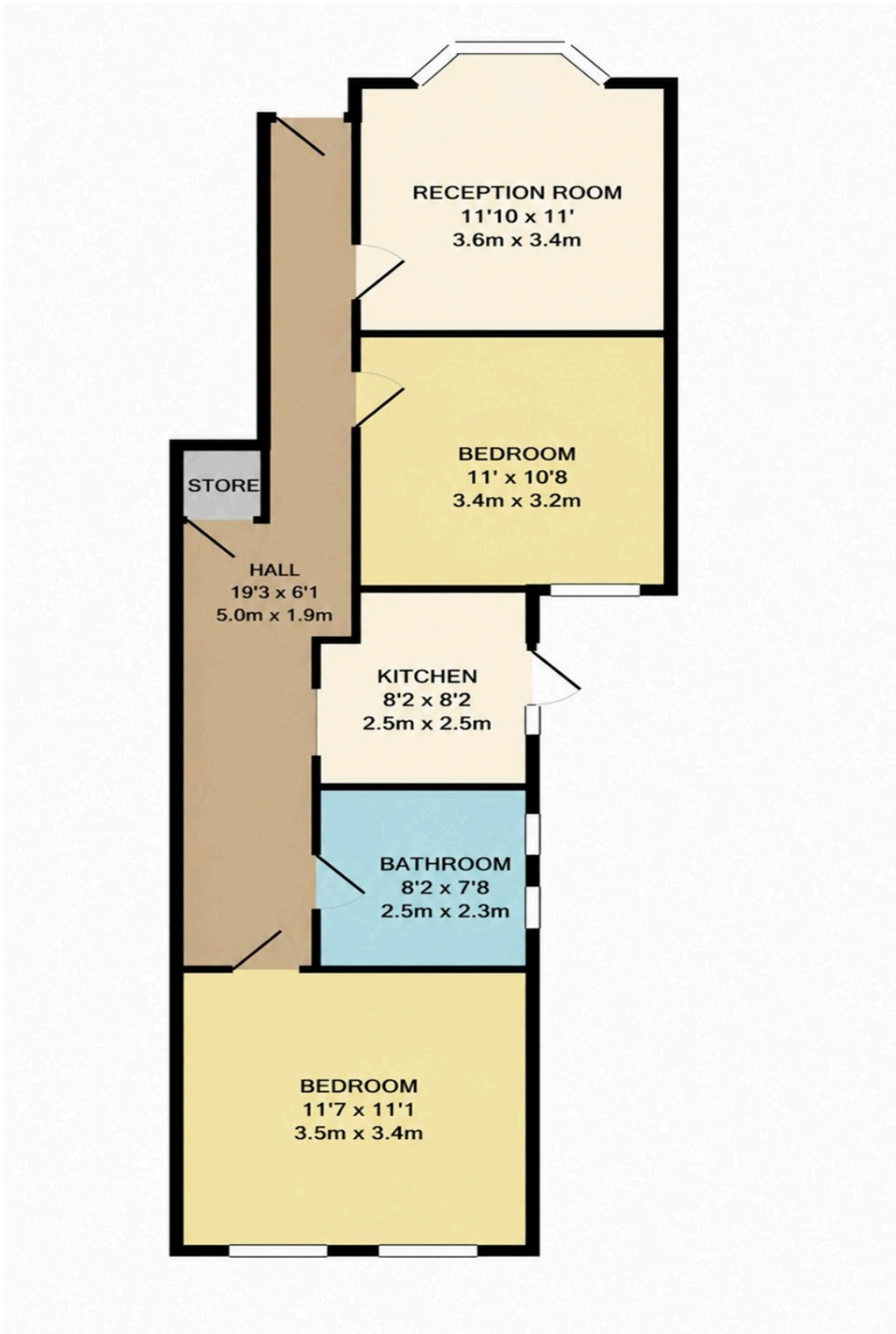
Diana Road, Walthamstow, E17**Disclaimer**

These particulars are intended to give a fair and substantially correct overall description for the guidance of intending tenants/purchasers and do not constitute an offer or part of a contract. Prospective tenants/purchasers and/or lessees should seek their own professional advice. All descriptions, dimensions, reference to condition, fixtures, fittings and necessary permissions for use and occupation and other details are given in good faith and are believed to be correct. However, intending tenants/purchasers should not rely on them as statements or representations of fact, but must satisfy themselves by inspection or otherwise as to the correctness of each of them. Fixtures and fittings shown in pictures and on viewings may well not be included in any tenancy/sale and any prospective tenant/purchaser must clarify this for themselves. All measurements and floorplans are approximate and produced as a guide in good faith. Please note that some of the furniture and decor items shown in these images have been digitally added using AI technology for illustrative purposes. The actual property may differ in appearance. Prospective buyers or renters are encouraged to visit the property in person to get an accurate representation.