



47 Allington Court Outwood Common Road, Billericay - CM11 2JB

£170,000 Leasehold

Council Tax band: B ~ EPC Energy Efficiency Rating: C

Contemporary throughout with spacious living area, complemented by a modern white kitchen complete with integrated appliances alongside the upgraded bathroom. The lounge overlooks the well tended gardens. Thoughtful amenities include a lift serving all floors, a communal drying room, and a dedicated guest suite for visiting family and friends. The development is renowned for its friendly atmosphere with regular social activities.



tyler estates

01277 626181

www.tylerestates.co.uk



Hallway

Kitchen

9' 0" x 8' 0" (2.74m x 2.45m)

Lounge

12' 8" x 11' 2" (3.85m x 3.41m)

Bedroom

12' 8" x 8' 11" (3.85m x 2.72m)

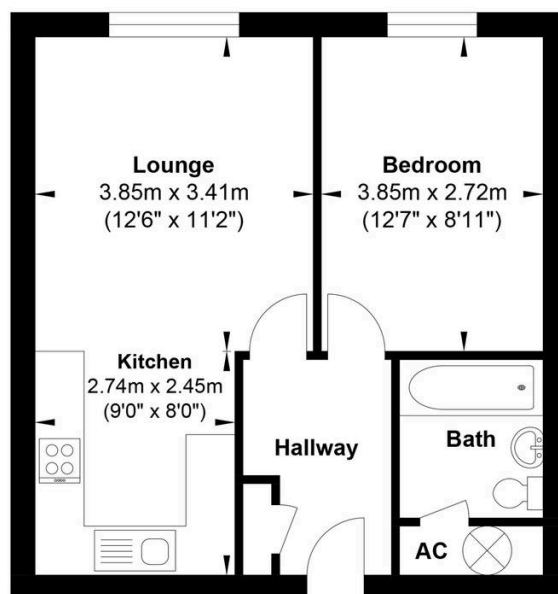

Ground Floor

Gross Internal Floor Area : 41.06 m2 ... 441.96 ft2

Whilst every attempt has been made to ensure the accuracy of the floor plan contained here, measurements of doors, windows, rooms and any other items are approximate and no responsibility is taken for any error, omission, or mis-statement. This plan is for illustrative purposes only and should be used as such by any prospective purchaser. The services, systems and appliances shown have not been tested and no guarantee as to their operability or efficiency can be given.