

## Flat A, 15 Homeland Road, King's Lynn PE30 2QR

£135,000

 2  1  1



Whether you're looking to take your first step onto the property ladder or seeking a high-quality addition to your portfolio, this generously proportioned apartment is move-in ready and packed with appeal. This property ticks all the right boxes for first-time buyers and savvy investors alike.

## Key Features

- Ground Floor Flat
- Move in Ready
- Open Plan Living/Kitchen/Dining Room
- Gas Central Heating
- Close to Town Centre and Train Station
- Two Bedrooms
- Ideal First Home or Potential Investment Opportunity
- Contemporary Shower Room
- Allocated Parking
- Leasehold - Over 100 Years Remaining

GROUND FLOOR  
617 sq.ft. (57.4 sq.m.) approx.

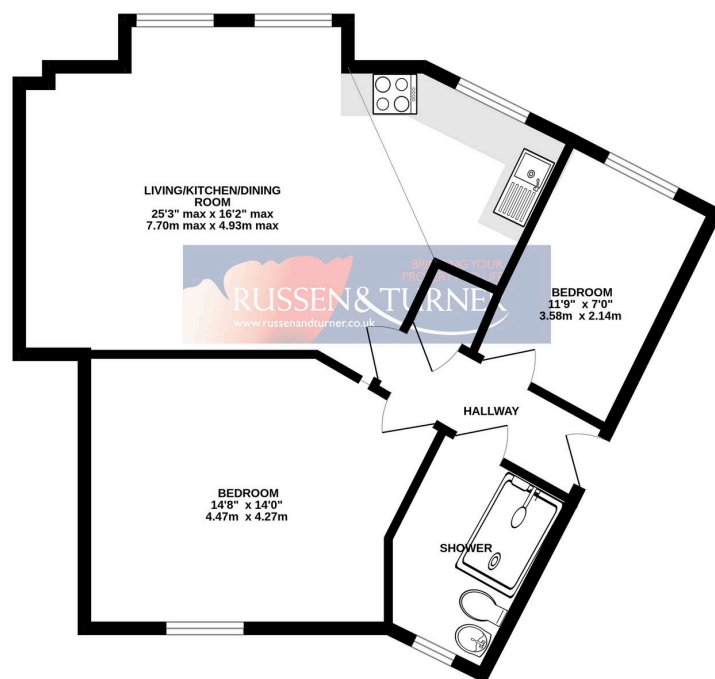

TOTAL FLOOR AREA: 617 sq.ft. (57.4 sq.m.) approx.

Whilst every attempt has been made to ensure the accuracy of the floorplan contained here, measurements of doors, windows, rooms and any other items are approximate and no responsibility is taken for any error, omission or mis-statement. This plan is for illustrative purposes only and should be used as such for any prospective purchaser. The services, systems and appliances shown have not been tested and no guarantee as to their operability or efficiency can be given.  
Made with Metropix ©2025