

HENDERSON CONNELLAN

ESTATE AGENTS



Lomond Drive, Kettering NN15

"Versatility and Modern Comfort"

"Versatility and Modern Comfort"

Nestled in a desirable Kettering location, this beautifully presented three-bedroom semi-detached home offers a versatile layout perfect for contemporary living, with excellent proximity to local amenities and schools. Featuring gas central heating and UPVC double glazing, this property boasts an entrance hallway leading to a well-equipped kitchen, a comfortable living room with a feature fireplace, a formal dining room, and an upgraded, all-season conservatory. Upstairs, there are three bedrooms and a modern shower room. Externally, a block-paved driveway provides off-road parking, while a large timber structure offers additional storage. The former garage has been cleverly converted into a versatile room, currently a gym, and the landscaped rear garden provides a decked seating area, lawn, and a charming patio.

Living Room - 3.91m x 3.07m (12'10" x 10'1")

Dining Room - 3.25m x 2.77m (10'8" x 9'1")

Kitchen - 3.15m x 2.24m (10'4" x 7'4")

Conservatory - 3.23m x 2.62m (10'7" x 8'7")

Gym - 5.56m x 2.84m (18'3" x 9'4")

Bedroom One - 3.84m x 3.02m (12'7" x 9'11")

Bedroom Two - 3.43m x 3.1m (11'3" x 10'2")

Bedroom Three - 2.9m x 2.03m (9'6" x 6'8")

Shower Room - 1.88m x 1.85m (6'2" x 6'1")

EPC RATING: D COUNCIL TAX: B





Ground Floor

Approx. 60.8 sq. metres (654.7 sq. feet)

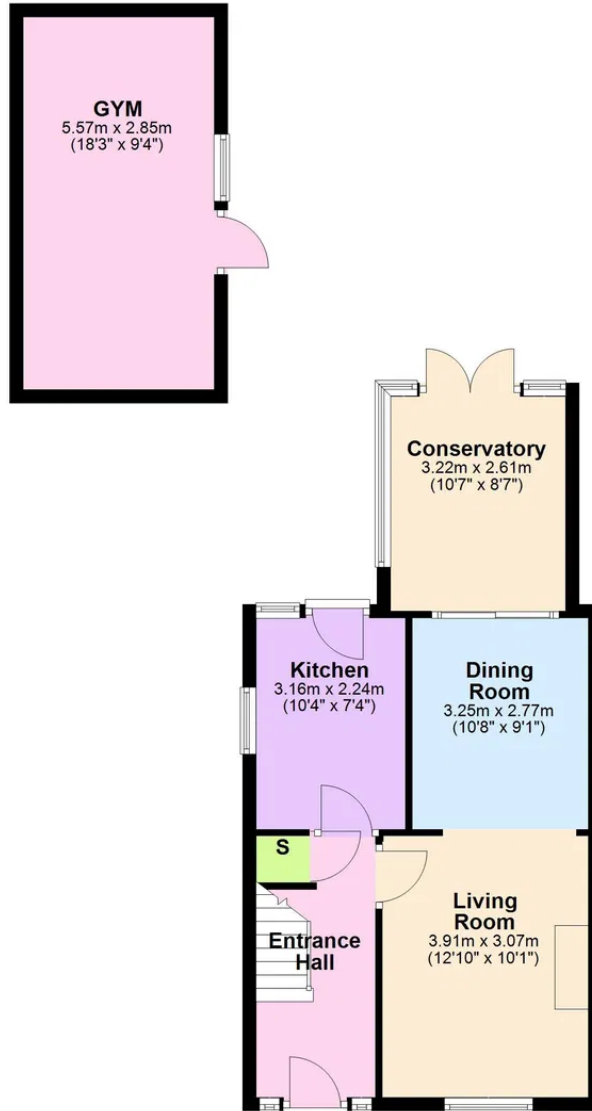

First Floor

Approx. 36.1 sq. metres (389.0 sq. feet)

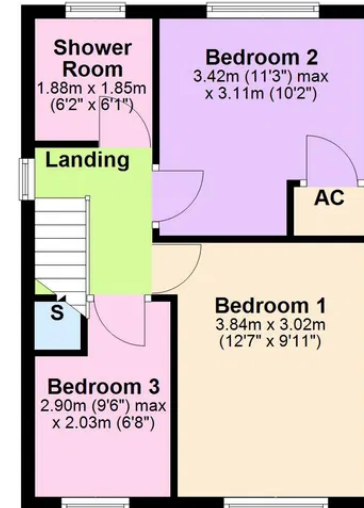

Total area: approx. 97.0 sq. metres (1043.6 sq. feet)

Henderson Connellan Kettering office 01536 417888 ketteringsales@hendersonconnellan.co.uk



Disclaimer: These particulars do not form part of any offer or contract and should not be relied upon as statements or representations of fact. Any areas, measurements of distances are approximate. The text, photographs and plans are for guidance only and are not necessarily comprehensive.

