



Burns Road, Kettering **Freehold** £260,000 O.I.E.O.

**Pattison  
Lane**

# Key Features

 3  2  D  C

- Three Bedroom Semi Detached Home
- En Suite to Master Bedroom
- Bay Fronted
- Large Kitchen Opening to Dining / Family Room
- Beautifully Presented Throughout

Tucked away in a quiet cul-de-sac within the highly sought-after "North End" of Kettering, this stunning bay-fronted residence has been thoughtfully extended and modernised.

The property boasts a significant ground-floor extension, creating an exceptional hub for entertaining, alongside a professionally executed loft conversion.



The accommodation is accessed via a side entrance leading into a welcoming hallway. To the front, a sophisticated lounge is bathed in natural light from the large character bay window. To the rear, the home opens into an expansive, open-plan kitchen, dining, and family room. This impressive space features vaulted ceilings with exposed timber beams and Velux-style windows, creating a bright and airy atmosphere.

The first floor offers two well-proportioned bedrooms and a contemporary refitted family bathroom. The second floor is dedicated entirely to a generous master suite, providing a private sanctuary complete with a modern en-suite shower room.

Externally, the property benefits from a private, beautifully landscaped rear garden.

The accommodation comprises:

ENTRANCE HALL

LOUNGE 12'2 x 10'6 plus bay (3.70m x 3.20m)

KITCHEN 12'2 x 10' (3.70m x 3.04m)



GROUND FLOOR

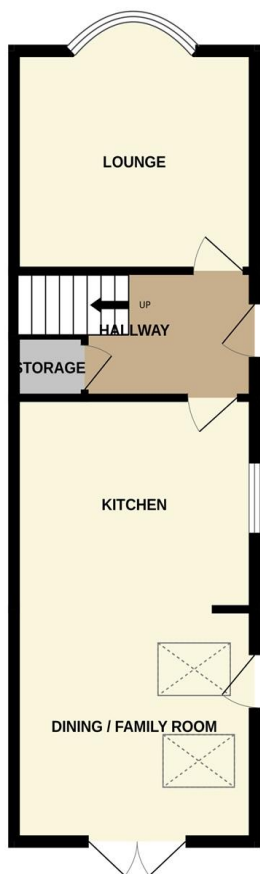

1ST FLOOR

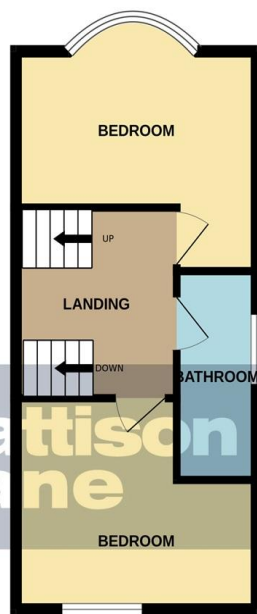

2ND FLOOR

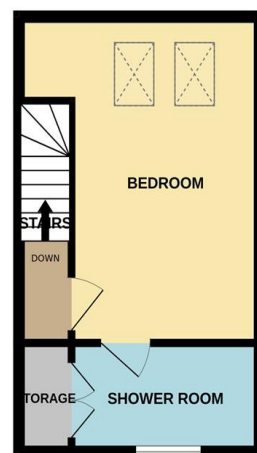

Whilst every attempt has been made to ensure the accuracy of the floorplan contained here, measurements of doors, windows, rooms and any other items are approximate and no responsibility is taken for any error, omission or mis-statement. This plan is for illustrative purposes only and should be used as such by any prospective purchaser. The services, systems and appliances shown have not been tested and no guarantee as to their operability or efficiency can be given.  
Made with Metropix ©2026

DINING ROOM 12'1 x 11' (3.68m x 3.35m)

FIRST FLOOR LANDING

BEDROOM TWO 12'2 x 7'3 plus recess (3.70m x 2.20m)

BEDROOM THREE 12'2 x 10' max (3.70m x 3.04m)

BATHROOM

SECOND FLOOR

BEDROOM ONE 15'6 x 10'8 max (4.72m x 3.25m)

EN SUITE

OUTSIDE

FRONT GARDEN

REAR GARDEN

To view this property call Pattison Lane on:  
**01536 524425**

# Selling your property?



SCAN ME

Contact us to arrange a **FREE** home valuation.

 01536 524425

 68-70 Gold Street, Kettering, Northamptonshire, NN16 8JB

 [kettering@pattisonlane.co.uk](mailto:kettering@pattisonlane.co.uk)

 [www.pattisonlane.co.uk](http://www.pattisonlane.co.uk)



SCAN ME



Sharman Quinney Holdings Limited is registered in England and Wales under company number 4174227, Registered Office is Cumbria House, 16-20 Hockliffe Street, Leighton Buzzard, Bedfordshire, LU7 1GN. VAT Registration Number is 500 2481 05.

1: These particulars do not constitute part or all of an offer or contract. 2: The measurements indicated are supplied for guidance only and as such must be considered incorrect. 3: Potential buyers are advised to recheck the measurements before committing to any expense. 4: Sharman Quinney has not tested any apparatus, equipment, fixtures, fittings or services and it is the buyers interests to check the working condition of any appliances. 5: Sharman Quinney has not sought to verify the legal title of the property and buyers must obtain verification from their legal representative. 6: Intending purchasers will be asked to produce identification documentation at a later stage and we would ask your co-operation in order that there will be no delay in agreeing the sale. Ref: KPL206858 - 0002

