

These particulars have been prepared as accurately and as reliably as possible, but should not be relied upon as 'statement of fact'. If there is any point which is of particular importance to you, please contact the office and we would be pleased to check the information. We have not tested any services, appliances, equipment or facilities and nothing in these particulars should be deemed to be a statement that they are in good working order, or that the property is in good structural condition or otherwise. Any areas, measurements, floor plans or distances referred to are given as a guide only and are not precise. Purchasers must satisfy themselves by inspection or by otherwise regarding the items mentioned above and as to the correctness of each of the statements contained in these particulars. No person in the employment of Ashtons has any authority to make or give any representation or warranty whatsoever in relation to this property or these particulars nor enter into any contract relating to the property on behalf of the vendor.

While every effort has been made to ensure the accuracy of the description of the property and any other areas and appliances, it is not intended to be used as a guide only. Purchasers must satisfy themselves by inspection or by otherwise regarding the items mentioned above and as to the correctness of each of the statements contained in these particulars. No person in the employment of Ashtons has any authority to make or give any representation or warranty whatsoever in relation to this property or these particulars nor enter into any contract relating to the property on behalf of the vendor.

- EPC - C
- No Onward Chain
- Convenient Location
- Popular Development
- Allocated Parking
- Private Garden
- One Double Bedroom
- Ground Floor Apartment

Leasehold
Council Tax Band - A

Kettlestring Lane Clifton Moor, York YO30 4XF

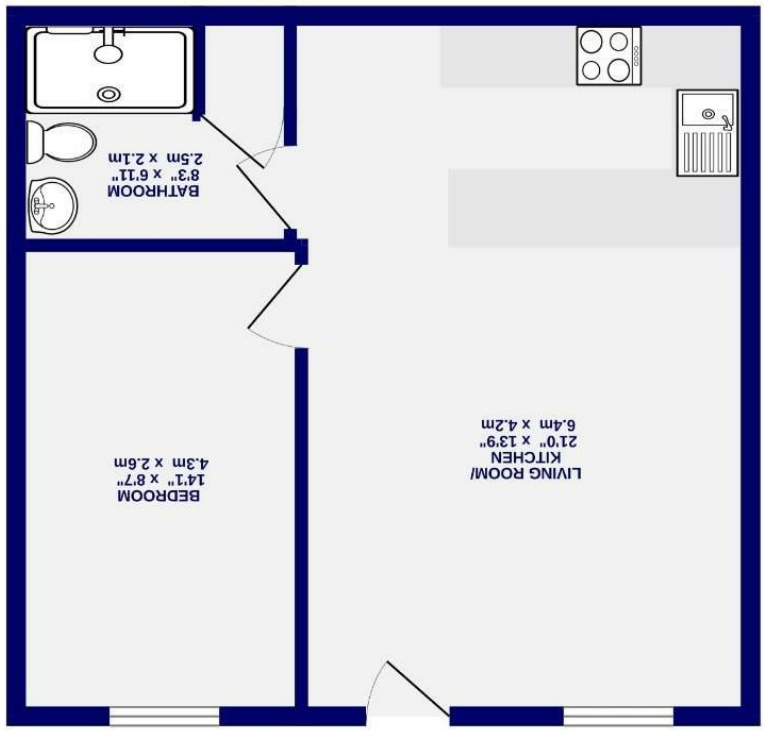

GROUND FLOOR
461 sq.ft. (42.9 sq.m.) approx.



Kettlestring Lane
Clifton Moor, York
YO30 4XF

£140,000



Located within a well maintained development and ideally suited to first time buyers or investors, this attractive ground floor one bedroom apartment enjoys a convenient position close to Clifton Moor Retail Park, the York outer ring road and excellent transport links into the historic city centre.

The property is accessed via its own private entrance and offers well planned accommodation comprising a spacious open plan living kitchen with fitted appliances and lounge area, a generous double bedroom and a modern three piece shower room. Externally, the apartment benefits from a designated parking space, along with access to communal areas, bin and bike stores and visitor parking.

Presented in good condition throughout, this is a fantastic opportunity to purchase a ready to move into home in a popular location and an internal viewing is highly recommended.

A selection of rooms have been dressed using AI for illustrative purposes.

Leasehold
Length of lease- 241 years remaining
Ground rent - £295.95 PA
Service Charge- £977.81 PA

Council Tax Band A

