



**£375,000 Offers Over**  
Sheepcote Cottages, Stourbridge Road, Bromsgrove B61

**GUEST**  
ESTATE AGENTS



Charming Georgian three bedroom mid-terrace cottage  
Generous south facing rear garden  
Character features including fireplaces & solid wood flooring  
Spacious living and dining rooms  
Log burner to living room  
Fitted kitchen with integrated appliances  
Quirky and characterful layout  
Large integral garage

Full of charm and individuality, this delightful three bedroom Georgian mid terrace offers a rare opportunity to acquire a character home with a truly generous south facing garden extending to approximately 43 metres. Tucked away in a well-established residential setting, the property blends period features with practical living space, while its slightly unconventional layout adds to its unique appeal.

This Georgian terrace immediately stands out for its character and individuality, offering a layout that is both practical and full of personality. The property is approached via an enclosed double-glazed porch which leads into a central hallway, from which all ground floor accommodation radiates.

To the left of the hallway is access to the integral garage, a highly convenient feature that provides secure storage or potential for further use, subject to requirements.

To the rear of the property are the principal reception rooms, both enjoying a bright south facing aspect. The dining room is a particularly appealing space, featuring a beautiful decorative fireplace that creates an elegant focal point. Solid wood flooring adds warmth and continuity, while patio doors with glazed side panels open onto the garden and allow natural light to flood the room, ideal for both everyday use and entertaining. Adjacent to this, the living room continues the theme of character and comfort, with a feature fireplace housing a log burner. A large window and a further door, positioned where one might expect the main entrance, lead directly onto the garden, adding to the home's unique and slightly quirky charm. This unusual arrangement is a defining feature of the property and one that many buyers find especially appealing.

The kitchen is fitted with matching wall and base units and includes integrated appliances such as a dishwasher, fridge freezer, oven, gas hob and extractor. Tiled flooring provides a practical finish, and the space is well arranged for day-to-day use. The staircase to the first floor is accessed from the kitchen, another distinctive feature that enhances the home's individuality.

Upstairs, the property continues to impress with three well-proportioned



Charming Georgian three bedroom mid-terrace cottage  
Generous south facing rear garden  
Character features including fireplaces & solid wood flooring  
Spacious living and dining rooms  
Log burner to living room  
Fitted kitchen with integrated appliances  
Quirky and characterful layout  
Large integral garage

Full of charm and individuality, this delightful three bedroom Georgian mid terrace offers a rare opportunity to acquire a character home with a truly generous south facing garden extending to approximately 43 metres. Tucked away in a well-established residential setting, the property blends period features with practical living space, while its slightly unconventional layout adds to its unique appeal.

This Georgian terrace immediately stands out for its character and individuality, offering a layout that is both practical and full of personality. The property is approached via an enclosed double-glazed porch which leads into a central hallway, from which all ground floor accommodation radiates. To the left of the hallway is access to the integral garage, a highly convenient feature that provides secure storage or potential for further use, subject to requirements.

To the rear of the property are the principal reception rooms, both enjoying a bright south facing aspect. The dining room is a particularly appealing space, featuring a beautiful decorative fireplace that creates an elegant focal point. Solid wood flooring adds warmth and continuity, while patio doors with glazed side panels open onto the garden and allow natural light to flood the room, ideal for both everyday use and entertaining. Adjacent to this, the living room continues the theme of character and comfort, with a feature fireplace housing a log burner. A large window and a further door, positioned where one might expect the main entrance, lead directly onto the garden, adding to the home's unique and slightly quirky charm. This unusual arrangement is a defining feature of the property and one that many buyers find especially appealing.

The kitchen is fitted with matching wall and base units and includes integrated appliances such as a dishwasher, fridge freezer, oven, gas hob and extractor. Tiled flooring provides a practical finish, and the space is well arranged for day-to-day use. The staircase to the first floor is accessed from the kitchen, another distinctive feature that enhances the home's individuality.

Upstairs, the property continues to impress with three well proportioned



# Floorplan

## Ground Floor

Approx. 75.3 sq. metres (810.9 sq. feet)

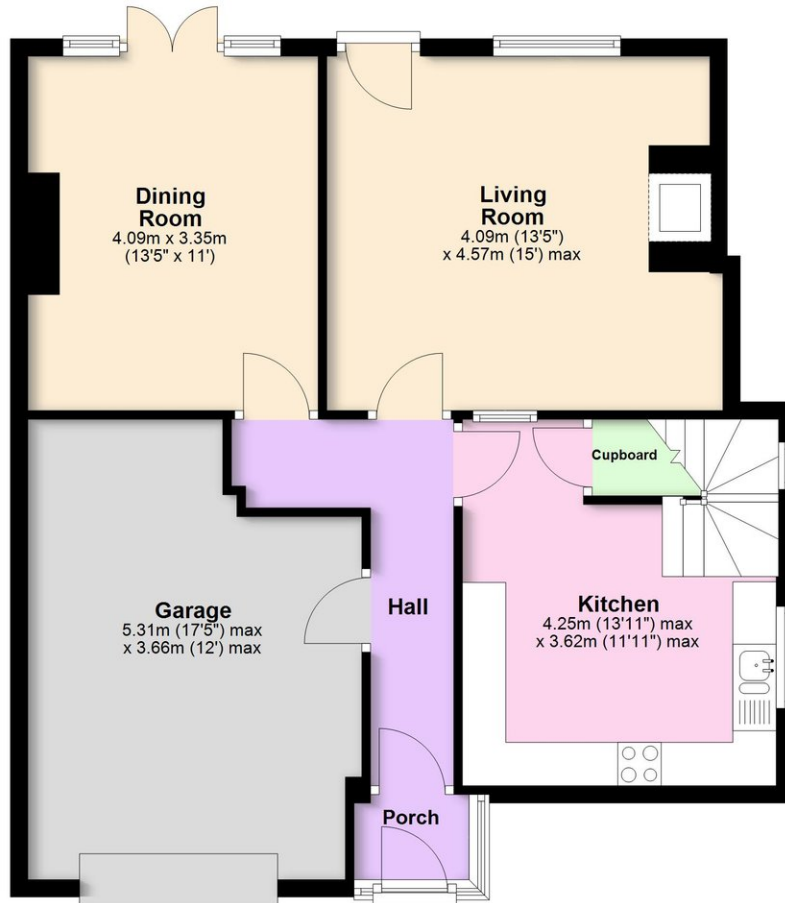

## First Floor

Approx. 52.0 sq. metres (559.5 sq. feet)



Total area: approx. 127.3 sq. metres (1370.4 sq. feet)

Whilst every attempt has been made to ensure the accuracy of this floorplan, measurements of doors, windows, rooms and any other item are approximate, and no responsibility is taken for any error, omission, or mis-statement. This plan is for illustrative purposes only and should be used as such by any prospective purchaser.  
Plan produced using PlanUp.

## Want to view this property?

Call us on 01527 306420, or email [hello@guestestateagents.com](mailto:hello@guestestateagents.com)

## Property to sell?

Guest Estate Agents can offer you an outstanding level of service, successfully selling property in and around Bromsgrove. For a free valuation, call us on 01527 306420, or email [hello@guestestateagents.com](mailto:hello@guestestateagents.com)

## Independent mortgage advice

We recommend Guest Independent Mortgage Advice. Call 01527 306425, or email [hello@guestindependent.com](mailto:hello@guestindependent.com) to arrange an initial chat with no pressure or obligation.

## Solicitor / Conveyancer

Getting the right firm to do the legal work can make or break a sale. Just ask us for a recommendation / quote,

## Lettings

For fully managed lets or just a tenant find, we recommend Douglas Lettings. More info at [www.douglaslettings.co.uk](http://www.douglaslettings.co.uk)

## Everything else

For surveys, removals, EPCs, or any other property related needs, we can recommend someone reliable to help you.

## Our contact details

Phone: 01527 306420

Email: [hello@guestestateagents.com](mailto:hello@guestestateagents.com)

Address: 1 St Godwald's Road, Aston Fields, Bromsgrove B60 3BN

## Disclaimer

You should not rely on statements made by Guest Estate Agents in these details, or by word of mouth, or in writing, as being factually accurate about the property, its condition, or its value. The tenure needs to be verified via your solicitors. Areas, measurements and distances are approximate. Any reference to alterations or extensions, or use of, or any part of the property does not mean that the necessary planning, building regulations or any other consent has been obtained. A buyer must find out by inspection or other ways to verify that these matters have been dealt with and that the information is correct.

