



Victoria Road, W3

£220,000

A studio flat within a purpose built development walking distance to North Acton Station and Elizabeth Line. The property comprises a separate kitchen and ample storage. Poulton Court would make a perfect apartment for a first time buyer or investor.

Poulton Court is conveniently located on Victoria Road which is directly opposite the North Acton Tube Station (Central Line) and also offers local shops and cafe's.

Features

- Purpose Built Development
- Studio Apartment
- Separate Kitchen
- Lift Access
- North Acton Station
- No Onwards Chain

Victoria Road,
London, W3

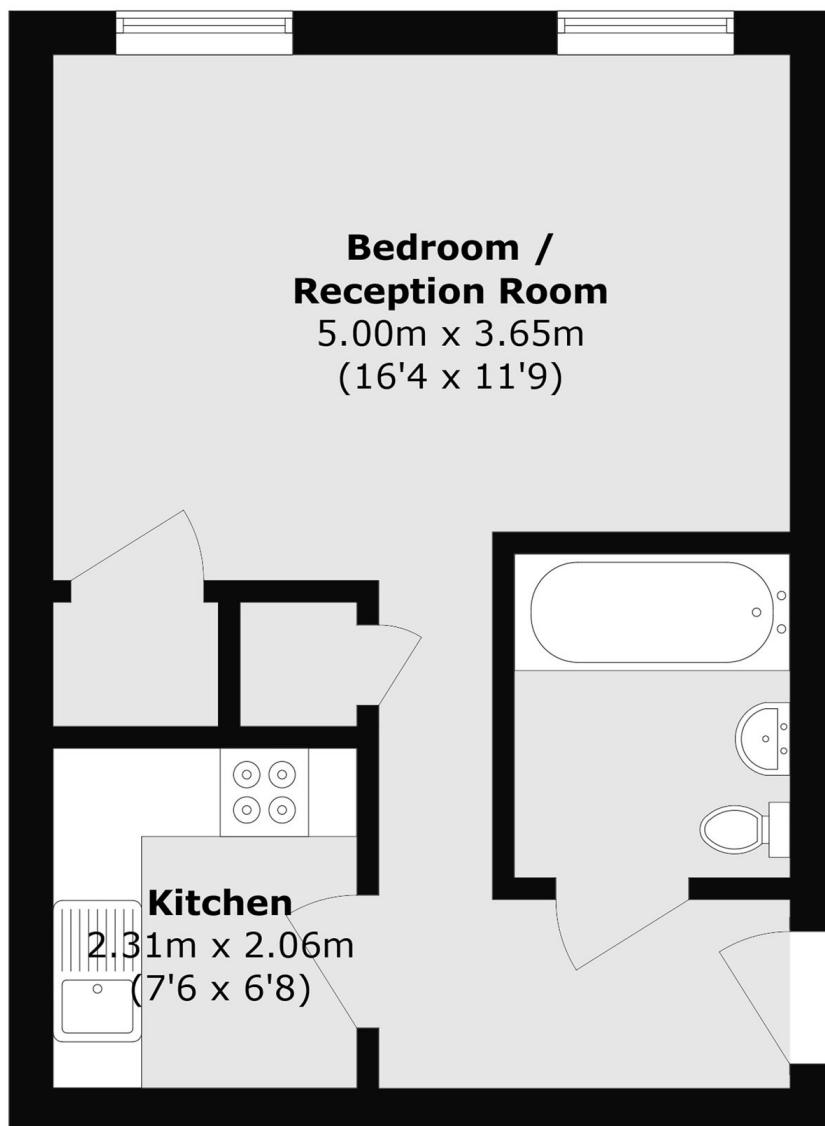

Total area (approx.): 35.1 sq. m (377.8 sq. ft)