



16 Kirkdale Drive, Royton, Oldham, OL2 5TG

£375,000

3 1 2



- No Chain
- Three Bedrooms
- Fitted Bedrooms
- Large Garden/Garage
- Detached True Bungalow
- Large Lounge/Dining Room
- Great Location
- EPC:



NO CHAIN. Offered for sale is this three bedroom detached true bungalow located on one of the most popular roads in 'Thorpe', Royton.

A very spacious bungalow that boasts a good size plot and in the shadow of Tandle Hill Country Park.

Accommodation comprising: Entrance hallway, large lounge/ dining room, conservatory, kitchen/breakfast room, rear porch, three bedrooms and a shower room.

Externally is a good size plot with fruit trees and a patio.

Built in garage and a large driveway to the front.

Royton centre within easy reach.

C

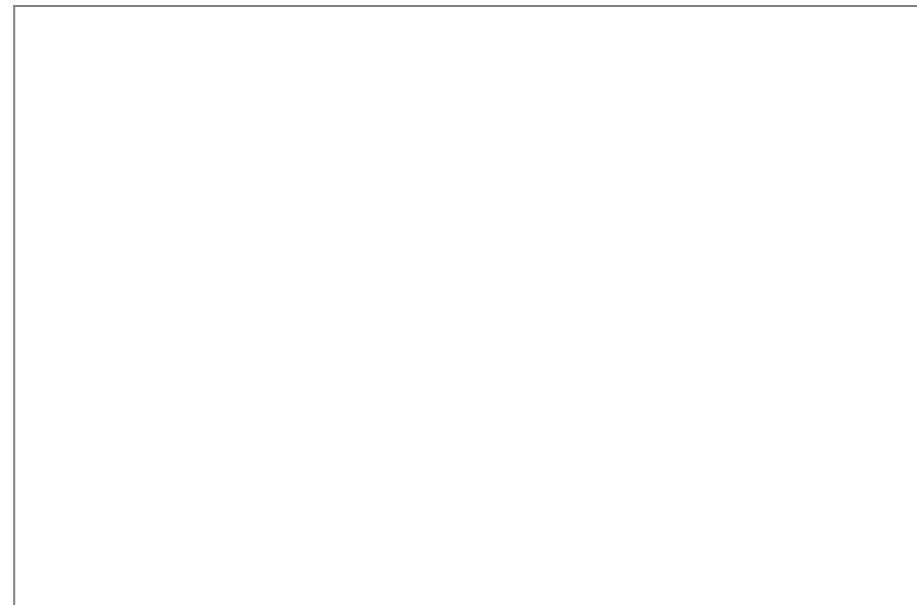
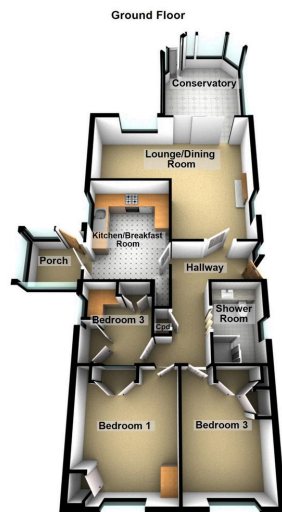

Chadderton Office

509 Middleton Road,
Chadderton, Oldham,
OL9 9SH

chadderton@kirkham-property.co.uk

t: 0161 626 5688

www.kirkham-property.co.uk