

Maritime Court, Taylors Avenue, Cleethorpes
Approximate Gross Internal Area
747 Sq Ft/69 Sq M

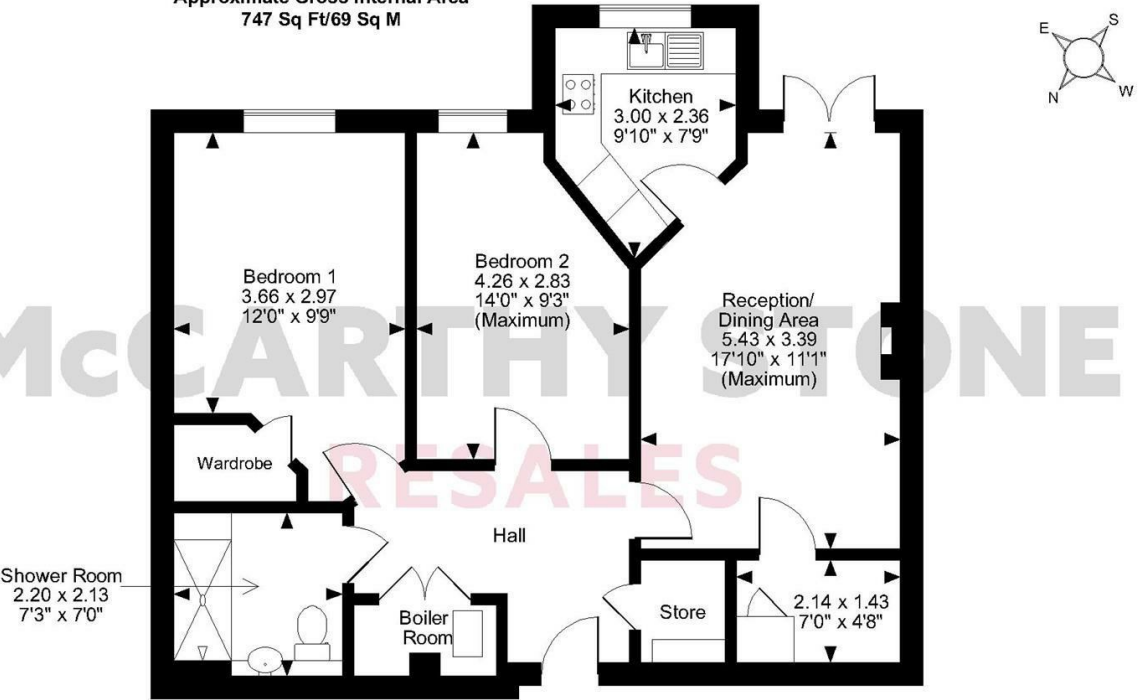

Ground Floor

FOR ILLUSTRATIVE PURPOSES ONLY - NOT TO SCALE
The position & size of doors, windows, appliances and other features are approximate only.
© ehouse. Unauthorised reproduction prohibited. Drawing ref. dig/8562692/MSS

Council Tax Band: C



Energy Efficiency Rating		
	Current	Potential
Very energy efficient - lower running costs		
(92 plus) A		
(81-91) B	89	89
(69-80) C		
(55-68) D		
(39-54) E		
(21-38) F		
(1-20) G		
Not energy efficient - higher running costs		
England & Wales	EU Directive 2002/91/EC	

20 Maritime Court

Taylors Avenue, Cleethorpes, DN35 0AP



Asking price £219,999 Leasehold

A WELL PRESENTED TWO BEDROOM GROUND FLOOR APARTMENT WITH PATIO
AREA SITUATED WITHIN MARITIME COURT RETIREMENT DEVELOPMENT.

This floor plan is not drawn to scale and is for illustrative purposes only. Any measurements, floor areas (including any total floor area), openings and orientation are approximate and for guidance only. McCarthy Stone Resales do not take liability for any error, omission or misstatement. All parties must rely on their own inspections. It should not be assumed that any furniture or fittings contained in the photographs are included in any sale. All details referring to time and distances to localities are approximate. Details regarding any common charges and other applicable fees are provided by the seller and should not be relied on without verification and further checks made through a solicitor/conveyancer. Please contact the Property Consultant for further information that Appliances (including central heating) have not been tested, therefore it cannot be assumed that they are in good working order. All interested parties are advised to check availability and make an appointment before travelling to view the property to avoid disappointment or wasted time or travel expenses. The details contained within this brochure are for information purposes only and do not form part of any agreement. All purchases will be subject to contract terms. © All artwork (photos and floorplans) and written content are the sole property and copyright of McCarthy & Stone Resales Limited and are legally protected by UK & International copyright laws. Under no circumstance may you download, reproduce, publish or distribute any content for commercial purposes, without prior written permission from McCarthy Stone Resales. Unauthorised duplication or usage for commercial purposes is prohibited by the Copyright law and will be prosecuted.



Call us on 0345 556 4104 to find out more.

resales@mccarthyandstone.co.uk | mccarthyandstoneresales.co.uk

Maritime Court, Taylors Avenue, Cleethorpes

Maritime Court was built and designed by McCarthy & Stone for retirement living. The dedicated House Manager is on site during working hours to take care of things and make you feel at home. There's no need to worry about the burden of maintenance costs as the service charge covers the cost of all external maintenance, gardening and landscaping, external window cleaning, buildings insurance, water rates and security systems. All energy costs of the homeowners lounge and other communal areas are also covered in the service charge. For your peace of mind the development has camera door entry and 24-hour emergency call systems, should you require assistance. The Homeowners' lounge provides a great space to socialise with friends and family. If your guests have travelled from afar, they can extend their stay by booking into the development Guest Suite (usually for a fee of £25 per night - subject to availability). It is a condition of purchase that residents must meet the age requirement of 60 years or over.

Local Area

Maritime Court is located in Cleethorpes, a modern thriving town, famed as a popular holiday resort on the East Coast. It offers a wealth of attractions, miles of sandy beaches and vibrant flower filled promenade all of which have been honored with many awards over the years. The town centre hosts a wide range of shops and amenities including several banks, a pharmacy, a wealth of cafes and bistros as well as a selection of convenience stores and a small supermarket. A large supermarket is located out of the town centre along Hewitts Avenue just 5 miles away Grimsby offers a further selection of shops and facilities.

Entrance Hall

Front door with spy hole leads to the large entrance hall - the 24-hour Tunstall emergency response pull cord



system is situated in the hall. From the hallway there is a door to a walk-in storage cupboard/airing cupboard. Illuminated light switches, smoke detector, apartment security door entry system with intercom and emergency pull cord located in the hall. Doors lead to the lounge, bedrooms and shower room.

Lounge

A spacious lounge with the benefit of patio doors leading to a private patio area. There is ample space for dining and a feature electric fire and surround which acts as an attractive focal point. TV and telephone points, Sky/Sky+ connection point, two ceiling lights, fitted carpets and raised electric power sockets. Door leading to a storage cupboard with shelving and additional partially glazed door leads onto a separate kitchen.

Kitchen

Fully tiled and fitted kitchen with a range of modern low and eye level units and drawers with work surface. Stainless steel sink with mono lever tap, drainer and UPVC double glazed window above which overlooks communal grounds. Eye level oven, ceramic hob, cooker hood and integral fridge freezer.

Bedroom

Double bedroom with door to walk-in wardrobe housing shelving and hanging rails. TV and telephone points, Sky/Sky+ connection point, ceiling light, fitted carpets and raised electric power sockets.

Bedroom Two

A second bedroom with TV and telephone points, ceiling light, fitted carpets and raised electric power sockets.

Shower Room

Fully tiled and fitted with suite comprising of level access double shower with glass screen. Low level WC,



2 bed | £219,999

vanity unit with wash basin and mirror above. Shaving point, electric heater and extractor fan.

Service Charge

- Cleaning of communal windows
- Water rates for communal areas and apartments
- Electricity, heating, lighting and power to communal areas
- 24-hour emergency call system
- Upkeep of gardens and grounds
- Repairs and maintenance to the interior and exterior communal areas
- Contingency fund including internal and external redecoration of communal areas
- Buildings insurance

The service charge does not cover external costs such as your Council Tax, electricity or TV. Find out more about service charges please contact your Property Consultant or House Manager.

Service charge £3,785.40 per annum (for financial year end 30th June 2024)

Car Parking Permit Scheme-subject to availability

Parking is by allocated space, please check with the House Manager on site for availability. The fee is usually £250 per annum, but may vary by development. Permits are available on a first come, first served basis.

Leasehold

999 years from 2018

Ground rent: £495 per annum

Ground rent review: Jan-31

