



OAKWAYS, SE9

£2,500 per month

Five bedroom town house
Three double bedrooms
Two bathrooms
Fitted kitchen
Private garden
Energy rating: d

@marshandparsons
marshandparsons.co.uk

MARSH &
PARSONS



ABOUT THE PROPERTY

Well-presented five bedroom townhouse within walking distance of Eltham High Street. Features a ground floor with cloakroom/WC, shower, utility room, and two bedrooms; a first floor with spacious lounge, dining room, and fitted kitchen; and a top floor with a master bedroom, two further double bedrooms, and a single bedroom. Also benefits from a rear garden and front driveway.

Closest station is Eltham offering national line services.



STEP INSIDE OAKWAYS

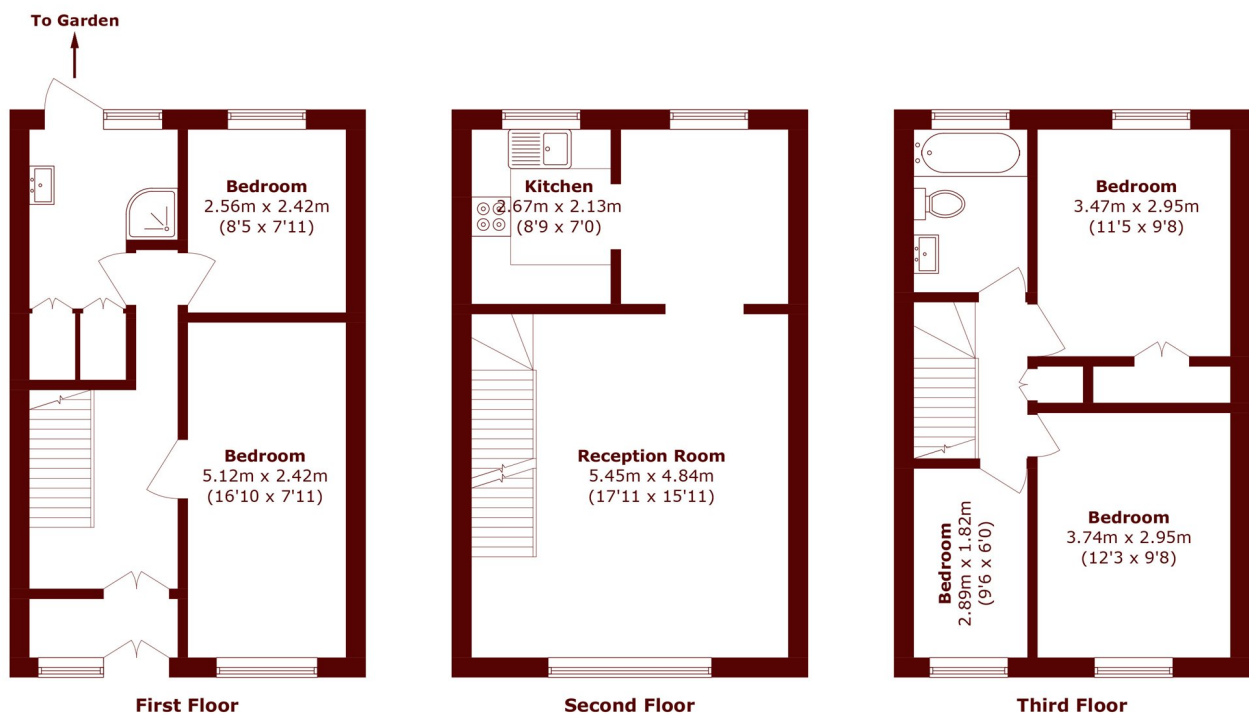

Total area (approx.): 117.2 sq. m (1261.5 sq. ft)

Lee
020 8296 1628

Energy Rating: D We aim to make our particulars both accurate and reliable. However, they are not guaranteed; nor do they form part of an offer or contract. If you require clarification on any points then please contact us, especially if you're traveling some distance to view. Please note that appliances and heating systems have not been tested and therefore no warranties can be given as to their good working order

MARSH &
PARSONS