

# Andrew Stevens

Estate & Letting Agents



22 Rowley Road, Tottenham, London, N15 3AX

£729,995

- Newly Renovated 4 Bedroom House
- Front and Rear Gardens
- New Fully Fitted Kitchen
- Close to Shops
- 2 Family Bathrooms

### 22 Rowley Road- N15 3AX

Approximate Gross Internal Area 98.0 m<sup>2</sup> ... 1054 ft<sup>2</sup> (excluding garden)

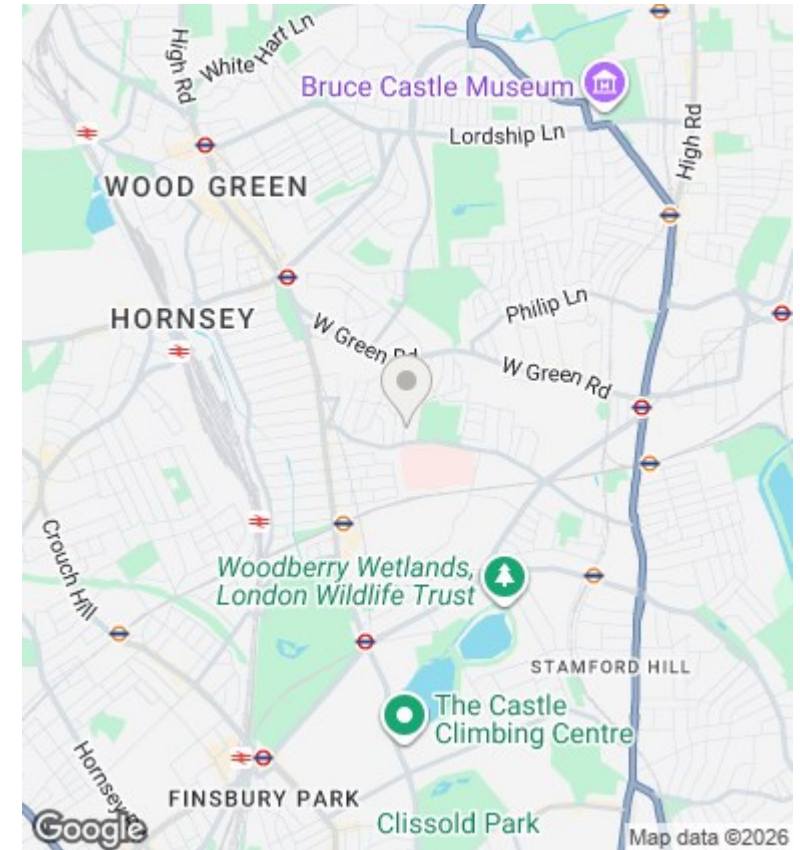
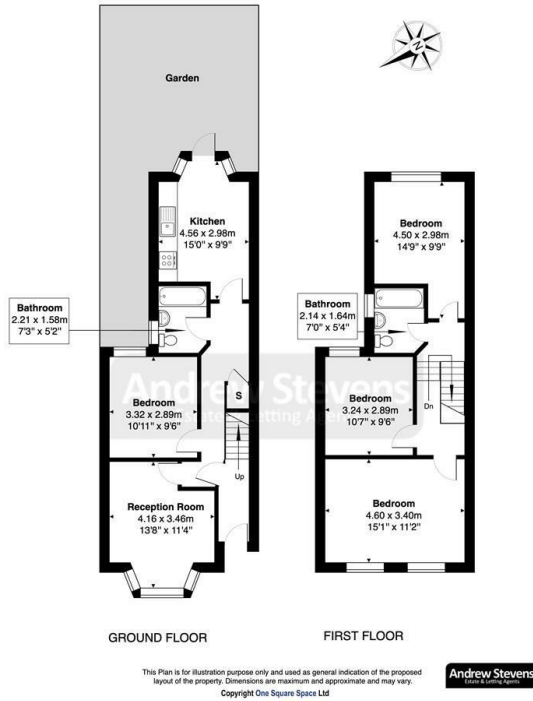

### Directions

### Viewings

Viewings by arrangement only. Call 020 8363 8888 to make an appointment.

### Council Tax Band

D

### EPC Rating:

D

