

FLETCHERS

ESTATE AGENTS



Larden Road, W3

£550,000

This well presented two-bedroom property benefits from period features such as a fire place and bay window. It also boasts a private entrance and direct access to a shared garden. Arranged across the ground floor the property has a light and spacious reception room due to the flats fantastic ceiling height. The apartment also has two bedrooms, a well appointed bathroom and an eat in kitchen which opens up onto the garden.

Larden Road is well located for the open spaces of Wendell Park and local amenities of Askew Road, also with both Acton and Chiswick High Road within easy reach. There are good transport links close by at Turnham Green and Stamford Brook tube stations, with Acton Central overground also a short walk away.

• Beautifully Presented • Period Features • High Ceilings • Shared Garden • Private Entrance • Share of Freehold •

FLETCHERS

ESTATE AGENTS

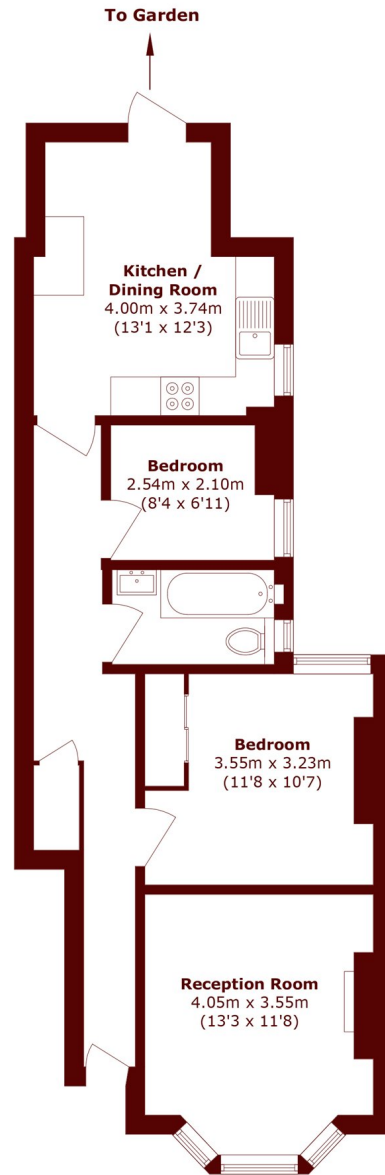

Total area (approx.): 62.3 sq. m (670.5 sq. ft)

Fletchers Brook Green Sales
144 Shepherds Bush Road, Hammersmith, London, W6 7PB
020 7603 1415
brookgreensales@fletcherstates.com

Energy Rating: . We aim to make our particulars both accurate and reliable. However they are not guaranteed; nor do they form part of an offer or contract. If you require clarification on any points then please contact us, especially if you're traveling some distance to view. Please note that appliances and heating systems have not been tested and therefore no warranties can be given as to their good working order.