



## Borland Road, TW11

### £625,000

This three double bedroom home is located in central Teddington and close proximity for outstanding school catchment. The property offers potential for renovation and is available with no onward chain.

Borland Road is located off St Marks Road, 0.1 miles from the local shops on Kingston Road and conveniently located for both Kingston and Teddington Town Centres.

### Features

- Three Bedrooms
- No Onward Chain
- Unallocated Parking
- Central Location
- Excellent School Catchment
- South West Facing Garden

# Borland Road, Teddington, TW11

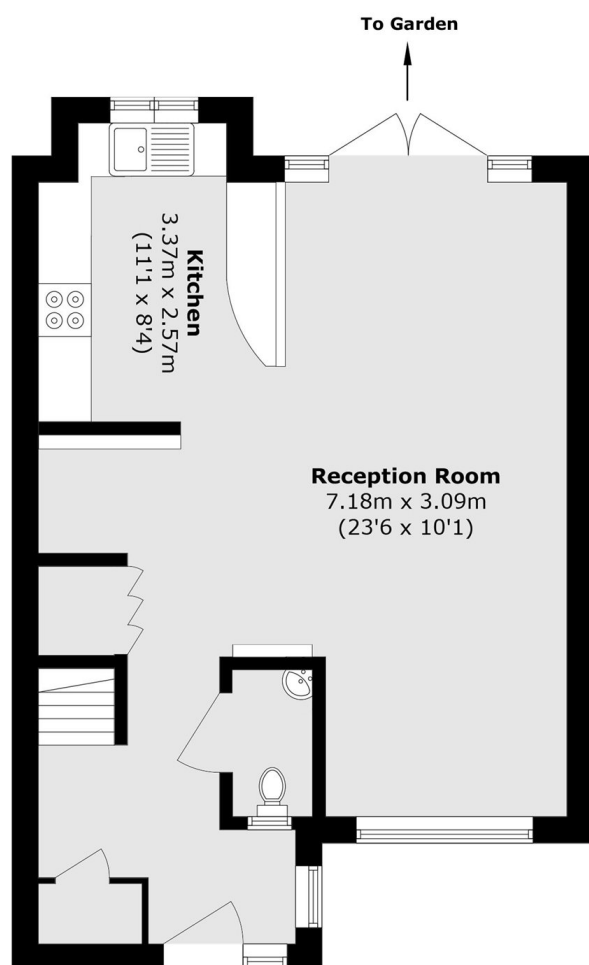

**Ground Floor**

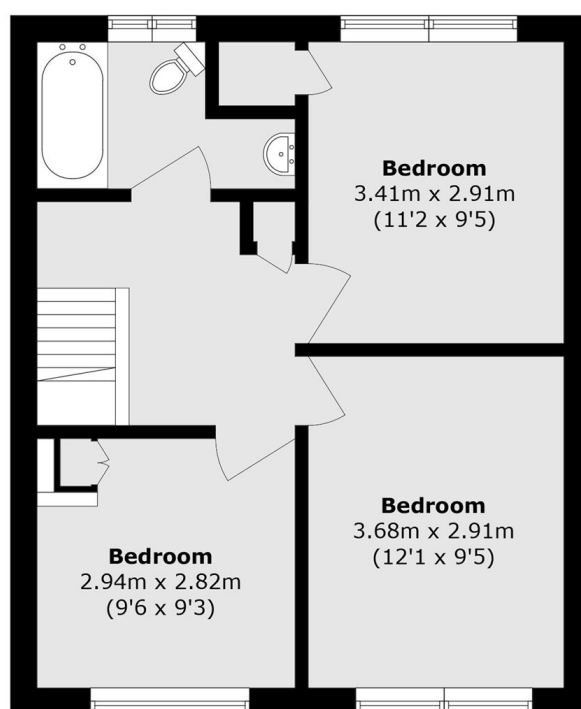

**First Floor**

Total area (approx.): 91.9 sq. m (989.2 sq. ft)