

# An impressive Grade I listed ground floor flat

Royal Crescent, Bath, Somerset, BA1 2LT

 1  1  1

Guide £2,500 p/m, plus fees may apply



# An impressive Grade I listed ground floor flat

Royal Crescent, Bath, Somerset, BA1 2LT

 1  1  1

Guide £2,500 p/m, plus fees may apply



# An impressive Grade I listed ground floor flat

Royal Crescent, Bath, Somerset, BA1 2LT



Guide £2,500 p/m, plus fees may apply



## About this property

A exceptional ground floor apartment on the historic Royal Crescent, one of Bath's most prestigious addresses.

The flat is entered from the grand common parts of the building, which are meticulously maintained and beautifully presented.

The entrance hall of the flat leads through to the stunning drawing room, with tall ceiling, feature fireplace and tall sash windows looking out over the Royal Crescent and Victoria Park.

Leading off the hallway there is also a practical kitchen with integrated appliances as well as a bathroom, which serves the bedrooms as well as being easy to access for guests.

The impressive bedroom is situated at the rear of the property overlooking Marlborough Buildings. Another dramatic room with its original ceiling height intact, a trio of tall sash windows and fitted wardrobes. Above the bedroom and leading off the hallway is the mezzanine study/snug.

Overall the apartment is ideal for those wanting a full or part-time home in one of Bath's most prestigious and desirable residential locations.



# An impressive Grade I listed ground floor flat

Royal Crescent, Bath, Somerset, BA1 2LT



Guide £2,500 p/m, plus fees may apply



## Plans

Approx. gross internal floor area  
1,232 sq ft

Approximate Floor Area = 114.5 sq m / 1232 sq ft (Excluding Void)

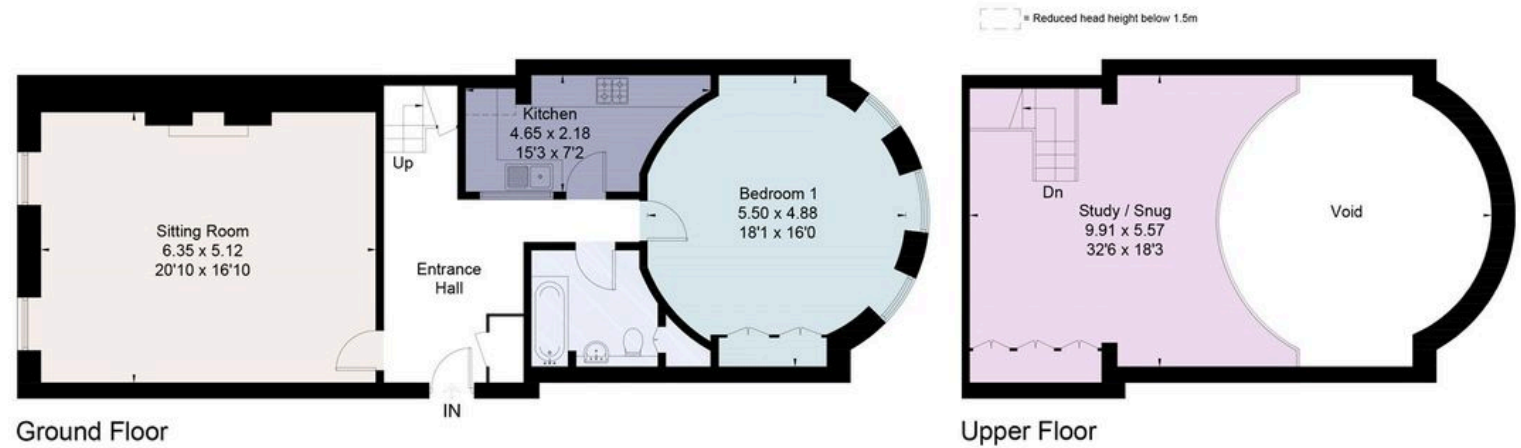

This floor plan has been drawn in accordance with RICS Property Measurement 2nd edition.  
All measurements, including the floor area, are approximate and for illustrative purposes only. @fourwalls-group.com #74677

# An impressive Grade I listed ground floor flat

Royal Crescent, Bath, Somerset, BA1 2LT



Guide £2,500 p/m, plus fees may apply



## Key Information

### Local Authority

Bath and North East Somerset

### Council Tax

Band = F

### Furnishing

Part Furnished

### Available From

Now

### Additional Payments

Deposit: £2,884.62 ( 5 weeks )

Holding Deposit: £576.92 ( 1 week )

Rent must be paid monthly in advance

### Services & Additional Information

Mains gas, electricity, water and drainage.

### EPC

EPC Rating = C

PROPERTY

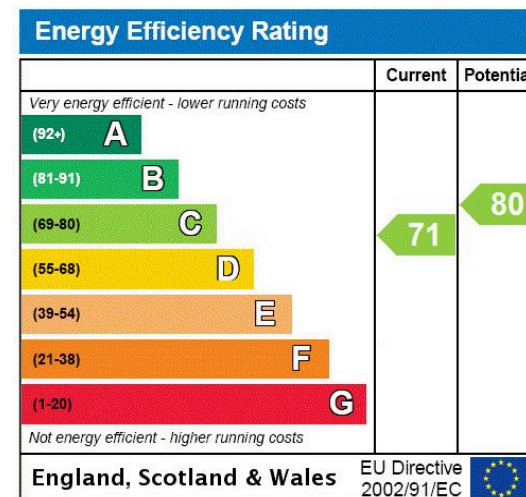

# An impressive Grade I listed ground floor flat

Royal Crescent, Bath, Somerset, BA1 2LT



Guide £2,500 p/m, plus fees may apply



## Enquire



**Louise Nicholson**  
Cotswold Lettings  
+44 (0)1285 627 561  
louise.nicholson@savills.com

## More Information



[View on website](#)



[View Digital Brochure](#)



[Property Search](#)

### Viewing strictly by appointment

Published: January 2025  
Property Ref: SGL240092



Important Notice: Savills, their clients and any joint agents give notice that: 1. They are not authorised to make or give any representations or warranties in relation to the property either here or elsewhere, either on their own behalf or on behalf of their client or otherwise. They assume no responsibility for any statement that may be made in these particulars. These particulars do not form part of any offer or contract and must not be relied upon as statements or representations of fact. 2. Any areas, measurements or distances are approximate. The text, images and plans are for guidance only and are not necessarily comprehensive. It should not be assumed that the property has all necessary planning, building regulation or other consents and Savills have not tested any services, equipment or facilities. Prospective tenants must satisfy themselves by inspection or otherwise. Please note that the local area may be affected by aircraft noise, you should make your own enquiries regarding any noise within the area before you make any offer.

\*There are different rules and fees for different tenancy types. For details of our fees and charges please go to [Savills.co.uk/tenant-fees](https://www.savills.co.uk/tenant-fees). For more detailed information read our applicant guide at [savills.co.uk/applicant-guide](https://www.savills.co.uk/applicant-guide).