



Winter Close, Yarm, TS15 9TY

£390,000

Nestled in the heart of the prestigious village of Yarm, this extraordinary four bedroom extended detached home is one of the finest properties to grace the local market in recent memory. Styled to a standard that simply has to be seen to be appreciated, this is a home that will captivate and delight from the moment you step through the door.

The ground floor is spectacular, a breathtaking open plan living space flows into a jaw-dropping bespoke kitchen with steel blue-grey gloss units, quartz worktops and a magnificent island, complemented by a beautifully styled dining room, stunning conservatory and perfectly appointed downstairs WC.

Four generous bedrooms await upstairs, including a sumptuous principal suite with an extraordinary ensuite featuring a freestanding roll-top bath, alongside a magnificent family bathroom with freestanding clawfoot bath set against a dramatic natural slate feature wall.

Outside, the rear garden is an outdoor paradise, a fully landscaped haven with a bespoke oak-framed gazebo, pristine artificial lawn, hot tub and multiple entertaining areas surrounded by beautiful planting.

Moments from Yarm's renowned high street, outstanding schools and excellent transport links, this is an absolute masterpiece. Early viewing is essential.

Hallway 5'2" x 8'4" (1.59 x 2.55)



From the moment you step through the front door, it is abundantly clear that this is a home that has been styled and presented with exceptional care, thought and attention to detail. The entrance hallway immediately sets the tone, a beautifully curated space that combines contemporary design with warmth and personality in a way that will stop every viewer in their tracks.

Engineered wood flooring runs underfoot, complemented by crisp white painted walls with elegant panelling detail and white painted staircase risers. A stunning stair runner in grey herringbone with bold black border trim draws the eye towards the first floor, creating a dramatic and stylish statement that is simply breath-taking.

A sleek black patterned radiator cover, a rustic oak console table, large circular black-framed mirror and carefully chosen accessories complete what is an effortlessly stylish and welcoming entrance, the kind of hallway you would find gracing the pages of an interior design magazine.

Living Area 12'7" x 17'8" (3.86 x 5.40)



Quite simply one of the most impressive living spaces you will find in a home of this type, a stunning, light-filled open plan room of truly exceptional proportions that flows seamlessly through to the kitchen beyond, creating a connected and social living environment that is perfect for modern family life and entertaining on any scale.

The continuation of the engineered wood flooring from the hallway runs the full length of the room, drawing the eye through the space and creating a wonderful sense of continuity and flow. Crisp white walls and elegant coving to the ceiling are bathed in an extraordinary play of light from the stunning statement chandelier above.

The undisputed focal point of the room is the beautifully appointed fireplace, a cast iron log burning stove set beneath a characterful chunky rustic oak beam mantle, with a generous log store alongside, creating a wonderfully cosy and inviting atmosphere that makes this room a joy to spend time in throughout every season.

The open sight line through to the kitchen dining area beyond gives a real sense of just how generous and versatile this quite extraordinary living space truly is.

Kitchen 25'0" x 11'5" (7.64 x 3.50)



Words simply do not do justice to this quite extraordinary kitchen and open plan living space, a room that has been designed, extended and finished to a standard that would rival any luxury interior design project and will leave every single viewer completely speechless.

The kitchen itself is a masterpiece of contemporary design, fitted with an extensive range of high-gloss handleless units in a sophisticated steel blue-grey finish to both wall and base level, complemented by stunning white quartz worktops with subtle sparkle running throughout. A bold and beautiful Moroccan-inspired patterned tile splashback provides a stunning focal point above the integrated induction hob, whilst LED under-cabinet lighting and LED plinth lighting beneath the units create a warm and luxurious ambiance at any time of day or night. Integrated appliances include a double oven, induction hob and integrated dishwasher, all finished to the highest specification.

The centrepiece of the entire ground floor is the magnificent kitchen island, a generously proportioned statement piece finished in the same steel blue-grey gloss with white quartz worktop, illuminated by a trio of stunning glass pendant lights above and LED plinth lighting beneath. With bar stool seating alongside, it serves equally as a social hub, breakfast bar and additional preparation space, the absolute heart of this remarkable home.

The engineered wood flooring flows seamlessly from the hallway and living room throughout the entire space, unifying what is an extraordinarily generous and versatile ground floor that must be experienced in person to be truly appreciated. The view from the kitchen back through the open archway into the living room, with its log burner, chandelier and shuttered windows beyond, is one of the most impressive interior vistas you will encounter in any home at any price point.

Dining Room 13'5" x 7'9" (4.09 x 2.38)



A quite magnificent and individually styled dining room that showcases the interior design talent that runs through every corner of this exceptional home. This is a room that has been curated with real thought, passion and an enviable eye for detail, and the result is simply breathtaking.

The lower half of the walls are finished in a sophisticated sage green painted panelling, a design choice that is both timeless and utterly on trend, whilst the upper walls and ceiling are finished in crisp white with elegant coving, creating a beautifully balanced and considered colour palette. Engineered wood flooring continues throughout, adding warmth and continuity to the space.

This is a dining room that will inspire dinner parties, family gatherings and a genuine love of entertaining, a room that perfectly encapsulates the warmth and character of this truly special home.

Conservatory 16'1" x 12'9" (4.91 x 3.91)



This is quite simply one of the most spectacular conservatories you will ever encounter, a truly extraordinary space that transcends the traditional notion of a conservatory entirely and instead delivers a room of genuine grandeur, beauty and year-round liveability that will leave every viewer completely lost for words.

A vast, curved wrap-around structure with uPVC glazing on all aspects, flooding the room with an abundance of natural light and delivering an immersive panoramic connection to the beautiful garden beyond. The curved walls and dramatically vaulted ceiling soar overhead, creating a sense of space and volume that is simply unlike anything you will have experienced before.

Easily accommodating multiple full-size sofas alongside a television and media unit, this is a room that works equally beautifully as a second living room, a sun room, a playroom or an entertainment space, versatile, spectacular and utterly unforgettable. The continuation of engineered wood flooring throughout ties this incredible room seamlessly to the rest of the ground floor and with the homes second log burner and fully insulated roof, makes this a cosy space to relax.

French doors open directly onto the garden, completing a ground floor living experience that is truly second to none.

WC 6'4" x 6'1" (1.94 x 1.86)



A beautifully appointed and immaculately styled downstairs WC that perfectly reflects the exceptional standard of presentation that runs throughout this entire home. Even the smallest room has been given the full interior design treatment, and the result is quite simply delightful.

Matching the dining room perfectly, the lower half of the walls are finished in the same elegant sage green painted panelling with crisp white above, creating a wonderfully cohesive and considered feel. Gorgeous Moroccan-inspired patterned floor tiles in monochrome add a bold and beautiful finishing touch underfoot, tying in effortlessly with the kitchen splashback tiles elsewhere in the home and demonstrating a level of interior design continuity that is truly impressive.

Fitted with a white close-coupled WC with a striking dark wood seat, a pedestal wash hand basin with a sleek matt black mixer tap.

Bedroom 1 (Front) 13'0" x 13'0" (3.98 x 3.97)



A truly sumptuous and generously proportioned principal bedroom that continues the exceptional standard of interior design and presentation found throughout this remarkable home. Decorated in a calming and sophisticated palette of warm grey and white, with beautiful painted wall panelling as a headboard backdrop, a detail that is both elegant and deeply considered, this is a bedroom that immediately evokes a sense of peace, luxury and restful calm.

Deep pile fitted grey carpet underfoot adds to the feeling of indulgence, and the room is flooded with natural light through a large rear-facing window that frames a beautiful leafy outlook.

The room comfortably accommodates a king-size bed with ample space remaining for a full range of freestanding furniture. A door leads to a stunning en-suite bathroom of generous proportions.

This is a principal bedroom that would grace any luxury hotel, a deeply personal, beautifully finished and wonderfully restful space that perfectly crowns this quite exceptional Yarm home.

Ensuite 8'2" x 5'4" (2.51 x 1.65)

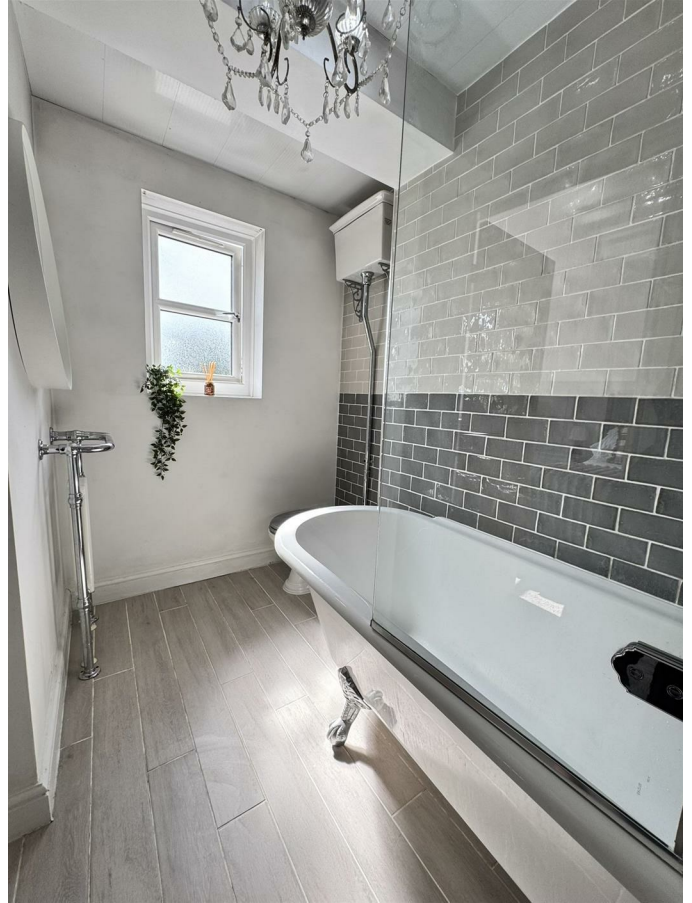

An utterly exquisite and lavishly appointed ensuite bathroom that brings a genuine sense of spa-like luxury to the principal bedroom suite, a space that is as beautiful as it is indulgent, and one that will leave every viewer completely enchanted.

The centrepiece and crowning glory of this remarkable room is the magnificent freestanding roll-top bath with elegant chrome claw feet and a traditional chrome floor-mounted thermostatic bath filler, a classic and timeless piece that immediately sets the tone for a bathroom of exceptional quality and character. With stunning dual-tone metro brick tiles in light grey and dark charcoal running from floor to ceiling in a boldly contrasting scheme that is simultaneously contemporary and timeless.

Light wood-effect porcelain floor tiles run throughout, adding warmth and a clean, hotel-like finish underfoot, whilst a frosted window floods the space with soft natural light. A chrome ladder radiator and a traditional wall-mounted WC with high-level cistern add further period charm and character.

An ensuite bathroom of quite extraordinary beauty that will be treasured every single day.

Bedroom 2 (Front) 7'9" x 16'9" (2.38 x 5.11)



A beautifully presented and generously proportioned second double bedroom that continues the exceptional standard of styling and attention to detail that defines every room in this outstanding home. Warm cream carpet runs underfoot, creating a soft and inviting feel throughout, whilst crisp white walls with elegant painted wall panelling behind the bed head provide a refined and sophisticated backdrop that perfectly frames the space.

The room is flooded with natural light through a good-sized front-facing window.

Comfortably accommodating a double bed with ample room remaining for a full range of furniture, this is a versatile and beautifully styled second bedroom that will appeal to a wide range of buyers.

Bedroom 3 (Rear) 16'0" x 8'9" (4.88 x 2.67)



A superb and impressively proportioned third double bedroom, styled in a cool, contemporary monochrome scheme that feels sophisticated, masculine and effortlessly on trend. Deep pile grey fitted carpet runs underfoot, crisp white walls are decorated with a carefully curated gallery wall of framed prints, and two stunning

large Edison filament globe pendant lights in an industrial style cast a warm, golden glow throughout.

The room comfortably accommodates a double bed with ample space remaining on all sides, and benefits from a good-sized window allowing generous natural light throughout.

A third bedroom of quite exceptional quality that again demonstrates the extraordinary level of care and investment that has gone into every single room of this outstanding home.

Bedroom 4 (Rear) 8'0" x 11'10" (2.45 x 3.61)



A wonderfully versatile fourth bedroom, currently utilised as a stylish home office and snug, a combination that perfectly reflects the flexible and modern lifestyle this exceptional home accommodates so effortlessly. Neutrally decorated throughout in warm white and soft grey tones with plush fitted carpet underfoot, the room is bright, comfortable and impeccably presented in keeping with the rest of the property.

A good-sized window to the rear aspect frames a lovely outlook over the cherry blossom tree beyond, flooding the room with natural light and providing a wonderfully uplifting view.

Currently housing a comfortable two-seater sofa, a dedicated desk workspace set neatly into the recess and a wall-mounted black framed window mirror, the room demonstrates beautifully how this fourth bedroom can serve multiple purposes simultaneously. Whether used as a fourth bedroom, home office, hobby room, nursery or dressing room, this is a genuinely useful and flexible space that adds real and tangible value to an already extraordinary home.

Bathroom 8'10" x 6'10" (2.70 x 2.09)



Prepare to be completely stunned, because this quite extraordinary family bathroom is one of the most breathtaking rooms in an already exceptional home, and a space that will genuinely stop every single viewer in their tracks.

The crowning glory of this magnificent room is the magnificent freestanding double-ended roll-top bath with ornate silver claw feet, set against a dramatic full-height natural slate stacked stone feature wall in deep charcoal, a combination so visually striking and luxurious that it would not look out of place in a five-star boutique hotel. A spectacular crystal chandelier hangs directly above, casting a cascading, jewel-like sparkle across the entire room and elevating the bathing experience to something truly magical and indulgent.

The remainder of the room is finished in large format warm grey ceramic tiles throughout, to both walls and floor, creating a clean, cohesive and spa-like finish. A traditional white pedestal wash hand basin with cross-head chrome taps and a traditional high-level cistern WC with chrome fittings and a beautifully styled chrome column heated towel rail with white radiator complete the period-inspired scheme.

This is not just a bathroom. This is a sanctuary. A room that will make buyers fall in love with this home on the spot and simply refuse to leave.

Garden/Outdoor Seating Area



If the interior of this exceptional home has taken your breath away, then the rear garden will leave you completely and utterly speechless, a quite

magnificent, fully landscaped and meticulously designed outdoor space that is as beautiful, considered and luxurious as every room within the home itself.

The garden is generously proportioned, enclosed by elegant contemporary slatted timber fencing to all boundaries providing complete privacy and a wonderfully sophisticated backdrop throughout. A lush, immaculate artificial lawn runs across the majority of the space, vibrant green, perfectly manicured and entirely maintenance free, bordered by beautifully designed raised planting beds housing clipped topiary balls, ornamental grasses, flowering plants and seasonal colour that together create a garden of genuine horticultural beauty.

The absolute showpiece of this outstanding outdoor space is the magnificent bespoke gazebo, a substantial, architect-quality structure with a steeply pitched natural timber roof, exposed vaulted ceiling beams, horizontal slatted timber privacy walls, creating a fully sheltered outdoor living and entertaining space of breathtaking quality.

Beyond the gazebo, a generous dark slate flagstone paved patio area provides further outdoor entertaining space.

This is a garden that has been designed, invested in and loved, a truly extraordinary outdoor space that perfectly and completely finishes what is without question one of the most exceptional homes to come to the market in Yarm in recently.

Floor Plan

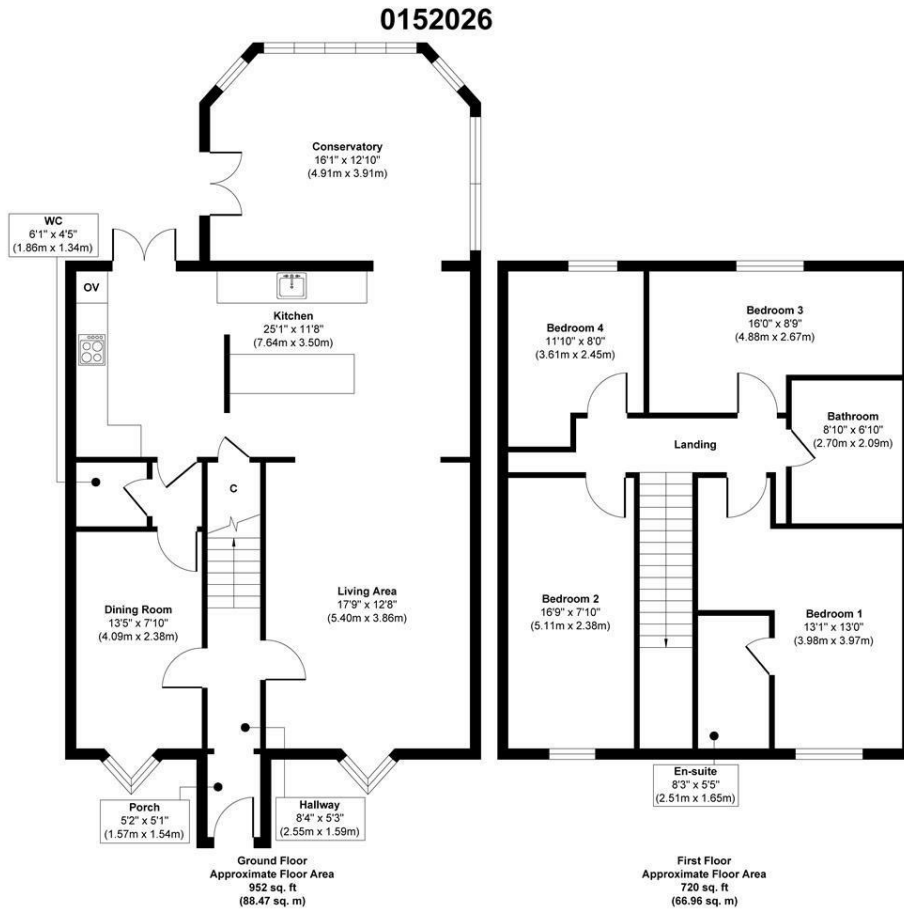

Approx. Gross Internal Floor Area 1672 sq. ft / 155.43 sq. m
 Illustration for identification purposes only, measurements are approximate, not to scale.
 Produced by Elements Property

Area Map

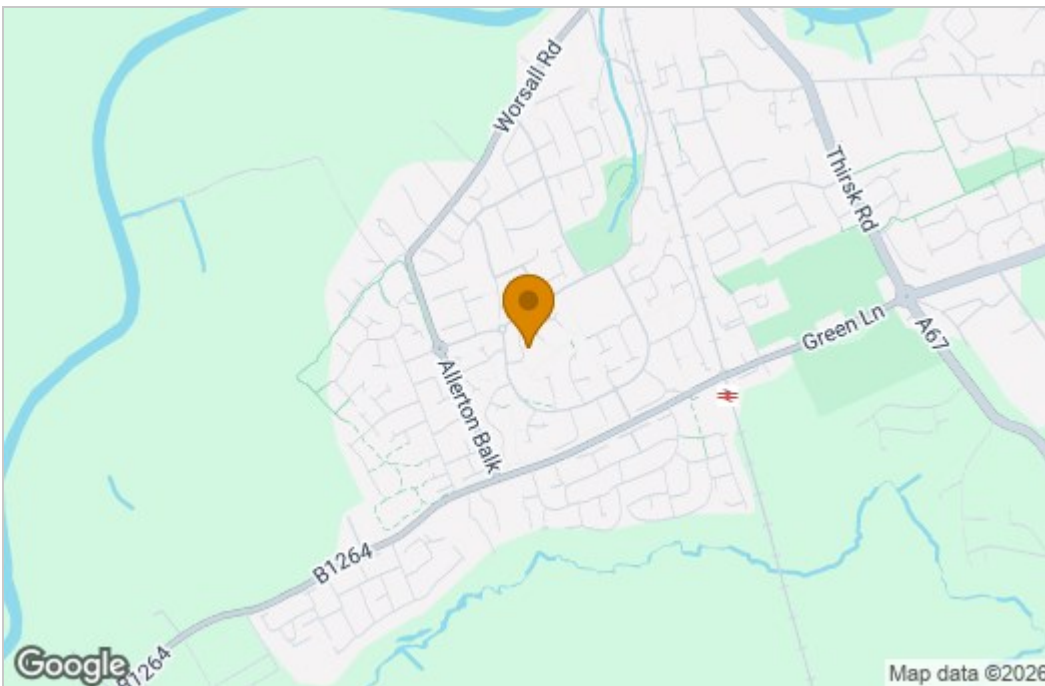

Energy Efficiency Graph

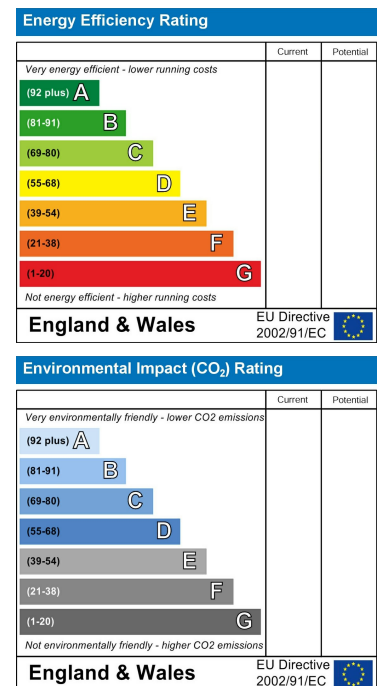

These particulars, whilst believed to be accurate are set out as a general outline only for guidance and do not constitute any part of an offer or contract. Intending purchasers should not rely on them as statements of representation of fact, but must satisfy themselves by inspection or otherwise as to their accuracy. No person in this firm's employment has the authority to make or give any representation or warranty in respect of the property.