

Butler's

thoughtful estate agency



North Street
Carshalton, SM5 2HG
Guide price £480,000



North Street

Carshalton, SM5 2HG

GUIDE PRICE £480,000 - £500,000

Nestled within an immensely convenient & coveted location, North Street will tick all of your boxes. Location wise, it couldn't get any better. Close to outstanding local schooling and transport links, you'll have the luxury of a quick school run, whilst getting into work on time. Great amenities are also close at hand such as a local M&S & Sainsbury's, so picking up that pint of milk and loaf of bread when you run low won't be too much of a chore.

So with the location ticking all your boxes, how does the rest of the house stack up? Well, the property is in in the sort of condition you can just move in and start to enjoy immediately, with neutral tones throughout and a modern kitchen & bathroom, yet still having the potential to make your own mark.

On the ground floor, the aforementioned kitchen is an impressive size and a real family hub, giving you the ability to not just cook, but also dine, with an adjacent reception, which could be an additional area for entertaining, work or even as another bedroom if you so wish.

Upstairs, being a townhouse, there is a spacious lounge and no less than 3 great-sized bedrooms split over 2 floors, which are wonderful places for you and the kids to catch up on a great night's sleep, with you even having the opportunity to use one for a dedicated home office, which is fast becoming a necessity! A real bonus is a cloakroom on the ground floor alongside the family bathroom on the 3rd serving the rooms, meaning no trips upstairs if you have guests over.

Outside, this handsome house has a driveway to the front and a garden to the rear, grabbing that evening sun for those get-togethers with friends. Come check out this fabulous house - or you may live to regret it, especially as there is no onward chain!

GROUND FLOOR

Porch





Hallway

Kitchen/Dining Room
14'4 x 14'3 maximum (4.37m x 4.34m maximum)

Reception/Study
15'1 x 7'1 (4.60m x 2.16m)

Conservatory
7'8 x 6'2 (2.34m x 1.88m)

Cloakroom

FIRST FLOOR

Landing

Living Room
17'3 x 14'4 (5.26m x 4.37m)

Bedroom
14'4 x 10'2 (4.37m x 3.10m)

SECOND FLOOR

Landing

Bedroom
13'9 x 12'3 maximum (4.19m x 3.73m maximum)

Bedroom
14'8 x 8'11 (4.47m x 2.72m)

Bathroom
8'10 x 4'11 (2.69m x 1.50m)

OUTSIDE

Driveway

Rear Garden

Floor Plan

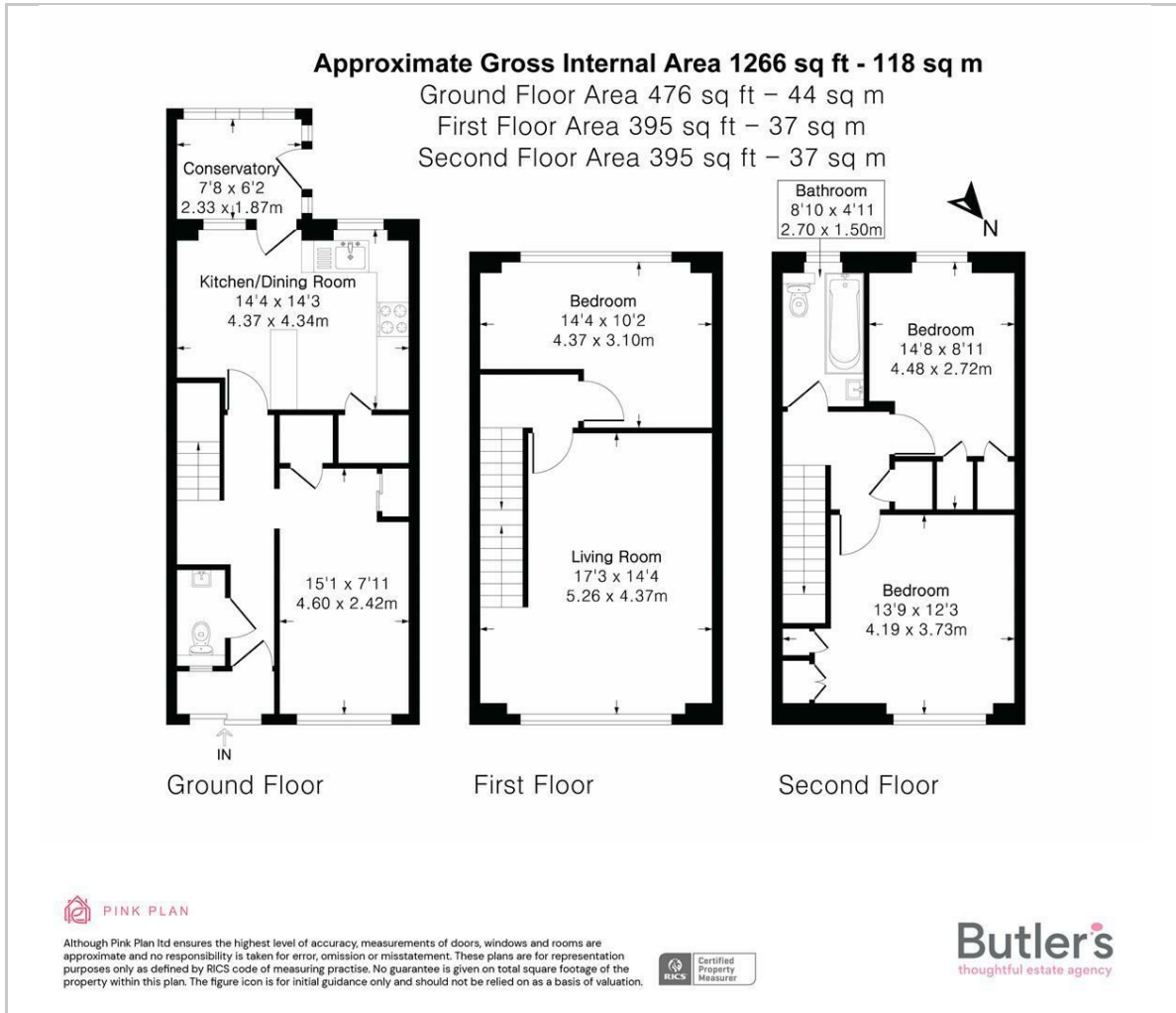

Viewing

Please contact our Butler's Sutton Office on 020 39 170 160 if you wish to arrange a viewing appointment for this property or require further information.

18 Sutton Plaza, Sutton, Surrey, SM1 4FS
 Tel: 020 39 170 160 Email: sutton@butlershomes.co.uk butlershomes.co.uk

Area Map

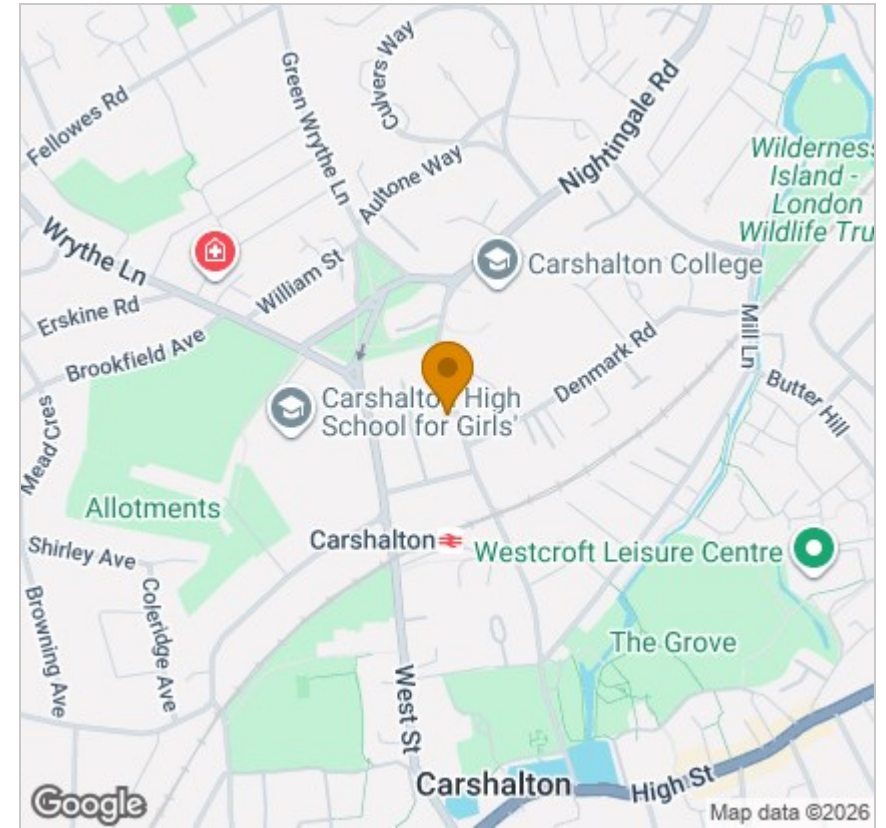

Energy Efficiency Graph

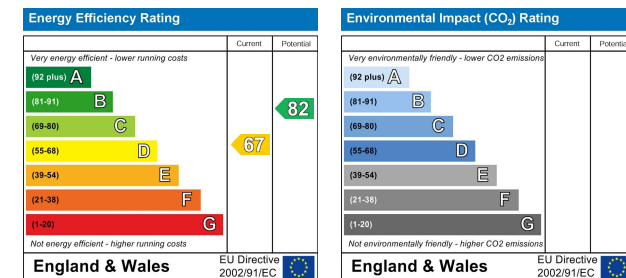

These particulars, whilst believed to be accurate are set out as a general outline only for guidance and do not constitute any part of an offer or contract. Intending purchasers should not rely on them as statements of representation of fact, but must satisfy themselves by inspection or otherwise as to their accuracy. No person in this firm's employment has the authority to make or give any representation or warranty in respect of the property.