



## FINBOROUGH ROAD, SW10

£850,000

Large garden  
Two double bedrooms  
Two bathrooms  
Separate kitchen  
Private entrance  
850+ sq ft

@marshandparsons  
marshandparsons.co.uk

MARSH &  
PARSONS



# ABOUT THE PROPERTY

This recently refurbished property has been finished to a good standard and offers generous living space as well as a great location just off the Fulham Road. The property comprises two good sized double bedrooms with built-in storage, a large living area, separate modern kitchen and two modern bathrooms as well as its own 35ft garden.

Finborough Road is located just off the Fulham Road and is close to all the bars, restaurants, shops and amenities of the Fulham Road. Further benefits include great bus links from the Fulham Road and short walk to either Earls Court or Fulham Broadway for access to the District, Circle or Piccadilly Lines.



# STEP INSIDE FINBOROUGH ROAD

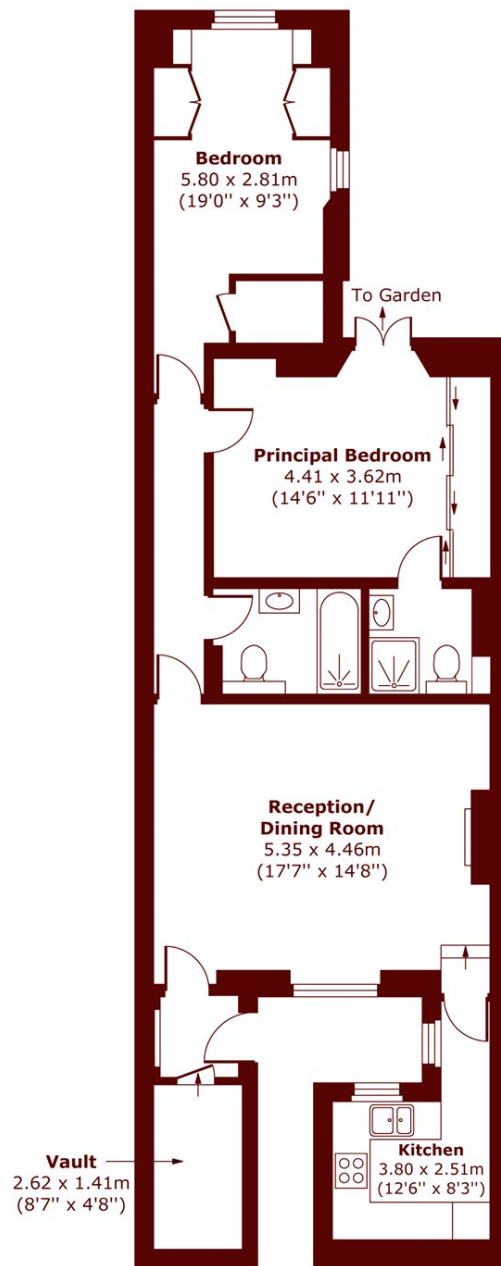

## LOWER GROUND FLOOR

APPROX. GROSS INTERNAL FLOOR AREA  
861 SQFT / 79.99 SQM

**Earls Court**  
020 7244 2210

Energy Rating: C We aim to make our particulars both accurate and reliable. However, they are not guaranteed; nor do they form part of an offer or contract. If you require clarification on any points then please contact us, especially if you're traveling some distance to view. Please note that appliances and heating systems have not been tested and therefore no warranties can be given as to their good working order

**MARSH &  
PARSONS**