



# Messina Avenue

West Hampstead, NW6

£1,500 per month  
(£346.15 per week)

\*VIDEO TOUR AVAILABLE\*. A double bedroom studio apartment with wood floors and communal roof terrace on the top floor of this terraced Victorian house in West Hampstead.

CHESTERTONS



# Messina Avenue

## West Hampstead, NW6

- A Double Bedroom Studio Apartment
- 0 Bedroom, 1 Bathroom, Reception, Fully Fitted Kitchen
- Communal Roof Terrace, Wood Floors
- Situated in West Hampstead, Within Walking Distance West Hampstead (Jubilee Line), Thameslink and Silverlink Stations





\*VIDEO TOUR AVAILABLE\*. A double bedroom studio apartment on the top floor of this terraced Victorian house with wood floors and communal roof terrace. The property is situated in West Hampstead, within walking distance West Hampstead (Jubilee Line), Thameslink and Silverlink Stations. Accommodation comprises bright and spacious reception, open plan fully fitted kitchen, ultra modern bathroom.

**Minimum Term:** 12 months  
**Deposit Required:** £1,730.77  
**Local Authority:** London Borough Of Camden  
**Council Tax Band:** C  
**EPC Rating:** D  
**Part Furnished, Unfurnished**

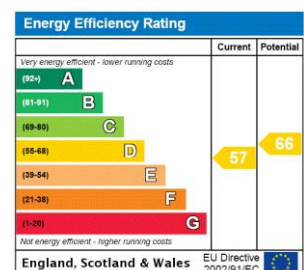

### *Chestertons Hampstead Lettings*

55-56 Hampstead High Street  
 Hampstead  
 London  
 NW3 1QH  
[hampsteadlettingsusers@chestertons.co.uk](mailto:hampsteadlettingsusers@chestertons.co.uk)  
 02077941125  
[chestertons.co.uk](http://chestertons.co.uk)

Additional tenant charges apply (fees apply to non-AST tenancies only)  
 Tenancy Agreement Fee: £300  
 References per Tenant/Guarantor: £60  
 Inventory check (approx. £100 – £250 inc. VAT)  
[chestertons.co.uk/property-to-rent/applicable-fees](http://chestertons.co.uk/property-to-rent/applicable-fees)

# Messina Avenue, West Hampstead, NW6

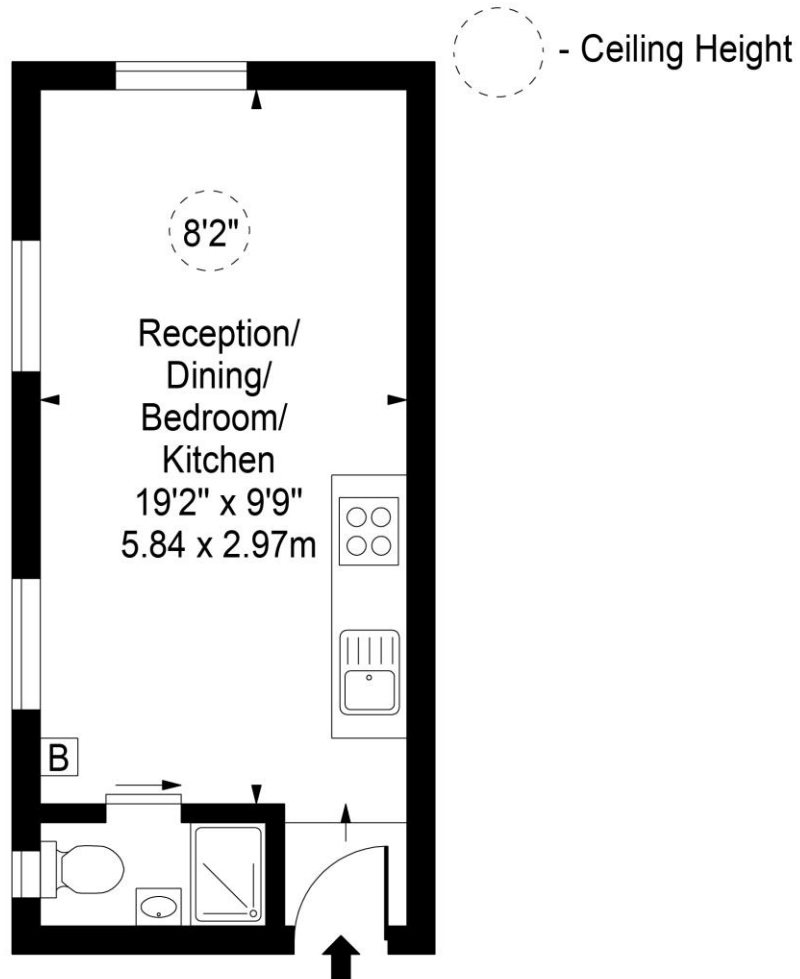
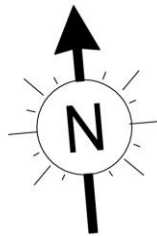

Half Landing  
Between  
Ground & First Floor

**Approx Gross Internal Area      216 Sq Ft - 20.06 Sq M**

For Illustration Purposes Only - Not To Scale

[www.goldlens.co.uk](http://www.goldlens.co.uk)

Prepared for Chestertons

Ref. No. 011690M

