



Gippingstone Road, Bramford, Ipswich, IP8 4DR

welcome to

Gippingstone Road, Bramford, Ipswich

This well-presented, detached bungalow is situated in a quiet Close and benefits from two bedrooms, an open plan lounge/diner, a conservatory, a garage and off street parking.

Entrance Hall

Carpet flooring, one radiator, a fitted mat, loft hatch and an airing cupboard housing the boiler.

Lounge/Diner

Open plan room with carpet flooring, double glazed bay window to the front with fitted blinds, an electric fire, two radiators, TV point and double glazed sliding doors to the conservatory, with fitted shutters.

Kitchen

Wood effect flooring, eye and base level units in cream with wood effect worktop surfaces, a stainless steel one and a half bowl sink plus drainer and chrome mixer tap, an integrated fridge/freezer, dishwasher, microwave and oven with induction hob and extractor hood, space for a washing machine, one radiator, double glazed window to the rear with fitted blinds and a door to the garden.

Conservatory

Tiled effect flooring, double glazed windows to the side and rear, French doors to the garden and double glazed sliding doors to the lounge, with fitted shutters.

Bathroom

Marble tiled effect flooring, partially tiled walls, chrome heated towel rail, double glazed window to the front, a corner shower with glass enclosure, low level WC, extractor fan and a vanity sink with chrome waterfall mixer tap.

Master Bedroom

Carpet flooring, double glazed window to the rear with fitted blind, a fitted wardrobe, one radiator and TV point.

Bedroom Two

Carpet flooring, double glazed window to the front with fitted blind, a built in wardrobe and one radiator.

Outside: Front Garden

A pathway to the front door, a driveway and a garage.

Rear Garden

A patio seating area, a grassed area, flower beds, a decking area, fully enclosed border, a side access and a shed.

Garage

An up and over door, power and a door to the garden.

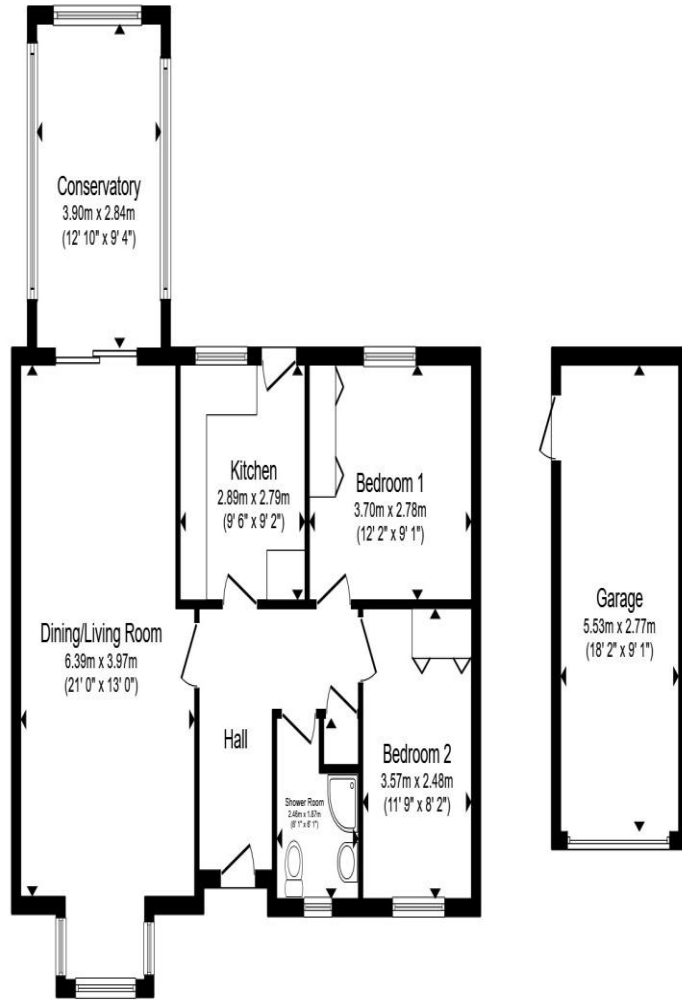

Floor Plan

Garage

Total floor area 93.8 m² (1,010 sq.ft.) approx

This floor plan is for illustrative purposes only. It is not drawn to scale. Any measurements, floor areas (including any total floor area), openings and orientation are approximate. No details are guaranteed, they cannot be relied upon for any purpose and they do not form part of any agreement. No liability is taken for any error, omission or misstatement. A party must rely upon its own inspection(s). Powered by www.propertybox.io



welcome to
Gippingstone Road,
Bramford, Ipswich

- Two bedrooms
- Open plan lounge/diner
- Conservatory
- Garage & off street parking
- Great access to A12/A14

Tenure: Freehold EPC Rating: C
Council Tax Band: D

£350,000



view this property online williamhbrown.co.uk/Property/IPS121398



Property Ref:
IPS121398 - 0002

1. MONEY LAUNDERING REGULATIONS Intending purchasers will be asked to produce identification documentation at a later stage and we would ask for your co-operation in order that there is no delay in agreeing the sale. 2. These particulars do not constitute part or all of an offer or contract. 3. The measurements indicated are supplied for guidance only and as such must be considered incorrect. Potential buyers are advised to recheck measurements before committing to any expense. 4. We have not tested any apparatus, equipment, fixtures or services and it is in the buyers interest to check the working condition of any appliances. 5. Where an EPC, or a Home Report (Scotland only) is held for this property, it is available for inspection at the branch by appointment. If you require a printed version of a Home Report, you will need to pay a reasonable production charge reflecting printing and other costs. 6. We are not able to offer an opinion either written or verbal on the content of these reports and this must be obtained from your legal representative. 7. Whilst we take care in preparing these reports, a buyer should ensure that his/her legal representative confirms as soon as possible all matters relating to title including the extent and boundaries of the property and other important matters before exchange of contracts.

William H Brown is a trading name of Sequence (UK) Limited which is registered in England and Wales under company number 4268443, Registered Office is Cumbria House, 16-20 Hockliffe Street, Leighton Buzzard, Bedfordshire, LU7 1GN. VAT Registration Number is 500 2481 05.



william h brown



01473 226101



ipswich@williamhbrown.co.uk



16-18 Wolsey House, Princes Street, IPSWICH,
Suffolk, IP1 1QT



williamhbrown.co.uk