





Chase Bank Court, London, N14

Addison Townsend are delighted to offer for sale this two bedroom ground maisonette. The property offers two double bedrooms, spacious living room, fitted kitchen/diner and shower room with separate W.C. Externally the property benefits from a detached garage accessed via its own driveway and private front and rear gardens. Located in this convenient location within 0.5 miles of Oakwood Underground Station, close to local parks and bus routes and within excellent school catchments. Chain free.

- Ground Floor Maisonette
- Two Bedrooms
- Private Front and Rear Garden
- Spacious Living Room
- Detached Garage Accessed via Own Driveway
- Chain Free



1 2 1

Tenure : Leasehold

Sq.Ft : 818



Approximate Gross Internal Area 818 sq ft - 76 sq m

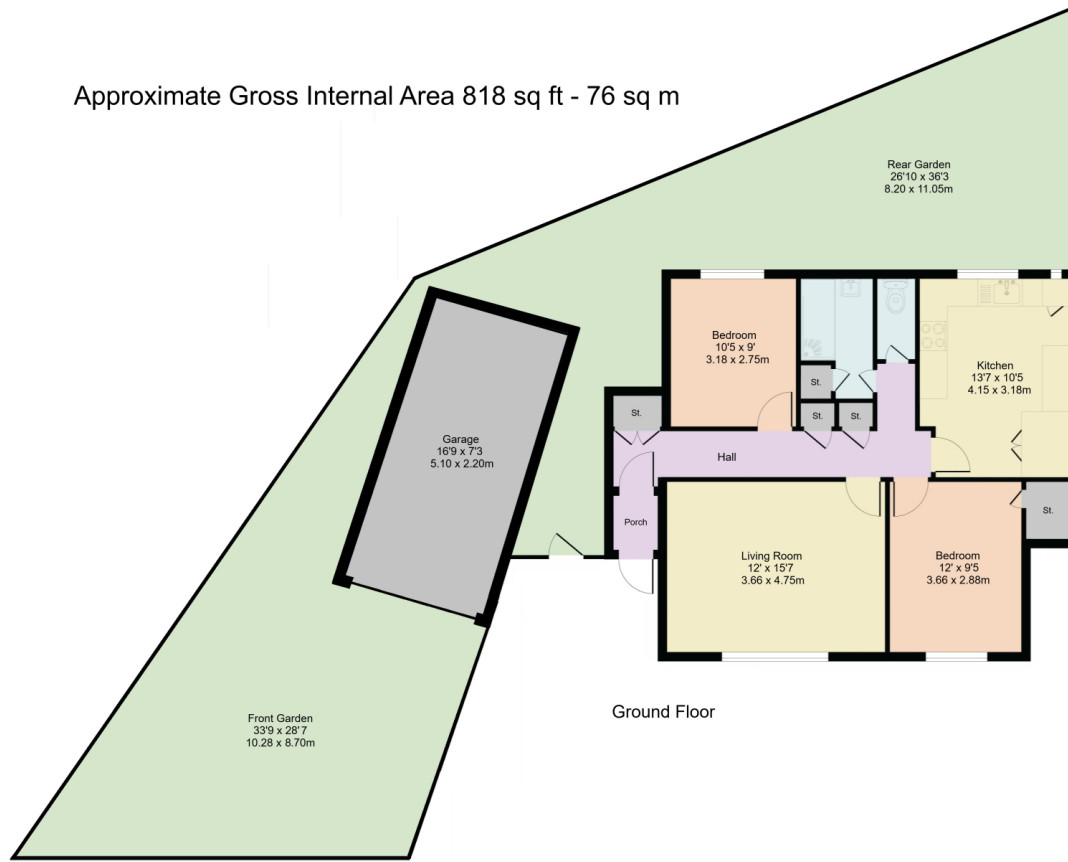

PINK PLAN
 Although Pink Plan Ltd ensures the highest level of accuracy, measurements of doors, windows and rooms are approximate and no responsibility is taken for error, omission or misstatement. These plans are for representation purposes only as defined by RICS code of measuring practice. No guarantee is given on total square footings of the property within this plan. The figure icon is for initial guidance only and should not be relied on as a basis of valuation.



Whilst every care has been taken to prepare these particulars, they are for guidance purposes only. All measurements are approximate and for general guidance purposes only. Whilst every care has been taken to ensure their accuracy, they should not be relied upon and potential buyers/ternants are advised to recheck the measurements



02088826828

www.addisontownsend.co.uk

info@addisontownsend.co.uk



ADDISON TOWNSEND
 PROPERTY PROFESSIONALS

