

GROUND FLOOR
450 sq.ft. (41.8 sq.m.) approx.

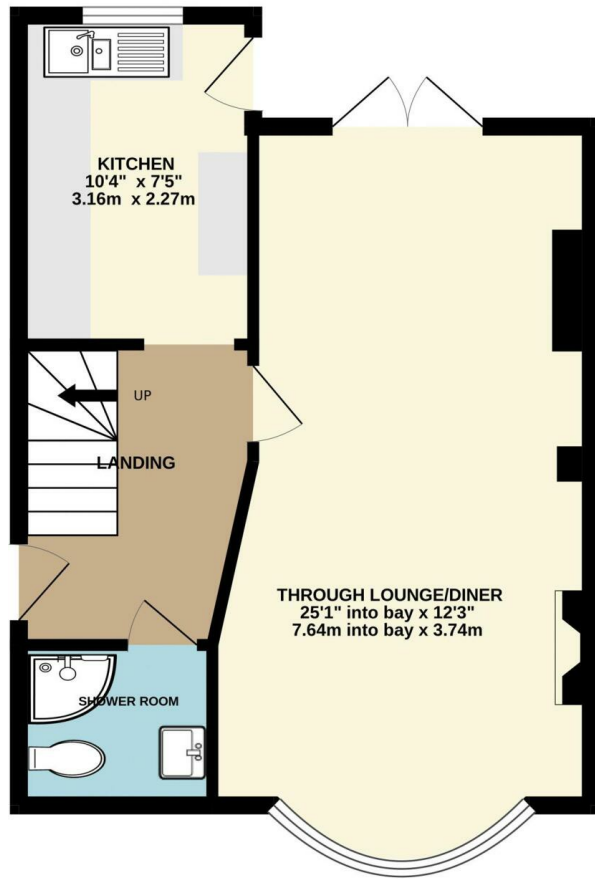

1ST FLOOR
426 sq.ft. (39.6 sq.m.) approx.

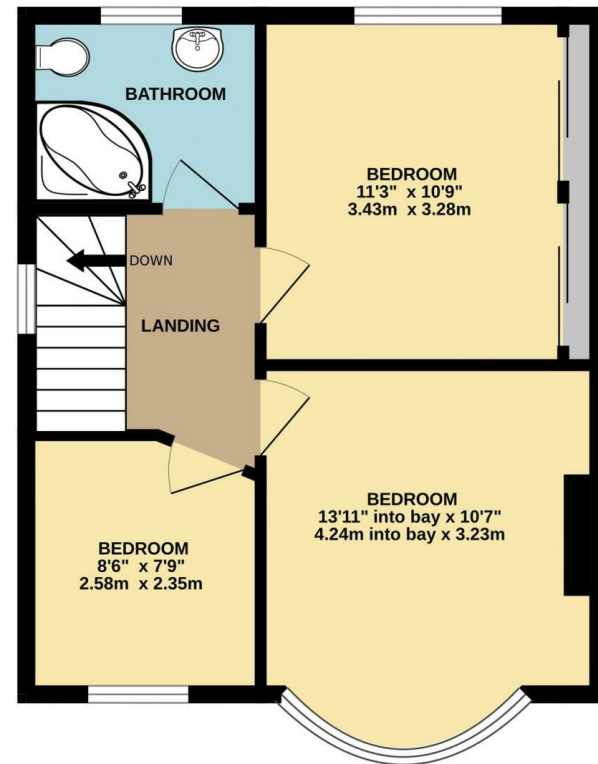

TOTAL FLOOR AREA : 877 sq.ft. (81.5 sq.m.) approx.

Whilst every attempt has been made to ensure the accuracy of the floorplan contained here, measurements of doors, windows, rooms and any other items are approximate and no responsibility is taken for any error, omission or mis-statement. This plan is for illustrative purposes only and should be used as such by any prospective purchaser. The services, systems and appliances shown have not been tested and no guarantee as to their operability or efficiency can be given.
Made with Metropix ©2025

[See how to improve this property's energy efficiency.](#)

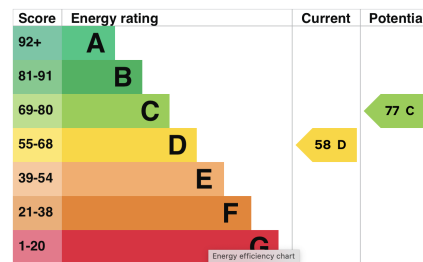

The graph shows this property's current and potential energy rating.

Properties get a rating from A (best) to G (worst) and a score. The better the rating and score, the lower your energy bills are likely to be.

For properties in England and Wales:



Beechcroft Avenue, Barnehurst, DA7 6QR

PRICE GUIDIE 500,000 TO 525,000 **Beechcroft Avenue, Barnehurst - Spacious Three-Bedroom Semi-Detached Home**
Nestled in the sought-after Beechcroft Avenue, Barnehurst, this larger-than-average three-bedroom semi-detached home is a true gem, impeccably presented throughout. Orig...

Guide price £475,000



AJR Property
2 Bellegrave Road, Welling DA16 3PR
T: +442083040666 | E: hello@ajrproperty.com
<http://www.ajrproperty.com/>

AJR Property
2 Bellegrave Road, Welling DA16 3PR
T: +442083040666 E: hello@ajrproperty.com
<http://www.ajrproperty.com/>



Features

- 3 Bedroom 2 Bath Semi
- Fantastic Garden with fruit trees
- Great Location
- Drive for multiple cars
- Larger than normal
- Freehold