

Plumbers Row, E1

£1,995 Per calendar month

A spacious one bedroom apartment set within a private development. The well presented property has a large and bright reception, modern kitchen and double bedroom.

Albany Court is located just a short distance from Spitalfields Market & Liverpool Street Station where there are endless choices of local shops, restaurants and bars.

Features

- One Double Bedroom
- Lift access
- Wood Flooring
- Bright & Spacious
- Video Entry System
- Aldgate

Plumbers Row, London, E1

Third Floor

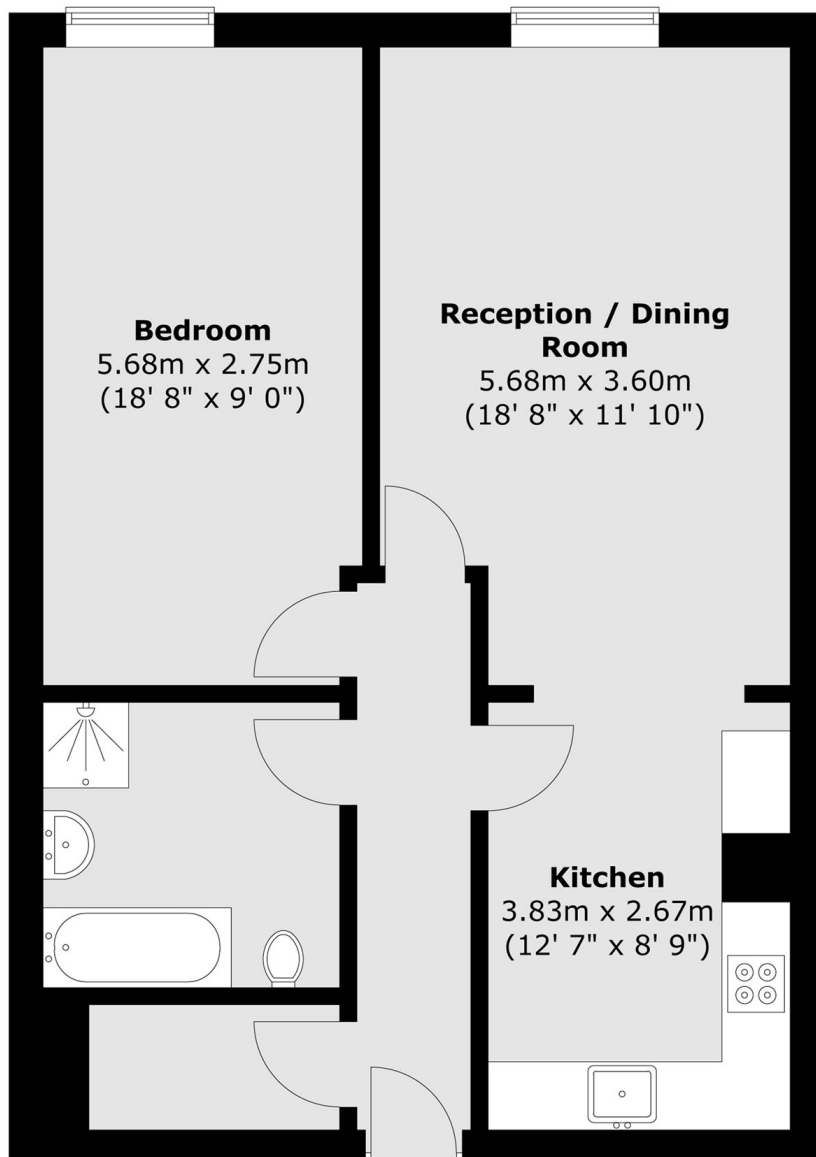

Total area (approx.) : 62.4 sq. m (672 sq. ft)