



BLACKHEATH ROAD, SE10

£300,000

Top floor conversion flat
Two double bedrooms
Open plan
Modern bathroom
Close to Greenwich stations
Energy rating: d



ABOUT THE PROPERTY

A top floor conversion flat featuring two double bedrooms, a modern bathroom suite with shower over bath, a spacious reception room and an open plan kitchen. Benefiting from wood flooring in the communal areas, double glazed windows and gas central heating.

Greenwich mainline and DLR stations, are just a short walking distance away, as well the royal park and town centre. The immediate area offers a wide range of shopping facilities, such as supermarkets and eateries.



STEP INSIDE BLACKHEATH ROAD

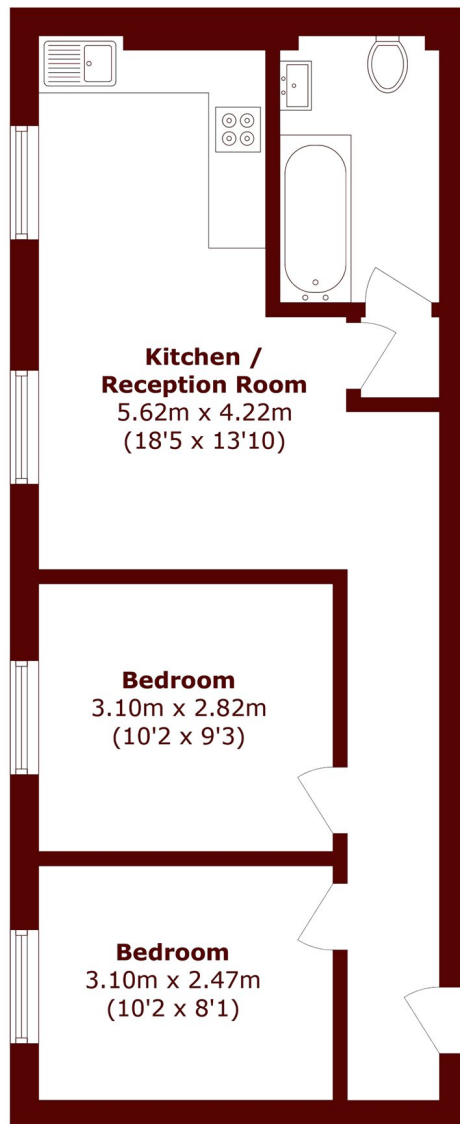

Total area (approx.): 47.3 sq. m (509.1 sq. ft)

Greenwich
020 8378 5450

Energy Rating: D We aim to make our particulars both accurate and reliable. However, they are not guaranteed; nor do they form part of an offer or contract. If you require clarification on any points then please contact us, especially if you're traveling some distance to view. Please note that appliances and heating systems have not been tested and therefore no warranties can be given as to their good working order

MARSH &
PARSONS